



2025

UX 300h

OWNER'S MANUAL QUICK GUIDE

Contents

The Quick Guide is not intended as a substitute for your *OWNER'S MANUAL*. We strongly encourage you to review the *OWNER'S MANUAL* and supplementary manuals so you will have a better understanding of your vehicle's capabilities and limitations.

Pictorial Index	3
Hybrid System	
Hybrid System.....	11
For safe use	
Floor Mat Installation.....	15
Entering and Exiting	
Keys.....	16
Smart Access System with Push-button Start.....	18
When Driving	
Front Seats.....	19
Power (Ignition) Switch.....	20
EV Drive Mode.....	23
Hybrid Transmission.....	24
Turn Signal Lever.....	29
Parking Brake.....	30
Brake Hold.....	32
Multi-information Display (with 7-inch Display).....	33
Multi-information Display (with 12.3-inch Display).....	34
Head-up Display.....	35
Displayed Content.....	38
Headlight Switch.....	42
AHB (Automatic High Beam).....	43
Fog Light Switch.....	45
Windshield Wipers and Washer.....	46
Rear Window Wiper and Washer.....	48

Driving Comfort

Basic Operation of Multimedia System	49
Navigation *	50
Connecting a Smartphone or Communication Device *	54
Basic Operation of Audio System *	59
Lexus Climate Concierge.....	64
Automatic Air Conditioning System *	65

Interior features

Starting Voice Control *	67
Connecting to the USB Port.....	71
Garage Door Opener.....	72

Safety Connect

Safety Connect	77
Remote Connect.....	79
Service Connect.....	80

Opening and Closing

Door Locks	81
Back Door.....	82
Fuel Tank Cap	85

What to do if...

List of Warning/Indicator Lights.....	87
If the electronic key does not operate properly.....	91
If the hybrid system will not start	93

*: These features may be operated by Starting Voice Control (See P.67)

Depending on specifications, the vehicle shown in the illustration may differ from your vehicle in terms of equipment.

Pictorial Index

Instrument panel

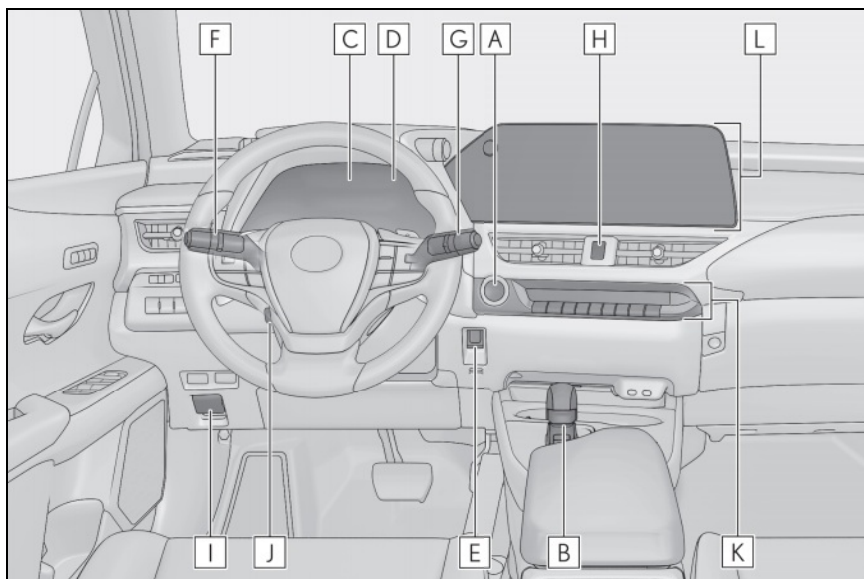

- A Power switch**..... P.20
 - Starting the hybrid system/changing the modeP.20, 21
 - Emergency stop of the hybrid systemP.22
 - When the hybrid system will not start.....P.92
 - Warning messages*¹
- B Shift lever** P.24
 - Changing the shift position.....P.24
 - Precautions against towing*¹
- C Meters***¹
 - Reading the meters/adjusting the instrument panel lights*¹
 - Warning lights/indicator lights.....P.87
 - When the warning lights come on*¹
- D Multi-information display** P.33, 34
 - Display..... P.33, 34
 - Energy monitor..... P.39
 - When the warning messages are displayed*¹

E	Parking brake switch	P.30
	Applying/releasing.....	P.30
	Precautions against winter season ^{*1}	
	Warning buzzer/message ^{*1}	
F	Turn signal lever	P.29
	Headlight switch	P.42
	Headlights/parking lights/tail lights/license plate lights/ daytime running lights.....	P.42
	AHB (Automatic High Beam).....	P.43
	Fog lights ^{*2}	P.45
G	Windshield wiper and washer switch	P.46
	Rear window wiper and washer switch	P.48
	Usage.....	P.46, 48
	Adding washer fluid ^{*1}	
	Headlight cleaners ^{*2}	P.46
	Warning messages ^{*1}	
H	Emergency flasher switch ^{*1}	
I	Hood lock release lever ^{*1}	
J	Tilt and telescopic steering control switch ^{*1,2/} tilt and telescopic steering lock release lever ^{*1,2}	
	Adjustment ^{*1}	
	Driving position memory ^{*1,2}	
K	Air conditioning system	P.65
	Usage.....	P.66
	Rear window defogger.....	P.65
L	Audio system	P.59

^{*1}: Refer to "OWNER'S MANUAL".

^{*2}: If equipped

■ Switches

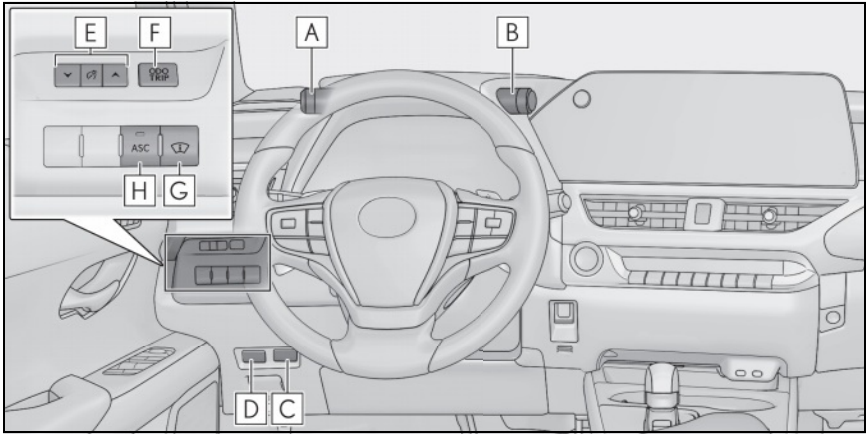

- A** VSC off switch *1
- B** Driving mode select switch *1
- C** Power back door switch *2 P.82
- D** Fuel filler door opener switch P.85
- E** Instrument panel light control switches *1
- F** “ODO TRIP” switch *1
- G** Head-up display switch *2 P.35
- H** ASC switch *1,2

*1: Refer to “OWNER’S MANUAL”.

*2: If equipped

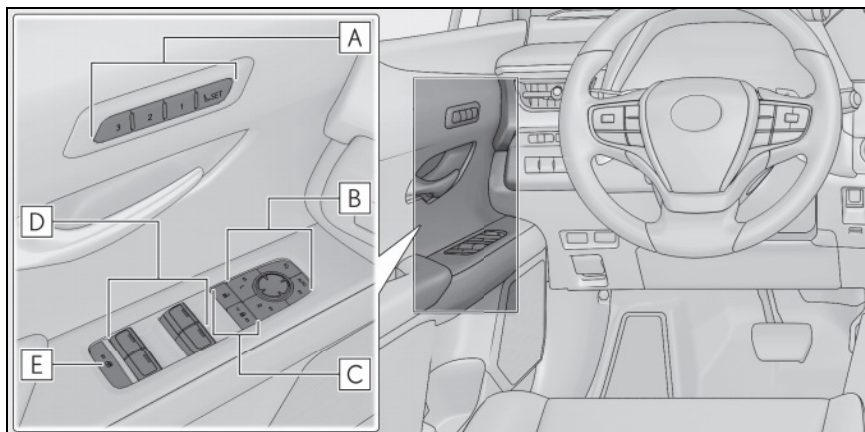

- A** Driving position memory switches *1,2
- B** Outside rear view mirror switches *2
- C** Door lock switches.....P.81
- D** Power window switches *2
- E** Window lock switch *2

*1: If equipped

*2: Refer to "OWNER'S MANUAL".

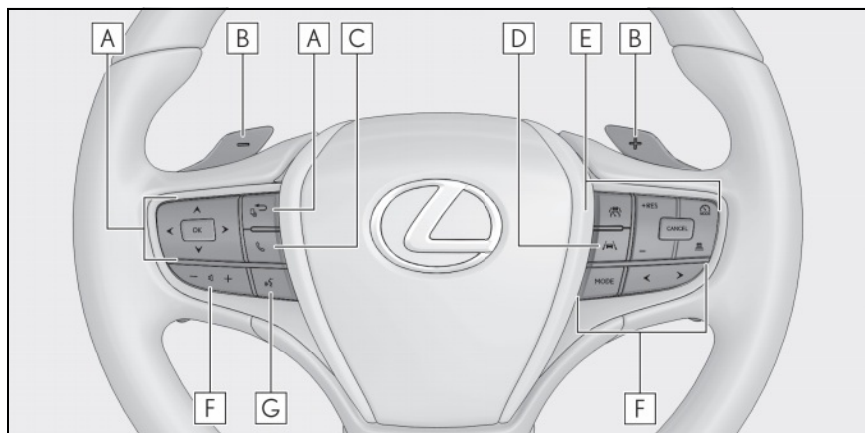

A	Meter control switches	P.38
B	Paddle shift switches *1	P.27, 28
C	TEL switch.....	P.56
D	LTA (Lane Tracing Assist) switch *2	
E	Cruise control switches *2	
	Dynamic radar cruise control with full-speed range *2	
F	Audio remote control switches.....	P.59
G	Talk switch	P.56

*1: If equipped

*2: Refer to "OWNER'S MANUAL".

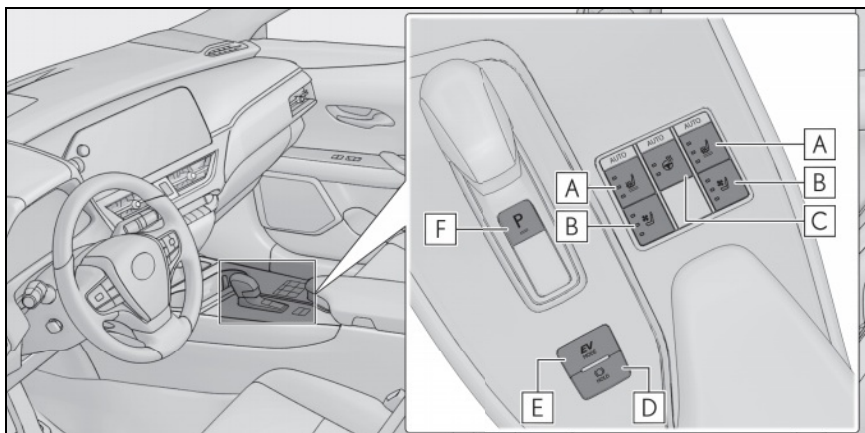

A Seat heater switches *1,2

B Seat ventilator switches *1,2

C Heated steering wheel switch *1,2

D Brake hold switch P.32

E EV drive mode switch..... P.23

F P position switch..... P.24

*1: If equipped

*2: Refer to “OWNER’S MANUAL”.

■ Interior

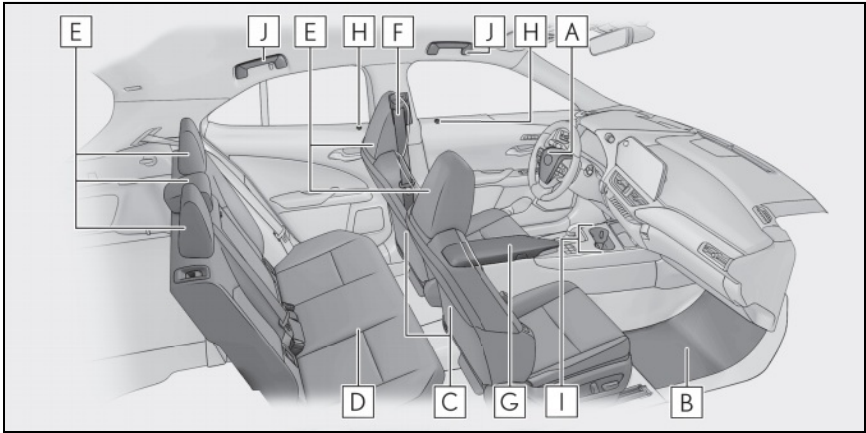

- A** SRS airbags*
- B** Floor mats P.15
- C** Front seats P.19
- D** Rear seats*
- E** Head restraints*
- F** Seat belts*
- G** Console box*
- H** Inside lock buttons P.81
- I** Cup holder*
- J** Assist grips*

*: Refer to "OWNER'S MANUAL".

■ Ceiling

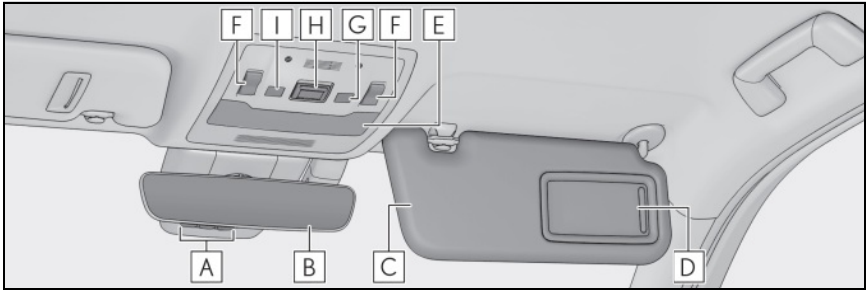

- A** Garage door opener buttons ^{*1}P.72
- B** Inside rear view mirror ^{*2}
- C** Sun visors ^{*2}
- D** Vanity mirrors ^{*2}
- E** Interior light ^{*2,3}
Personal lights ^{*2}
- F** Moon roof switches ^{*1,2}
- G** Door-linked interior light switch ^{*2}
- H** "SOS" button ^{*1}P.77
- I** Intrusion sensor and tilt sensor cancel switch ^{*1,2}

^{*1}: If equipped

^{*2}: Refer to "OWNER'S MANUAL".

^{*3}: The illustration shows the front, but they are also equipped in the rear.

Hybrid System

Your vehicle is a Hybrid Electric Vehicle. It has characteristics different from conventional vehicles. Be sure you are closely familiar with the characteristics of your vehicle, and operate it with care.

The hybrid system combines the use of a gasoline engine and an electric motor (traction motor) according to driving conditions, improving fuel efficiency and reducing exhaust emissions.

For details, refer to the "OWNER'S MANUAL".

Hybrid System Indicator (with 7-inch display)

► Type 1

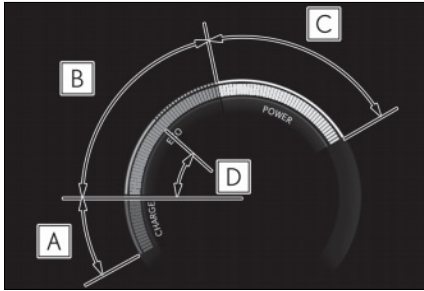

► Type 3

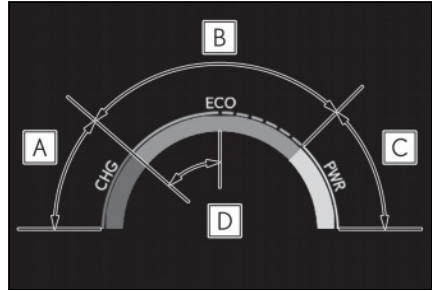

This illustration is for explanation only and may differ depending on the specifications of the vehicle.

- A** Charge area
Shows regeneration* status.
- B** Eco area
Shows that the vehicle is being driven in an Eco-friendly manner.
- C** Power area
Shows that an Eco-friendly driving range is being exceeded (during full power driving etc.)
- D** Hybrid Eco area
Shows that gasoline engine power is not being used very often.

The gasoline engine will automatically stop and restart under various conditions.

- By keeping the indicator needle within Eco area, more Eco-friendly driving can be achieved.
- Charge area indicates regeneration* status. Regenerated energy will be used to charge the hybrid battery (traction battery).

*: When used in this manual, regeneration refers to the conversion of energy created by the movement of the vehicle into electrical energy.

Hybrid System Indicator (with 12.3-inch display)

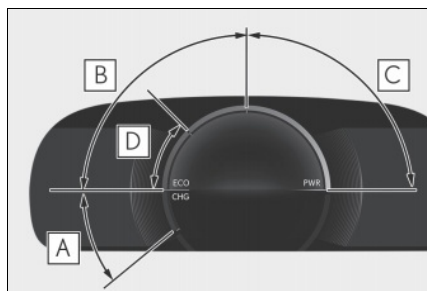

A Charge area

Shows regeneration* status.

Regenerated energy will be used to charge the hybrid battery (traction battery).

B Eco area

Shows that the vehicle is being driven in an Eco-friendly manner.

By keeping the bar display within Eco area, more Eco-friendly driving can be achieved.

C Power area

Shows that an Eco-friendly driving range is being exceeded (during full power driving etc.)

D Hybrid Eco area

Shows that gasoline engine power is not being used very often.

The gasoline engine will automatically stop and restart under various conditions.

*: When used in this manual, regeneration refers to the conversion of energy created by the movement of the vehicle into electrical energy.

Hybrid battery (traction battery) charge

If the shift position is in N, the hybrid battery (traction battery) will not be charged. To help prevent the battery from discharging, avoid leaving the N position selected for a certain amount of time.

Regenerative braking

In the following situations, kinetic energy is converted to electric energy and deceleration force can be obtained in conjunction with the recharging of the hybrid battery (traction battery).

- The accelerator pedal is released while driving with the shift position in D, B*¹ or S*².
- The brake pedal is depressed while driving with the shift position in D, B*¹ or S*².

*¹: Vehicles without paddle shift switches

*²: Vehicles with paddle shift switches

Sounds and vibrations specific to a Hybrid Electric Vehicle

Because there is no engine sound or vibration, it is easy to mistake the Hybrid Electric Vehicle for being off when it is actually still running, as indicated by the “READY” indicator being illuminated. For safety, make sure to always shift the shift position to P and apply the parking brake when parked.

The following sounds or vibrations may occur when the hybrid system is operating and are not a malfunction:

- Motor sounds may be heard from the engine compartment.
- Sounds may be heard from the hybrid battery (traction battery) under the rear seats when the hybrid system starts or stops.
- Relay operating sounds such as a snap or soft clank will be emitted from the hybrid battery (traction battery), under the rear seats, when the hybrid system is started or stopped.
- Sounds from the hybrid system may be heard when the back door is open.
- Sounds may be heard from the hybrid transmission when the gasoline engine starts or stops, when driving at low speeds, or during idling.
- Engine sounds may be heard when accelerating sharply.
- Sounds may be heard due to regenerative braking when the brake pedal is depressed or as the accelerator pedal is released.
- Vibration may be felt when the gasoline engine starts or stops.
- Cooling fan sounds may be heard from the air intake vent under the left side of the rear seat.

Running out of fuel

When the vehicle has run out of fuel and the hybrid system cannot be started, refuel the vehicle with at least enough gasoline to make the low fuel level warning light go off. If there is only a small amount of fuel, the hybrid system may not be able to start. (The standard amount of fuel is about 1.8 gal. [7.0 L, 1.5 Imp.gal.], when the vehicle is on a level surface. This value may vary when the vehicle is on a slope. Add extra fuel when the vehicle is inclined.)

Hybrid warning message

A message is automatically displayed when a malfunction occurs in the hybrid system or an improper operation is attempted.

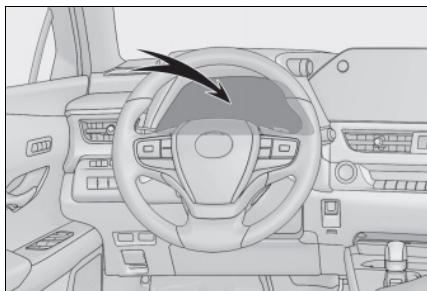

If a warning message is shown on the multi-information display, read the message and follow the instructions.

Floor Mat Installation

Use only floor mats designed specifically for vehicles of the same model and model year as your vehicle. Fix them securely in place onto the carpet.

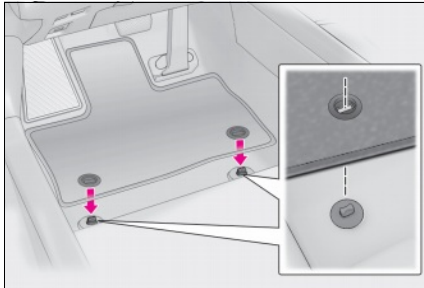

- 1 Insert the retaining hooks (clips) into the floor mat eyelets.

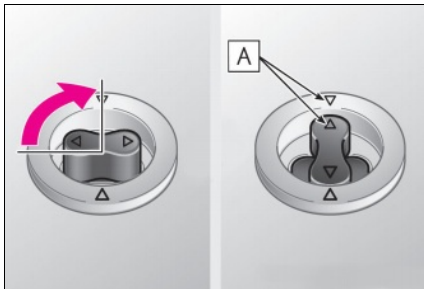

- 2 Turn the upper knob of each retaining hook (clip) to secure the floor mats in place.

Always align the \triangle marks **A**.

The shape of the retaining hooks (clips) may differ from that shown in the illustration.

Keys

Electronic key

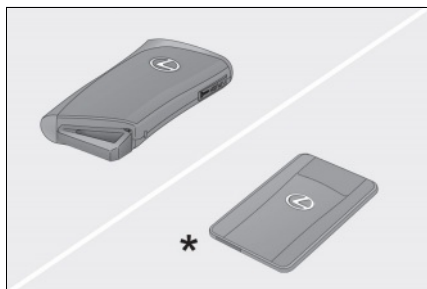

- Smart access system with push-button start (→P.18)
- Wireless remote control
- *: If equipped

Mechanical key

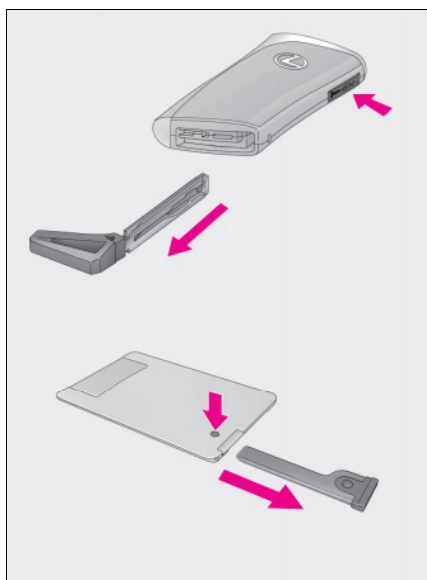

To take out the mechanical key, push the release button and take the key out.

The mechanical key can only be inserted in one direction, as the key only has grooves on one side. If the key cannot be inserted in a lock cylinder, turn it over and re-attempt to insert it.

After using the mechanical key, store it in the electronic key. Carry the mechanical key together with the electronic key. If the electronic key battery is depleted or the entry function does not operate properly, you will need the mechanical key.

Wireless remote control

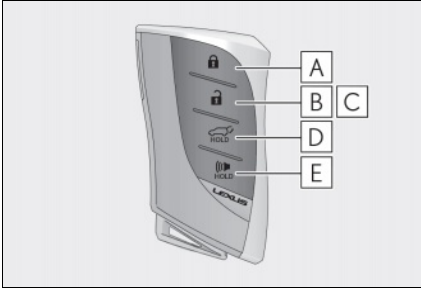

- A** Locks all the doors
- B** Unlocks all the doors
- C** Opens the windows and moon roof^{*1,2}
- D** Opens and closes the power back door^{*1}
- E** Sounds the alarm

^{*1}: If equipped

^{*2}: These settings must be customized at your Lexus dealer.

Smart Access System with Push-button Start

The following operations can be performed simply by carrying the electronic key (including the card key) on your person, for example in your pocket. The driver should always carry the electronic key.

For details on starting the hybrid system, see page 20.

Unlocking and locking the doors from the outside

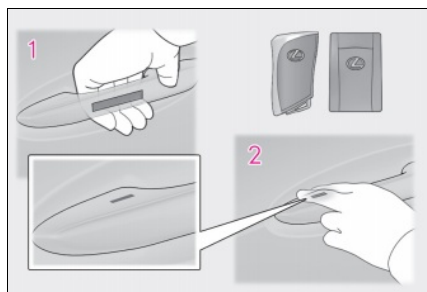

- 1** Grip the driver's door handle to unlock the door. Holding the driver's door handle for approximately 2 seconds unlocks all the doors. Grip the front passenger door handle to unlock all the doors.*

Make sure to touch the sensor on the back of the handle.

The doors cannot be unlocked for 3 seconds after the doors are locked.

*: The door unlock settings can be changed.

- 2** Touch the lock sensor (the indentation on the upper part of the front door handle) to lock all the doors.

Check that the door is securely locked.

Unlocking and locking the back door from the outside

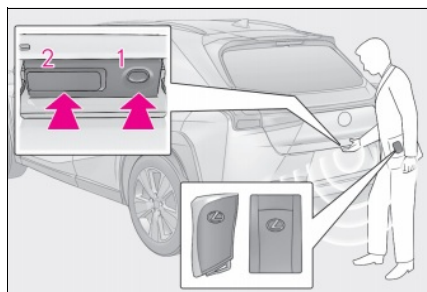

- 1** Locks all the doors
Check that the door is securely locked.
- 2** Unlocks all the doors
The doors cannot be unlocked for 3 seconds after the doors are locked.

For details on what to do when the electronic key does not operate properly, see page 91.

Front Seats

Adjustment procedure

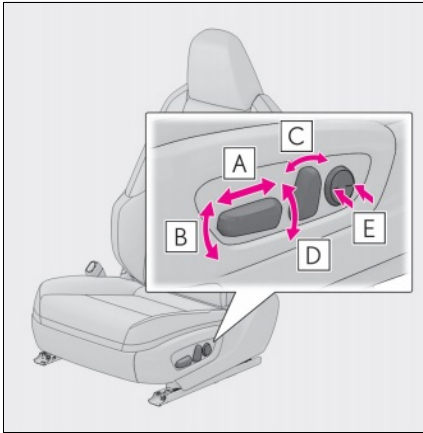

- A** Seat position adjustment switch
- B** Seat cushion (front) angle adjustment switch
- C** Seatback angle adjustment switch
- D** Vertical height adjustment switch
- E** Lumbar support adjustment switch (for driver's side)

Power (Ignition) Switch

Performing the following operations when carrying the electronic key on your person starts the hybrid system or changes power switch modes.

Starting the hybrid system

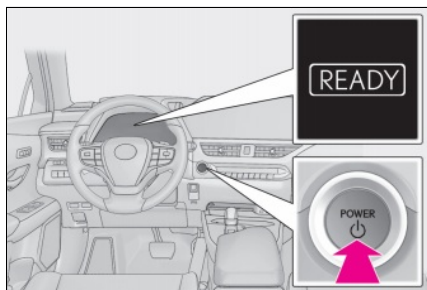

- 1 Press the parking brake switch to check that the parking brake is set. (→P.30)

Parking brake indicator will come on.

- 2 Firmly depress the brake pedal.



and a message will be displayed on the multi-information display. If it is not displayed, the hybrid system cannot be started.

When the shift position is N, the hybrid system cannot start. Shift the shift position to P when starting the hybrid system.

- 3 Press the power switch shortly and firmly.

When operating the power switch, one short, firm press is enough. It is not necessary to press and hold the switch.

If the "READY" indicator turns on, the hybrid system will operate normally.

Continue depressing the brake pedal until the "READY" indicator is illuminated.

The hybrid system can be started from any power switch mode.

- 4 Check that the "READY" indicator is illuminated.

The vehicle cannot be driven if the "READY" indicator is off.

Stopping the hybrid system

- 1 Stop the vehicle completely.
- 2 Set the parking brake (→P.30)
- 3 Press the P position switch. (→P.24)
- 4 Press the power switch.
- 5 Release the brake pedal and check that “ACCESSORY” or “POWER ON” is not shown on the meter.

Changing power switch modes

Modes can be changed by pressing the power switch with the brake pedal released. (The mode changes each time the switch is pressed.)

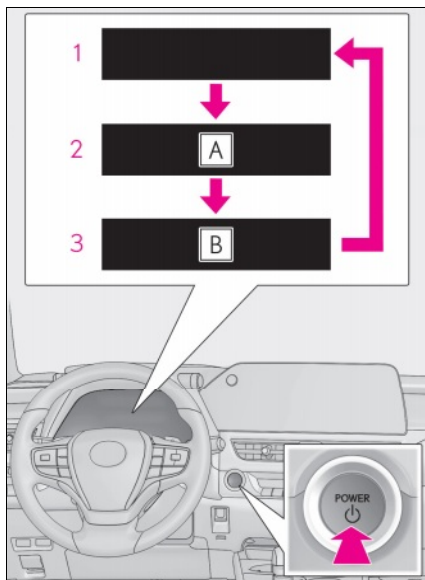

A ACCESSORY

B POWER ON

1 OFF

The emergency flashers can be used.

2 ACC*

Some electrical components such as the audio system can be used.

“ACCESSORY” will be displayed on the meter.

3 ON

All electrical components can be used.

“POWER ON” will be displayed on the meter.

*: ACC mode can be enabled/disabled on the customize menu.

If your vehicle has to be stopped in an emergency

Only in an emergency, such as if it becomes impossible to stop the vehicle in the normal way, stop the vehicle using the following procedure:

- 1** Steadily step on the brake pedal with both feet and firmly depress it.
Do not pump the brake pedal repeatedly as this will increase the effort required to slow the vehicle.
- 2** Shift the shift lever to N.
▶ **If the shift lever is shifted to N**
- 3** After slowing down, stop the vehicle in a safe place by the road.
- 4** Stop the hybrid system.
▶ **If the shift lever cannot be shifted to N**
- 3** Keep depressing the brake pedal with both feet to reduce vehicle speed as much as possible.

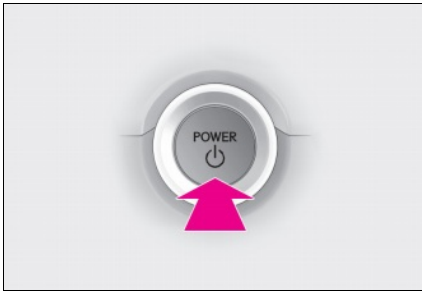

- 4** To stop the hybrid system, press and hold the power switch for 2 consecutive seconds or more, or press it briefly 3 times or more in succession.

- 5** Stop the vehicle in a safe place by the road.

EV Drive Mode

In EV drive mode, electric power is supplied by the hybrid battery (traction battery), and only the electric motor (traction motor) is used to drive the vehicle.

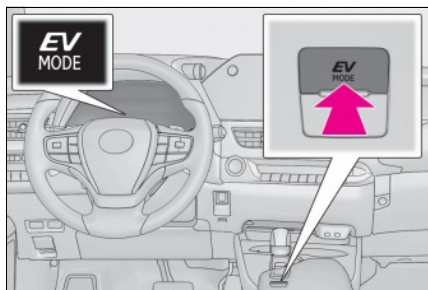

Turns EV drive mode on/off

When EV drive mode is turned on, the EV drive mode indicator will come on. Pressing the switch when in EV drive mode will return the vehicle to normal driving (using the gasoline engine and electric motor [traction motor]).

Hybrid Transmission

Shift position display and how to change the shift position

► Vehicles without paddle shift switches

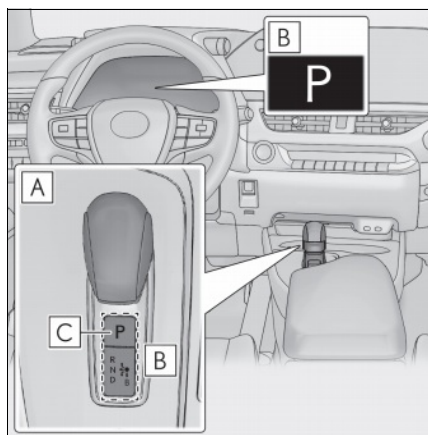

A Shift lever

Operate the shift lever gently and securely in the direction of the arrow on the shift position indicator.

To shift to N, slide the shift lever in the direction of the arrow and hold it.

Release the shift lever after each shifting operation to allow it to return to its regular position (●).

Shifting to B is only possible when the shift position is in D.

When shifting from P to N, D or R, from N, D, B or R to P, from D or B to R, or from R to D, ensure that the brake pedal is being depressed and the vehicle is stationary.

B Shift position indicator

Meter display:

The current shift position is illuminated.

Shift lever display:

The current shift position is illuminated.

When selecting the shift position, make sure that the shift position has been changed to the desired position by checking the shift position indicator provided on the instrument cluster.

C P position switch

Fully stop the vehicle and set the parking brake, and then press the P position switch.

When the shift position is changed to P, the switch illuminates.

Check that the shift position indicator shows P.

► Vehicles with paddle shift switches

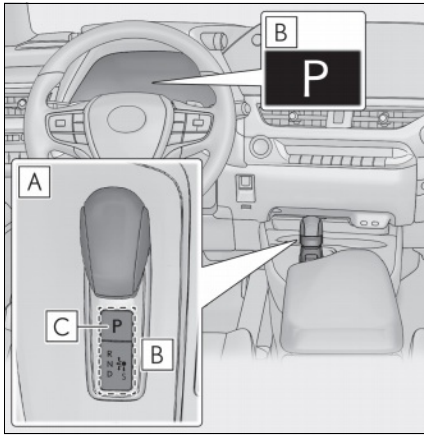

A Shift lever

Operate the shift lever gently and securely in the direction of the arrow on the shift position indicator.

To shift to N, slide the shift lever in the direction of the arrow and hold it.

Release the shift lever after each shifting operation to allow it to return to its regular position (●).

Shifting to S is only possible when the shift position is in D.

When shifting from P to N, D or R, from N, D, S or R to P, from D or S to R, or from R to D, ensure that the brake pedal is being depressed and the vehicle is stationary.

B Shift position indicator

Meter display:

The current shift position is illuminated.

Shift lever display:

The current shift position is illuminated.

When selecting the shift position, make sure that the shift position has been changed to the desired position by checking the shift position indicator provided on the instrument cluster.

C P position switch

Fully stop the vehicle and set the parking brake, and then press the P position switch.

When the shift position is changed to P, the switch illuminates.

Check that the shift position indicator shows P.

Shift position purpose and functions

► Vehicles without paddle shift switches

Shift position	Objective or function
P	Parking the vehicle/starting the hybrid system
R	Reversing
N	Neutral (Condition in which the power is not transmitted)
D	Normal driving [*]
B	Applying engine braking or strong braking when the accelerator pedal has been released on steep downward slopes etc.

^{*}: To improve fuel efficiency and reduce noise, set the shift position in D for normal driving.

► Vehicles with paddle shift switches

Shift position	Objective or function
P	Parking the vehicle/starting the hybrid system
R	Reversing
N	Neutral (Condition in which the power is not transmitted)
D	Normal driving ^{*1}
S	S mode driving ^{*2}

^{*1}: To improve fuel efficiency and reduce noise, set the shift position in D for normal driving. You can choose gear range suitable for your driving situation by operating the paddle shift switches.

^{*2}: By selecting shift ranges using S mode, you can control accelerating force and engine braking force.

Selecting shift ranges in the D position (vehicles with paddle shift switches)

To drive using temporary shift range selection, operate the “-” or “+” paddle shift switch when driving with the shift position in D.

When the “-” paddle shift switch is operated, the shift range switches to a range that enables engine braking force that is suitable to driving conditions. When the “+” paddle shift switch is operated, the shift range switches to a range that is one range higher than the current range.

Changing the shift range allows restriction of the highest gear, preventing unnecessary upshifting and enabling the level of engine braking force to be selected.

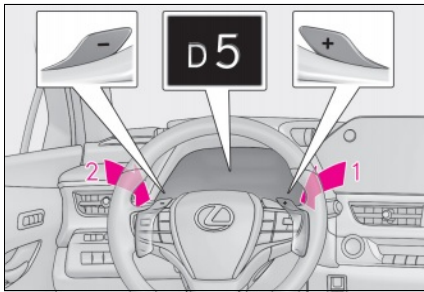

1 Upshifting

2 Downshifting

The selected shift range, from D1 to D6, will be displayed in the meter.

To return to normal D position driving, the “+” paddle shift switch must be held down for a period of time.

Meter display	Function
D2 - D6	A gear in the range between D1 and the selected shift range is automatically chosen depending on vehicle speed and driving conditions
D1	Setting the shift range at D1

A lower shift range will provide greater engine braking forces than a higher shift range.

Selecting shift ranges in the S mode (vehicles with paddle shift switches)

To enter S mode, shift the shift position to S. Shift ranges can be selected by operating the shift lever or paddle shift switches.

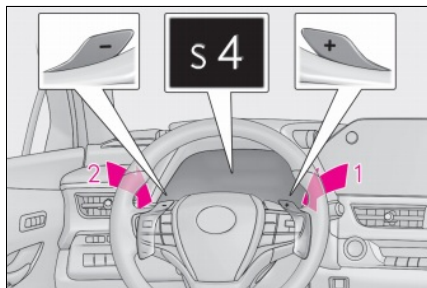

1 Upshifting

2 Downshifting

The selected shift range, from S1 to S6, will be displayed in the meter.

The initial shift range in S mode is 4 or 5.

■ Shift ranges and their functions

- You can choose from 6 levels of accelerating force and engine braking force.
- A lower shift range will provide greater accelerating force and engine braking force than a higher shift range, and the engine revolutions will also increase.

Turn Signal Lever

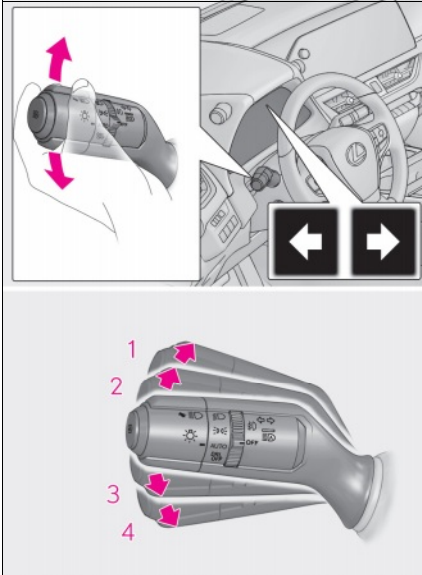

- 1** Right turn
- 2** Lane change to the right (move the lever partway and release it)
The right hand signals will flash 3 times.
- 3** Lane change to the left (move the lever partway and release it)
The left hand signals will flash 3 times.
- 4** Left turn

Parking Brake

The parking brake can be set or released automatically or manually.

Using the manual mode

The parking brake can be set and released manually.

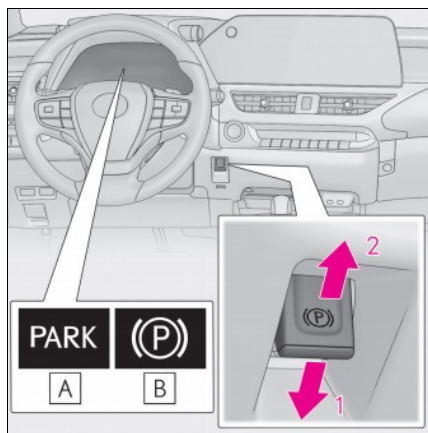

A U.S.A.

B Canada

1 Push the switch to set the parking brake

The parking brake indicator light will turn on.

Press and hold the parking brake switch if an emergency occurs and it is necessary to operate the parking brake while driving.

2 Pull the switch to release the parking brake

- Operate the parking brake switch while depressing the brake pedal.
- Using the parking brake automatic release function, the parking brake can be released by depressing the accelerator pedal. When using this function, slowly depress the accelerator pedal.

Make sure that the parking brake indicator light turn off.

Turning the automatic mode on

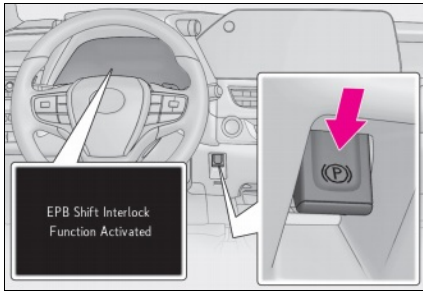

While the vehicle is stopped, press and hold the parking brake switch until a message is shown on the multi-information display

When the automatic mode is turned on, the parking brake operates as follows.

- When the shift position is shifted from P, the parking brake will be released, and the parking brake indicator light will turn off.
- When the shift position is shifted to P, the parking brake will be set, and the parking brake indicator light will turn on.

Operate the shift position and P position switch with the vehicle stopped and the brake pedal depressed.

Turning the automatic mode off

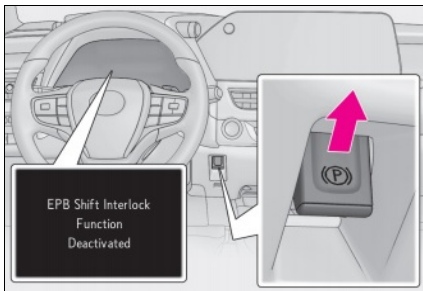

While the vehicle is stopped, pull and hold the parking brake switch until a message is shown on the multi-information display

Brake Hold

The brake hold system keeps the brake applied when the shift position is in D, B^{*1}, S^{*2}, N or P with the system on and the brake pedal has been depressed to stop the vehicle. The system releases the brake when the accelerator pedal is depressed with the shift position in D, B^{*1} or S^{*2} to allow smooth start off.

*1: Vehicles without paddle shift switches

*2: Vehicles with paddle shift switches

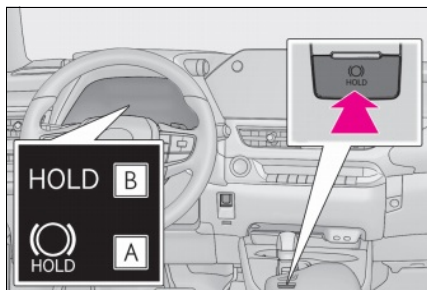

Turn the brake hold system on

The brake hold standby indicator (green)

A comes on. While the system is holding the brake, the brake hold operated indicator (yellow) **B** comes on.

Multi-information Display (with 7-inch Display)

Displayed contents summary

■ Display area

A variety of driving-related information can be displayed. Depending on the situation, warning or advice pop-up displays will also be displayed.

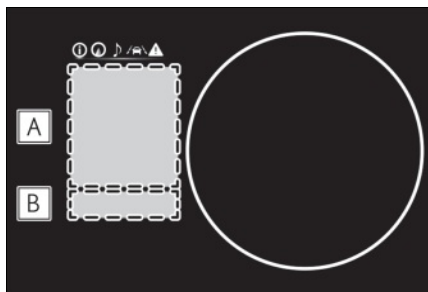

A Content display area

B Driving support system information display area

When a menu icon other than  is selected, if the driving support system operates, the system operating state will be displayed.

■ Items displayed in the content display area

By selecting menu icons on the multi-information display, the following items can be displayed.



Driving information display



Navigation system-linked display (if equipped)



Audio system-linked display



Driving support system information display



Warning message

Multi-information Display (with 12.3-inch Display)

The multi-information display is used to display fuel efficiency related information and various types of driving-related information. The multi-information display can also be used to change the display settings and other settings.

Display contents

Following information is displayed in each area on the multi-information display.

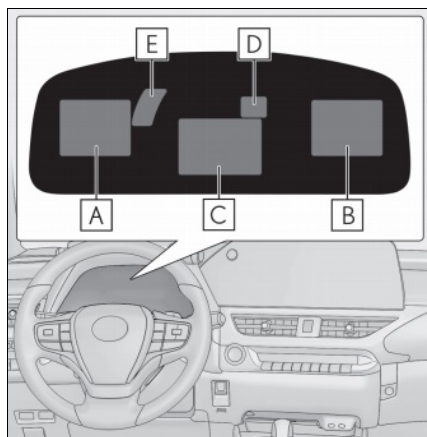

- A** Content display area (left)
- B** Content display area (right)
- C** Content display area (center)
- D** Driving support system information display area

When driving support system information is displayed on the content display area, the system operating state will not be displayed in this area.

- E** RSA (Road Sign Assist) display area (if equipped)

■ Content display area (center)

- Driving support system information display
- Map display (if equipped)
- Blank

■ Content display area (left/right)

- Fuel Economy
- EV Driving Ratio
- Driving support system information display
- Navigation system-linked information display
- Audio system-linked display
- Drive information display
- Energy monitor
- G-force
- Blank

Head-up Display (if equipped)

The head-up display projects a variety of driving-related information and the operating state of the driving support systems on the windshield.

Head-up display

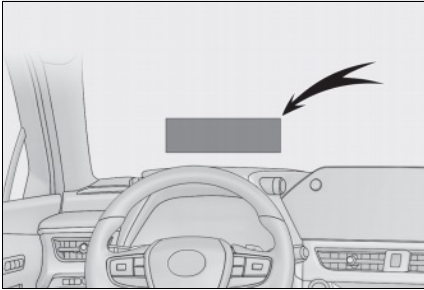

The meter display type setting of head-up display can be changed. (→P.36)

The content displayed will differ according to the driving conditions and display mode of the head-up display. Depending on the situation, pop-up displays will also be displayed.

■ Full

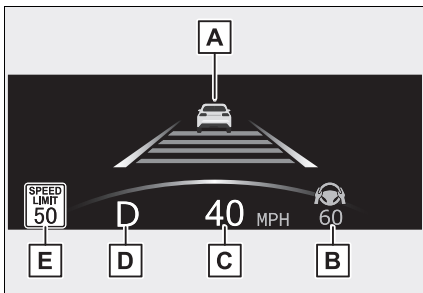

Illustrations used in this text are intended as examples, and may differ from the image that is actually displayed by the head-up display.

A Driving support system display area/
Navigation system-linked display area/
Hybrid system Indicator or Tachometer
display area

B Driving support system display area

C Speedometer

D Shift position/shift range (→P.24)

E RSA (Road Sign Assist) display (if equipped)

■ Standard

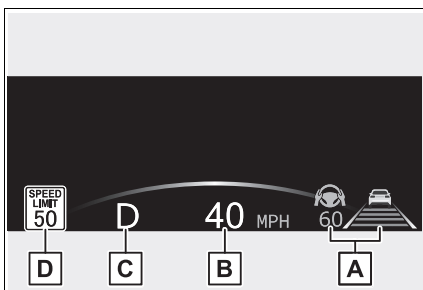

Illustrations used in this text are intended as examples, and may differ from the image that is actually displayed by the head-up display.

A Driving support system display area

B Speedometer

C Shift position/shift range (→P.24)

D RSA (Road Sign Assist) display (if
equipped)

■ Minimum



A Speedometer

■ Changing settings of the head-up display

- 1 Select  on the Center display.
- 2 Select "Vehicle customize".
- 3 Select "Head up display".

The following settings can be changed.

- Enabling/disabling the head-up display
Select to enabling/disabling the head-up display.
- Head-up display type
Select to change head-up display type. (→P.35)
- Brightness and vertical position of the head-up display
Select to adjust the brightness or vertical position of the head-up display.
- Display angle
Select to adjust the angle of the head-up display.

Hybrid System Indicator/tachometer display area

Hybrid System Indicator

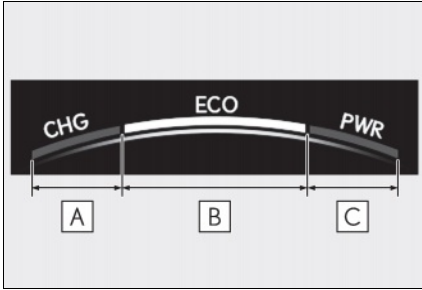

A Charge area

B Eco area

C Power area

Displays hybrid system output or regeneration level. For details, refer to P.12.

The head-up display may seem dark or hard to see when viewed through sunglasses, especially polarized sunglasses. Adjust the brightness of the head-up display or remove your sunglasses.

Displayed Content

Components/Operations

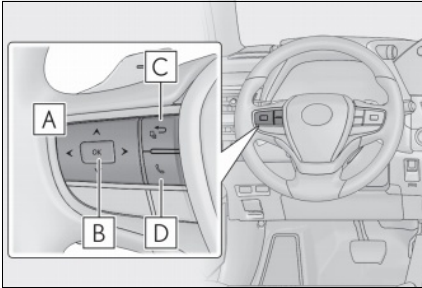

- A** < / > : Change the screen and move the cursor
^ / v : Change the displayed content and scroll up/down the screen
- B** Press: Enter/Set
Press and hold: Reset/Display customizable items, display the cursor
- C** Return to the previous screen
- D** Call sending/receiving and history display

Linked with the hands-free system, sending or receiving call is displayed. For details regarding the hands-free system, refer to the "MULTIMEDIA OWNER'S MANUAL".

Energy monitor

The energy monitor can be used to check the vehicle drive status, hybrid system operation status and energy regeneration status on the Center display.

■ Displaying Energy monitor screen on the Center display

Touch  on the main menu, then touch "Energy flow" on the sub menu.

■ Reading the display

The arrows will appear in accordance with the energy flow. When there is no energy flow, arrows will not be displayed.

▶ Multi-information display (vehicles with 7-inch display)

The color of the arrows will change as follows

- Blue: When the hybrid battery (traction battery) is regenerated or charged.
- Orange: When the hybrid battery (traction battery) is in use.
- Red: When the gasoline engine is in use.

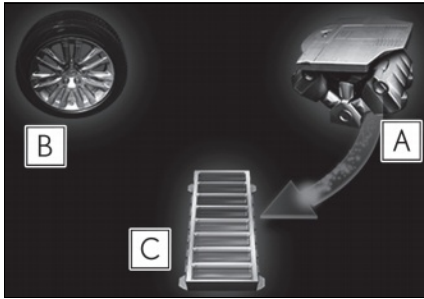

- A** Gasoline engine
- B** Tires
- C** Hybrid battery (traction battery)

▶ Multi-information display (vehicles with 12.3inch display)

The color of the arrows will change as follows

- Blue: When the hybrid battery (traction battery) is regenerated or charged.
- Orange: When the hybrid battery (traction battery) is in use.
- Red: When the gasoline engine is in use.

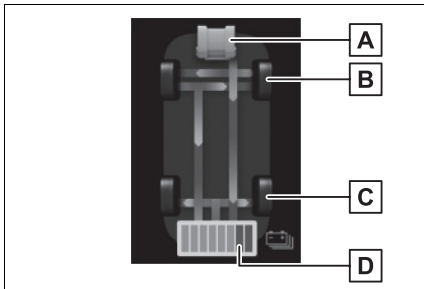

- A** Gasoline engine
- B** Front tires
- C** Rear tires
- D** Hybrid battery (traction battery)

► **Center display**

The image shows all the arrows as an example. The actual display will vary depending on conditions.

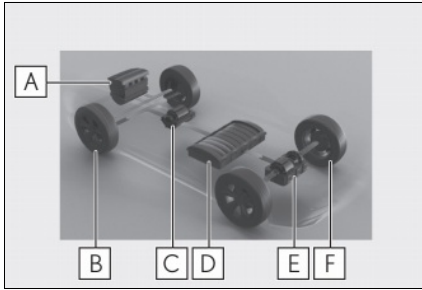

- A** Gasoline engine
- B** Front tires
- C** Front electric motor (traction motor)
- D** Hybrid battery (traction battery)
- E** Rear electric motor (traction motor) (if equipped)
- F** Rear tires

The color of the arrows will change as follows

Blue: When the hybrid battery (traction battery) is regenerated or charged.

Orange: When the hybrid battery (traction battery) is in use.

Red: When the gasoline engine is in use.

Current fuel consumption/history screen

Fuel consumption information can be displayed on the Center display.

■ Displaying fuel consumption/history screen on the Center display

- 1 Select  on the main menu.
- 2 Select "Trip info".
- 3 Select "Current" or "History".

■ Current fuel consumption screen

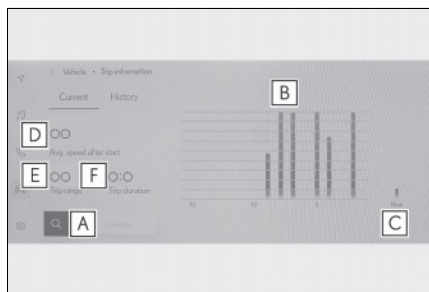

- A** Resetting the history data
- B** Fuel consumption in the past 15 minutes
- C** Current fuel consumption
- D** Average vehicle speed since the hybrid system was started.
- E** Trip range
- F** Elapsed time since the hybrid system was started.

Use the displayed average fuel consumption as a reference. The image is an example only, and may vary slightly from actual conditions.

■ History fuel consumption screen

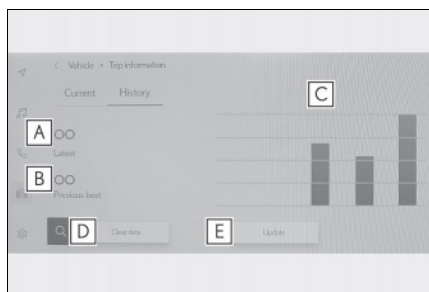



- A** Latest fuel consumption
- B** Best recorded fuel consumption
- C** Previous fuel consumption record
- D** Resetting the history data
- E** Updating the latest fuel consumption data

Use the displayed average fuel consumption as a reference. The image is an example only, and may vary slightly from actual conditions.

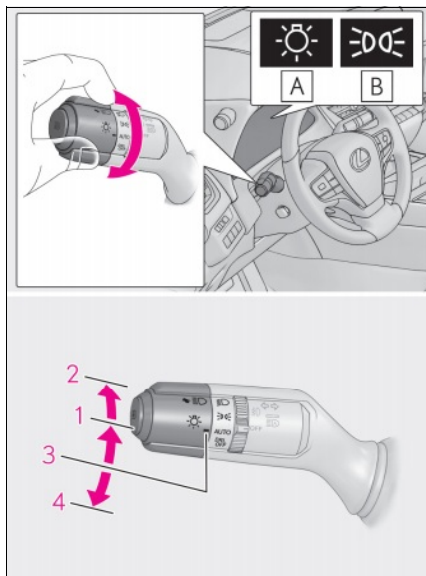
Headlight Switch



- A** U.S.A.
- B** Canada

- 1**  The side marker, parking, tail, license plate, instrument panel lights, and daytime running lights turn on.
- 2**  The headlights and all the lights listed above (except daytime running lights) turn on.
- 3** AUTO The headlights, daytime running lights and all the lights listed above turn on and off automatically.
- 4**  (U.S.A.) Off

Turning on the high beam headlights

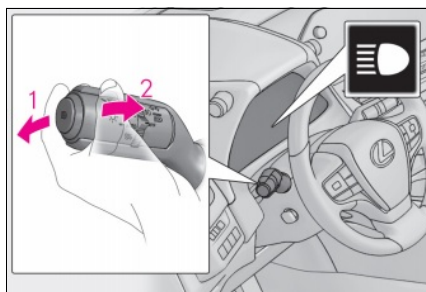

- 1** With the headlights on, push the lever away from you to turn on the high beams.
Pull the lever toward you to the center position to turn the high beams off.
- 2** Pull the lever toward you and release it to flash the high beams once.
You can flash the high beams with the headlights on or off.

AHB (Automatic High Beam)

The Automatic High Beam uses a front camera located on the upper portion of the windshield to detect the brightness of the lights of vehicles ahead, streetlights, etc., and automatically changes the headlights between the high beams and low beams.

Using the Automatic High Beam system

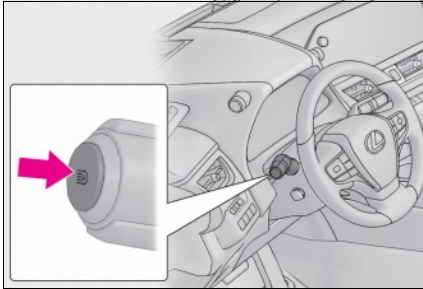

- 1 Press the Automatic High Beam switch.

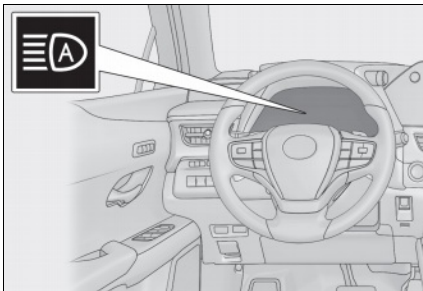

- 2 Turn the headlight switch to the  or AUTO position.

When the headlight switch lever is in the low beam position, the AHB system will be enabled and the AHB indicator will illuminate.

Turning the high beams on/off manually

■ Changing to the high beams

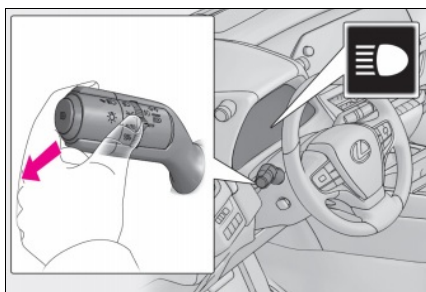

Push the lever forward.

The AHB indicator will turn off and the high beam indicator will turn on.

Pull the lever to its original position to enable the Automatic High Beam system again.

■ Changing to the low beams

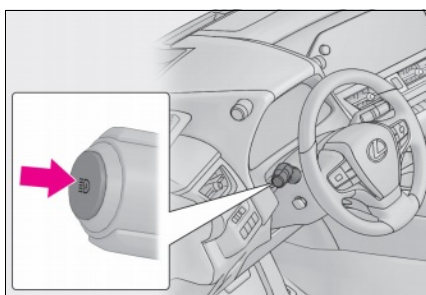

Press the Automatic High Beam switch.

The AHB indicator will turn off.

Press the switch to enable the Automatic High Beam system again.

Temporarily changing to the low beams

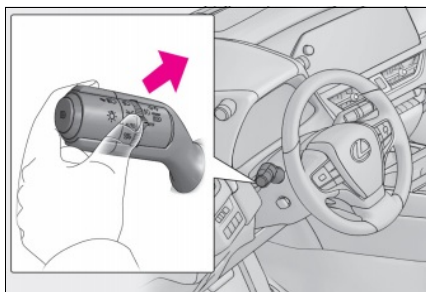

It is recommended to switch to the low beams when use of the high beams is inappropriate or when the high beams may cause problems or distress to other drivers or pedestrians nearby.

Pull the lever rearward and then return it to its original position.

The high beams will illuminate while the lever is pulled, however, after the lever is returned to its original position, the low beams will remain on for a certain amount of time. After this, the Automatic High Beam system will operate.

Fog Light Switch (if equipped)

When in difficult driving conditions, such as in rain and fog, turn on the fog lights to secure front visibility.

Turning on the fog light

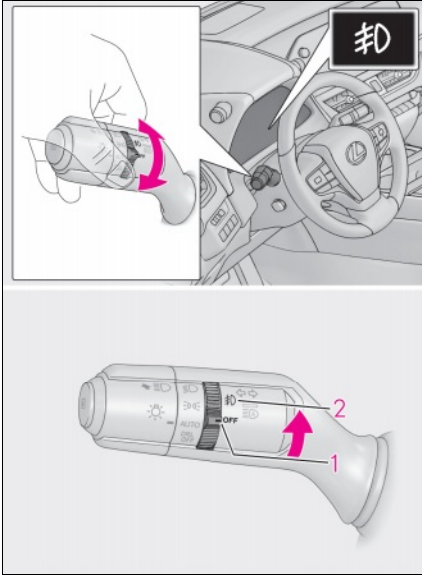

1 OFF *1 or ○ *2 Turns the fog lights off

2 ☁ Turns the fog lights on

*1: For the U.S.A.

*2: For Canada

Windshield Wipers and Washer

► Intermittent windshield wipers with interval adjuster

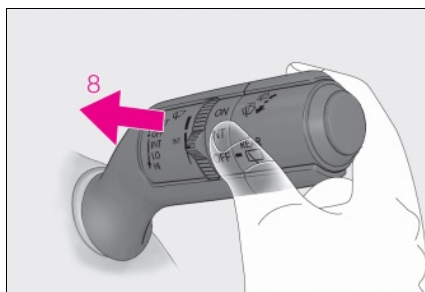
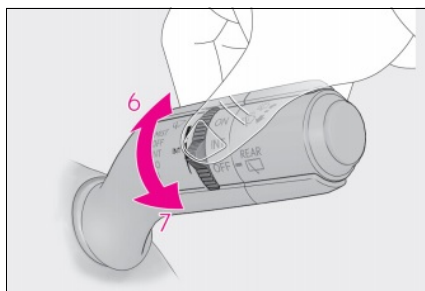
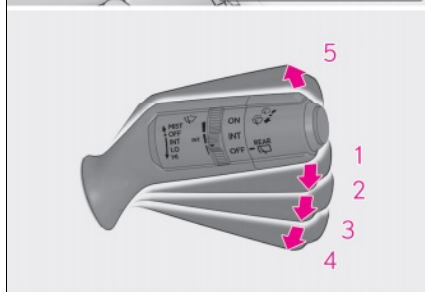
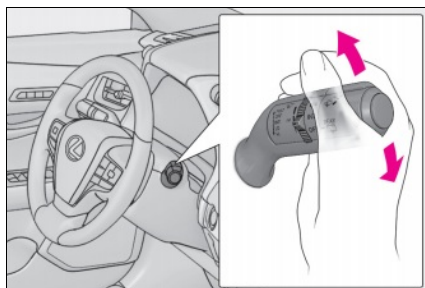

- 1 OFF** *1 or ○ *2 Off
- 2 INT** *1 or  *2 Intermittent operation
- 3 LO** *1 or ▼ *2 Low speed operation
- 4 HI** *1 or ▼▼ *2 High speed operation
- 5 MIST** *1 or ▲ *2 Temporary operation

*1: For the U.S.A.

*2: For Canada

Wiper intervals can be adjusted when intermittent operation is selected.

- 6** Increases the intermittent windshield wiper frequency
- 7** Decreases the intermittent windshield wiper frequency
- 8**  Washer/wiper dual operation

Pulling the lever operates the wipers and washer.

The wipers will automatically operate a couple of times after the washer squirts.

Vehicles with headlight cleaners: When the power switch is in ON and the headlights are on, if the lever is pulled, the headlight cleaners will operate once. After this, the headlight cleaners will operate every 5th time the lever is pulled.

► Rain-sensing windshield wipers

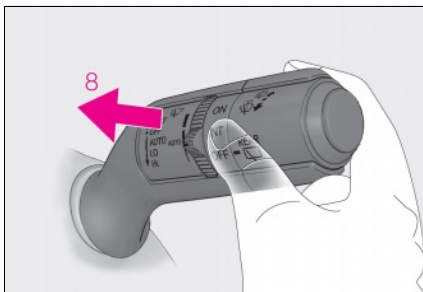
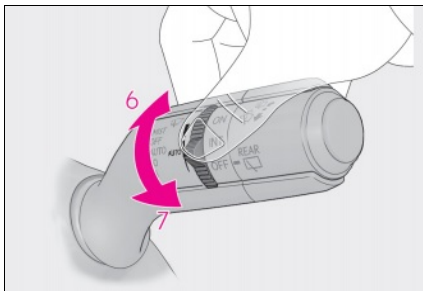
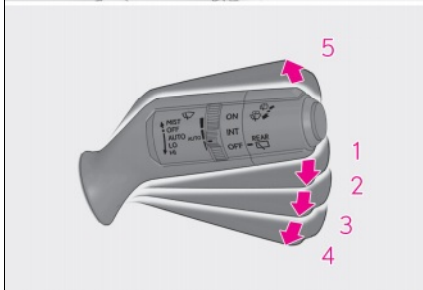
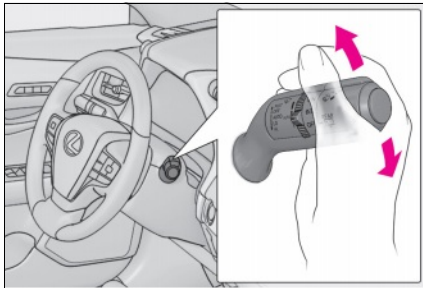

- 1 OFF** *1 or ○ *2 Off
- 2 AUTO** *1 Rain-sensing operation
- 3 LO** *1 or ▼ *2 Low speed operation
- 4 HI** *1 or ▼ *2 High speed operation
- 5 MIST** *1 or ▲ *2 Temporary operation

*1: For the U.S.A.

*2: For Canada

When AUTO is selected, the sensor sensitivity can be adjusted by turning the switch ring.

- 6** Increases the sensitivity
- 7** Decreases the sensitivity

- 8**  Washer/wiper dual operation

Pulling the lever operates the wipers and washer.

The wipers will automatically operate a couple of times after the washer squirts.

(After operating several times, the wipers operate once more time after a short delay to prevent dripping. However, the dripping prevention does not operate while the vehicle is moving.)

Vehicles with headlight cleaners: When the power switch is in ON and the headlights are on, if the lever is pulled, the headlight cleaners will operate once. After this, the headlight cleaners will operate every 5th time the lever is pulled.

Rear Window Wiper and Washer

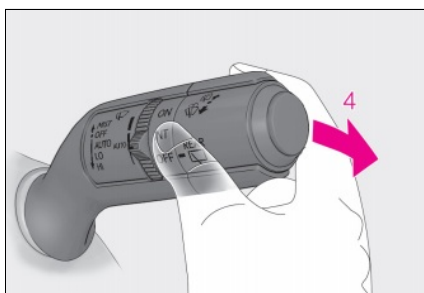
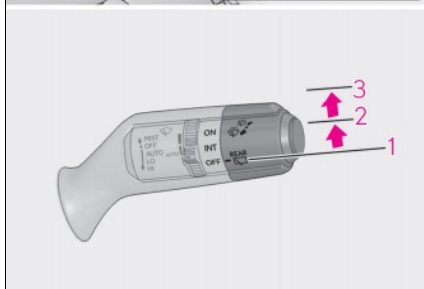
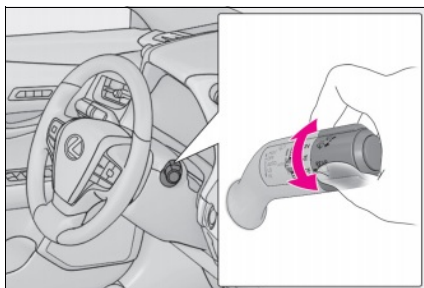

- 1 OFF** ^{*1} or ○ ^{*2} Off
- 2 INT** ^{*1} or --- ^{*2} Intermittent operation
- 3 ON** ^{*1} or — ^{*2} Normal operation

*1: For the U.S.A.

*2: For Canada

- 4**  Washer/wiper dual operation

Pushing the lever operates the wiper and washer.

The wiper will automatically operate a couple of times after the washer squirts.

Basic Operation of Multimedia System

Map scrolling operation

The map can be moved and a touched point can be set as the center of the map screen.

■ Flick/drag operation

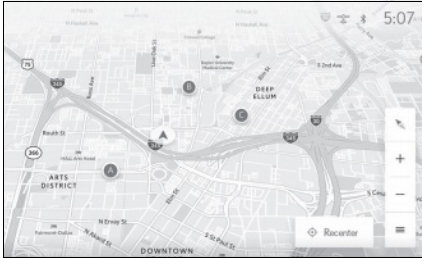

The map screen can be moved by touching, dragging or flicking it.

Touch [Recenter] to return to the center of the map to the current position.

■ Touch and hold operation

If a desired point on the map screen is touched and held, the full route map screen to the selected point will be displayed.

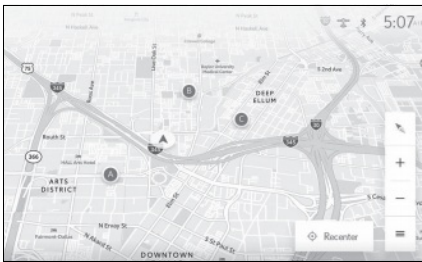

1 Touch and hold the desired point.

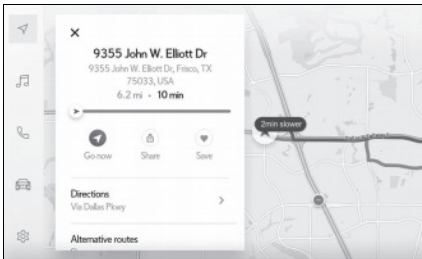

2 Full route map screen will be displayed for the selected point.

Navigation (if equipped)

The navigation system indicates your present position and assists in locating a desired destination.

Destination search screen

■ Searching for a destination using the keyboard

A destination can be searched for by entering keywords.

1 Touch [] or [] on the map screen.

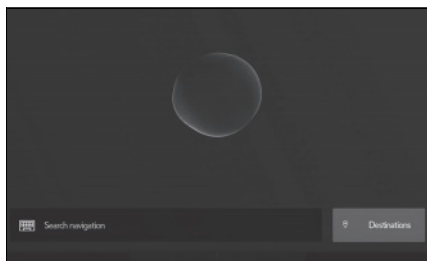

2 Touch [Search navigation].



3 Enter characters using the keyboard.

4 Touch [Go].

5 Touch the desired item from the list.

■ Searching for a destination by category

A destination can be searched for from a list of categories.

1 Touch [🎤] or [🔍] on the map screen.

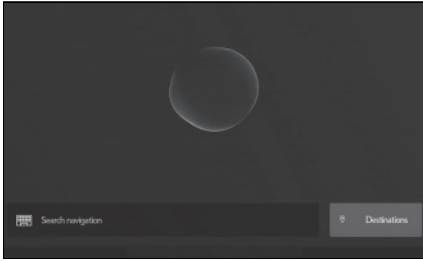

2 Touch [Destinations].

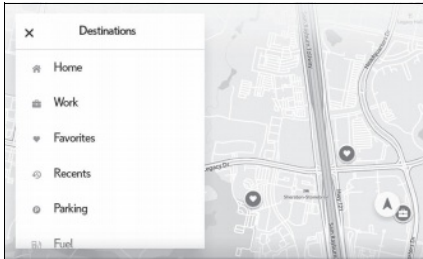

3 Touch the desired search method.

[Home]: Touch to set the registered home as the destination. A point must be registered as home before using this function.*

[Work]: Touch to set the registered workplace as the destination. A point must be registered as a workplace before using this function.*

[Favorites]: Touch to set a registered favorite as the destination. A point must be registered as a favorite before using this function.

[Recents]: Touch to set a destination from the destination history as the destination.

[Send to car]: Send to car enables customer to send a destination or POI to the vehicle from Lexus app.

[Parking]: Touch to search for a nearby parking lot to set as a destination.

[Fuel]: Touch to search for a fuel station/charging facility to set as a destination.

[Food]: Touch to search for a restaurant to set as a destination.

[Hospitals]: Touch to search for a hospital to set as a destination.

When setting a business as a destination, if your estimated time of arrival is outside of business hours or near closing time, a notification asking to confirm the destination will be displayed.

*: Home and Work must be added via Lexus app.

4 Touch the desired destination from the list.

► **Editing the favorites list**

The favorites list can be edited.

1 Touch [📍] or [🔍] on the map screen.

2 Touch [Destinations].

3 Touch [Favorites].

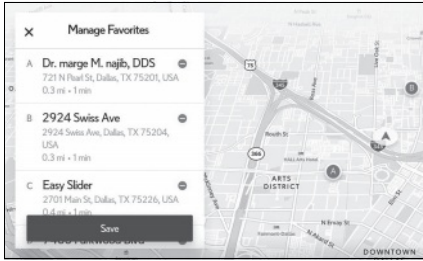

5 Touch [Save].

► **Editing the destination history**

The destination history can be edited.

1 Touch [📍] or [🔍] on the map screen.

2 Touch [Destinations].

3 Touch [Recents].

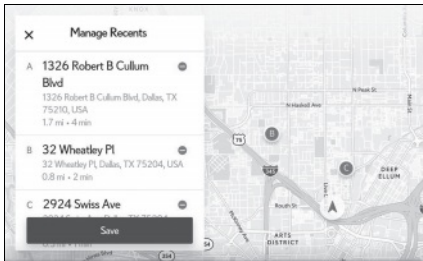

5 Touch [Save].

4 Touch [✎].

Touch [⊖] to delete a favorite.

The favorites list editing screen will be displayed.

4 Touch [✎].

The destination history editing screen will be displayed.

Touch [⊖] to delete a destination history item.

■ Searching for a destination using voice control

1 Touch [] or [] on the map screen.

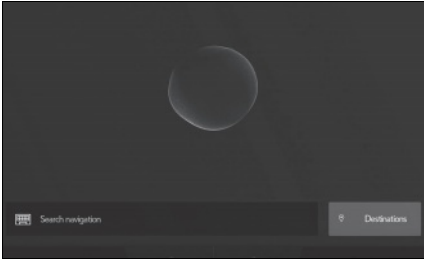

2 Say the keyword you wish to use for the search.

3 Touch the desired item from the list.

Connecting a Smartphone or Communication Device

Registering a Bluetooth® device from the multimedia system

A cellular phone or portable device must be registered in order to use hands-free calling or Bluetooth® audio. Once registration is complete, Bluetooth® will automatically be connected each time the multimedia system is started.

When Apple CarPlay/Android Auto is connected via USB, the device will be registered automatically.

If no Bluetooth® device is connected, the registration screen can also be displayed by pressing and holding the [] switch on the steering wheel.

- 1 Touch [] from the main menu.
- 2 Touch [Bluetooth & Devices] on the sub menu.

If no device is registered, proceed to Procedure 4.

- 3 Touch [Add another device].

While a device is connected to the multimedia system, the confirmation screen for disconnecting the device may be displayed. Disconnect the device to perform registration.

- 4 Touch [Search for devices].

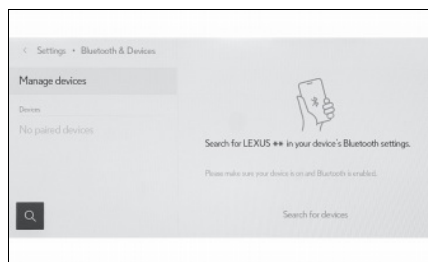

- 5 Touch the device to register from the main area.
- The Bluetooth® address may be displayed instead of the device name.
 - Certain models of Bluetooth® devices may not be displayed in the device list, unless a certain screen is displayed on the Bluetooth® device. Refer to the Bluetooth® device's instruction manual for details.

- 6 Check that the displayed PIN code matches the PIN code displayed on the Bluetooth® device, and then touch [OK].
- Some Bluetooth® devices may need to be operated to complete registration.
- When an HFP supported Bluetooth® device is registered, that device is automatically set as the primary device if the driver does not have a primary device set.
- The Apple CarPlay or Android Auto settings may be displayed. The Apple CarPlay or Android Auto screen will be displayed if the use of either is enabled.
- A message indicating that connection is complete is displayed, and the name of the registered Bluetooth® device is displayed in the sub menu.
- If an operation failed screen is displayed, follow the operation instructions on the screen.

■ Registering from a Bluetooth® device

If the Bluetooth® device cannot be found by searching with the multimedia system, register by searching for the multimedia system from the Bluetooth® device.

- 1 Touch [] from the main menu.
 - 2 Touch [Bluetooth & Devices] on the sub menu.
- If no device is registered, proceed to Procedure 4.
- 3 Touch [Add another device].

While a device is connected to the multimedia system, the confirmation screen for disconnecting the device may be displayed. Disconnect the device to perform registration.

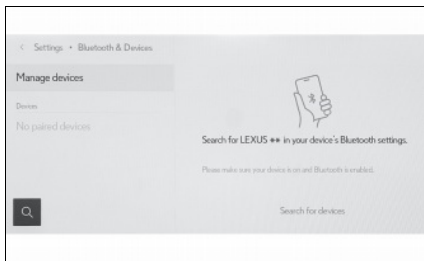

- 4 Register the multimedia system from the Bluetooth® device to be used.
- Perform the operation according to the operating procedure of the Bluetooth® device.
- Be sure to display this Bluetooth® connection screen before performing registration on the Bluetooth® device.

- 5 Check that the displayed PIN code matches the PIN code displayed on the Bluetooth® device, and then touch [OK].
- Some Bluetooth® devices may need to be operated to complete registration.
 - When an HFP supported Bluetooth® device is registered, that device is automatically set as the primary device if the driver does not have a primary device set.
 - The Apple CarPlay or Android Auto settings may be displayed. The Apple CarPlay or Android Auto screen will be displayed if the use of either is enabled.
 - A message indicating that connection is complete is displayed, and the name of the registered Bluetooth® device is displayed in the sub menu.
 - If an operation failed screen is displayed, follow the operation instructions on the screen.

■ Operating with the steering switches

Some hands-free call functions can be operated from the steering switches, such as receiving or making calls. The steering switch functions change depending on the status of the multimedia system.

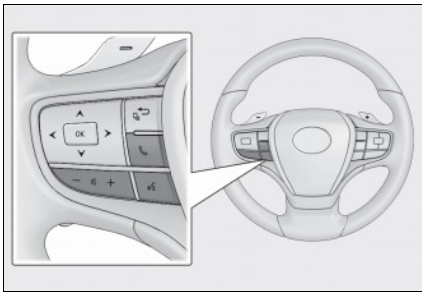

- Operate the switches as necessary.
[+] switch
Increases the ringtone volume or receiver volume.
Press and hold to adjust continuously.
- [-] switch
Decreases the ringtone volume or receiver volume.
Press and hold to adjust continuously.

[] switch

Calls can be made using Intelligent Assistant.

To end voice command, press and hold the talk switch.

[] switch

- While a call cannot be made, displays call history screen or phone menu.
- Phone calls can be made when [] is displayed on the phone screen.
- While making a call or during a call, ends the call.
- While receiving a call or during call waiting, answers the call.

Making calls from call history

Calls can be made to phone numbers that have been recorded in the call history as outgoing or incoming calls.

- 1 Touch [📞] from the main menu.
- 2 Touch [Recents] on the sub menu.

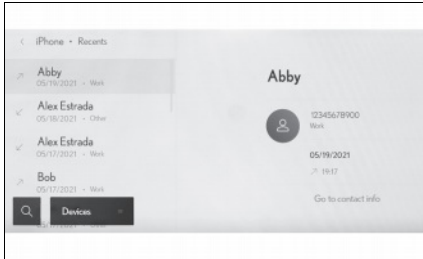

- 3 Select the contact.

For phone numbers that are not registered in the phonebook, the phone number will be displayed.

- 4 Touch the desired phone number.

Making calls from the favorites list

Make a call from your favorites list.

- 1 Touch [📞] from the main menu.
- 2 Touch [Favorites] on the sub menu.

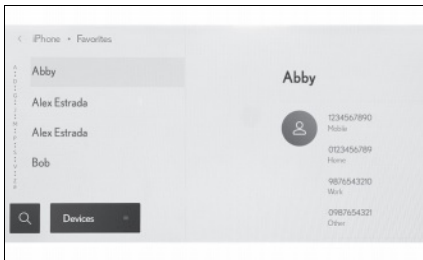

- 3 Select the person you want to call from your favorites list.

- 4 Touch the desired phone number.

Making calls from contacts

Make a call from the contacts registered on the multimedia system.

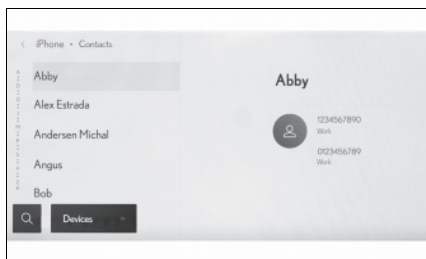

- 1 Touch [] from the main menu.
- 2 Touch [Contacts] on the sub menu.
- 3 Select a contact.
- 4 Touch the desired phone number.

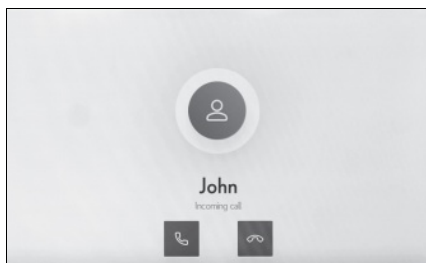

Answering calls

When there is an incoming call, the incoming call sounds and the incoming call screen or incoming call notification is displayed.



- Answer the call by doing one of the following.
 - Touch [].
 - Press the [] switch on the steering wheel.

Making calls from the message function

Hands-free calls can be made using the message function.

- Touch the blue number to make a call.
Consecutive numbers may be recognized as phone numbers. In addition, some phone numbers, such as phone numbers from other countries, may not be recognized.

Basic Operation of Audio System

Changing the audio source

Source can be changed to radio, USB, etc.

- 1 Touch [] from the main menu.
- 2 Touch [Sources].



- 3 Touch the source you wish to select.

Listening to the radio

Switch to your preferred frequency or service and listen to the radio.

- 1 Touch [] from the main menu.
- 2 Touch [Sources].
- 3 Touch [Radio].
- 4 Select the station selection method or service as necessary.

[Favorites]: Select a broadcasting station from those registered as favorites.

[Tune]: Select the broadcasting station by entering a frequency with the numeric keypad.

[FM Radio]: Switches to FM mode. The FM station list, the 3 most recently listened stations, and the receivable FM broadcasting stations are displayed.

[AM Radio]: Switches to AM mode. The AM station list, the 3 most recently listened stations, and the receivable AM broadcasting stations are displayed.

[SiriusXM]: Switches to SiriusXM Radio mode. Displays [For You] and contents/Super Categories/[All channels]/[Listening History].

- 5 Select the broadcasting station from the station list or genre.

- 6 Operate the radio that is being received as necessary.
- Operating AM/FM from the screen

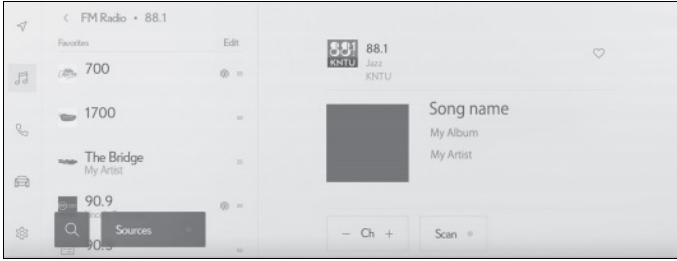

[Ch]: Touch [-] or [+] to search for the receivable broadcasting stations. Touch and hold to jump to the next frequency with available radio signal. When released, the broadcasting station closest to that position with the best reception sensitivity is selected automatically.

[Scan]: SEEK UP and output the audio of the detected station for 10 sec. This is repeated.

[HD 12]: Displayed when Multicast CH is supported in FM mode. Touch to display the SPS channel list. The mode can be changed to the displayed SPS channel list.

[♥]: Registers the currently received broadcasting station in favorites. When registered, touch to cancel.

Preset buttons of sub menu: Receives the selected broadcasting station.

● Operating SiriusXM Radio from the screen *

*: This function is not available in some regions.

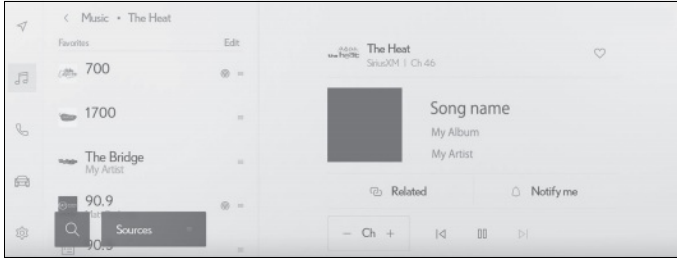

[Ch]: Touch [-] or [+] to search for the receivable channels. Touch and hold to jump to the next frequency with available radio signal. When released, the current channel is received.

[⏮]/[⏭]: Fast rewind or fast forward the radio cache. Touch and hold to jump to the start or end of the buffer.

[⏸]: Pause the radio cache.

[▶]: Play the radio cache.

[Related]: Displays content related to the received channel.

[Notify me]: Select an artist or song, or both an artist and song, to receive a notification when the corresponding broadcast starts. (When receiving a regular channel) Select a sports team to receive a notification when the corresponding broadcast starts. (When receiving a sport channel)

[♥]: Registers the currently received channel in favorites. When registered, touch to cancel.

Preset buttons of sub menu: Receive the registered channels.

● Operating with the steering switches

[<]/[>]switches

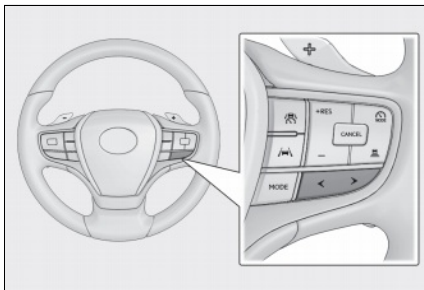

• AM/FM Radio

Switch the frequencies or broadcasting stations registered in the preset buttons in order.

Press and hold to switch frequencies. When released, the broadcasting station closest to that position with the best reception sensitivity is selected automatically.

• SiriusXM Radio

Switch the channels registered in the preset buttons in order.

Press and hold to switch channels. When released, the channel closest to that position with the best reception sensitivity is selected automatically.

Playing iPod/iPhone

Play back music files on an iPod/iPhone connected to the USB port. When an iPod/iPhone is connected, a button with the device's name is displayed on the source selection screen. This may not be displayed for some devices.

Connect an iPod or iPhone.

- 1 Touch [] from the main menu.
- 2 Touch [Sources].
- 3 Touch the device name or [USB].
- 4 Operate an iPod/iPhone that is playing as necessary.

● Operating from the screen

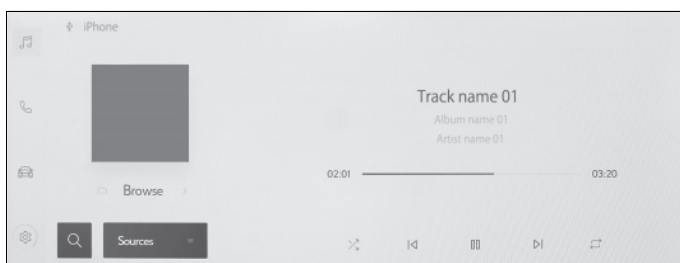

[]: Performs shuffle playback. Each touch switches the shuffle setting.*

[]: Plays the currently playing track from the beginning. When at the start of the track, the previous track will play from the beginning.

Touch and hold to fast rewind. Release to start playback from that position.

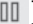
[]: Pauses playback.

[]: Plays.

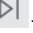
[]: Switches the tracks. Touch and hold to fast forward. Release to start playback from that position.

[]: Performs repeat playback. Each touch switches the repeat setting.

[Browse]: Displays the playback mode in the sub menu. Tracks can be selected from a list sorted by artist, album, song, playlist, genre, Podcast, composer, audiobook, or radio.

[Shuffle play] is displayed when playing a track selected from the list. Touch this to return to the playback screen and perform shuffle playback.

*: The order in which shuffle or repeat settings switch depends on the connected device.

● Operating with the steering switches
[<]/[>]switches

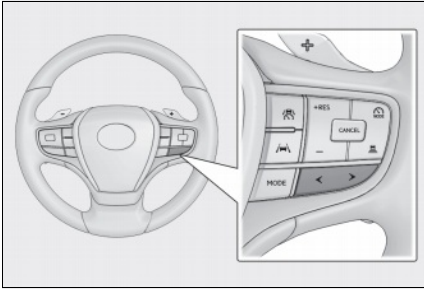

Switch the tracks.

Press and hold to fast forward or fast rewind. Release to start playback from that position.

Lexus Climate Concierge

The seat heaters (if equipped), seat ventilators (if equipped) and heated steering wheel (if equipped) are each automatically controlled according to the set temperature of the air conditioning system, the outside and cabin temperature, etc. Lexus Climate Concierge allows a comfortable condition to be maintained without adjusting each system.

Lexus Climate Concierge can be operated using the air conditioning control panel (→P.65) and air conditioning control screen on the Center Display (→P.66).

Turning on Lexus Climate Concierge

Lexus Climate Concierge operates in conjunction with the automatic mode switch of the air conditioning control panel.

- 1 Select  in the main menu on the Center Display.
- 2 Select "Climate".
- 3 Select "Options".
- 4 Select "Climate concierge".
- 5 Turn the automatic mode switch on.

Automatic Air Conditioning System

The air conditioning system can be operated using the air conditioning control panel and air conditioning control screen on the Center Display (→P.66).

Air conditioning controls

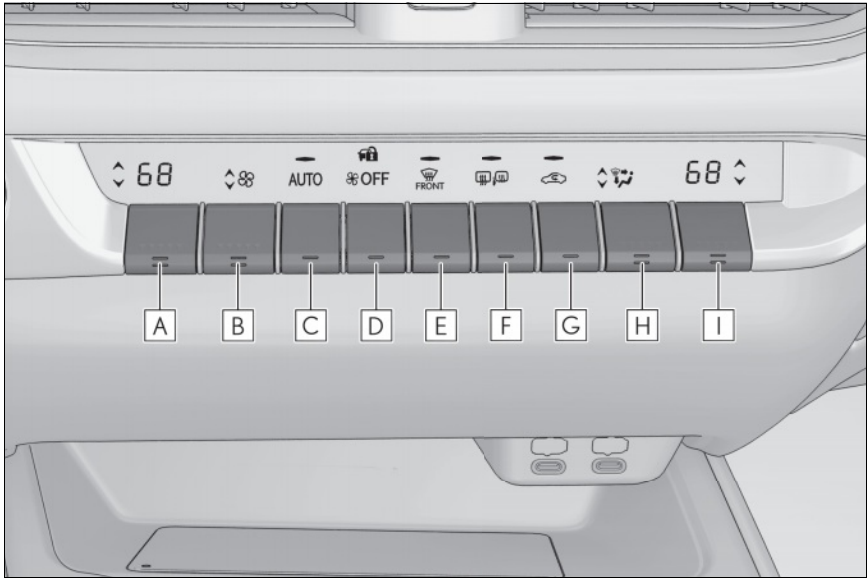

- A** Left-hand side temperature control switch

Operate the temperature control switch upwards to increase the temperature and downwards to decrease the temperature.

- B** Fan speed control switch

- C** Automatic mode switch

- D** Off switch

- E** Windshield defogger switch

- F** Rear window and outside rear view mirror defoggers switch

- G** Outside/recirculated air mode switch

- H** Airflow mode control switch

- I** Right-hand side temperature control switch

Operate the temperature control switch upwards to increase the temperature and downwards to decrease the temperature.

Air conditioning control screen

Air conditioning control screen

1 Select  in the main menu on the Center Display.

2 Select "Climate".

If the option screen is displayed, select "Front".

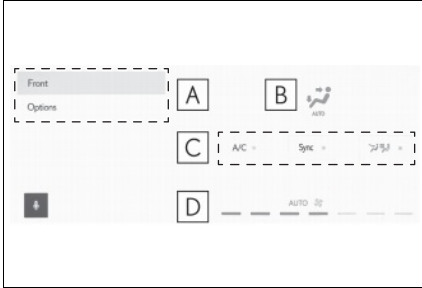

A Sub menu

B Select the air flow mode

C Turn the function on/off

D Fan speed level display

Option screen

Select "Options" on the air conditioning control screen.

The functions can be switched  (on) and  (off).

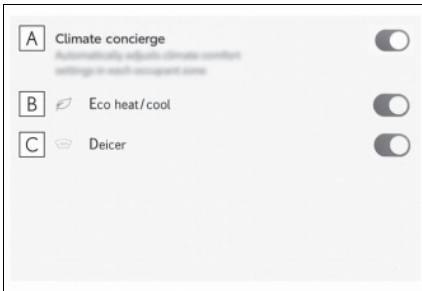

A Set Lexus Climate Concierge (→P.64)

B Set eco air conditioning mode

Air conditioning and heater output is limited to prioritize fuel economy.

C Prevent ice from building up on the windshield and wiper blades (Windshield wiper de-icer) (if equipped)

Using automatic mode

1 Press the automatic mode switch.

2 Adjust the temperature setting.

3 To stop the operation, press the off switch.

Starting Voice Control

Voice control can be started by any of the following operations:

■ Press the talk switch

- 1 Press the [] switch (talk switch) on the steering wheel.

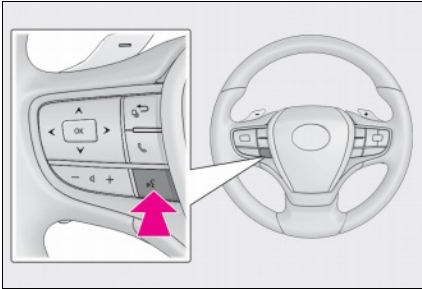

■ Say the wake word

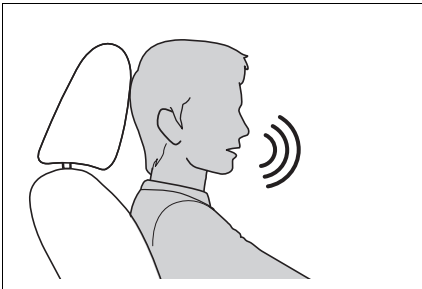

- 1 Say "Hey Lexus".

- The wake word can be turned on or off.
- The wake word can be used and then immediately issue a voice command.
Example: "Hey Lexus" "Take me to an Italian restaurant."

■ Touch the microphone button



- 1 Touch [] or [] on the screen.

Function list

The following tables list frequently used commands for each function category.

- The functions available may vary according to the system installed.
- Items with "Subscription" will require Intelligent Assistant functionality.

■ Common

Action	Example voice command	Subscription
Shows list of general commands	"Help"	No
Stops the current conversation and re-starts at the beginning	"Start over"	No
Cancels the Intelligent Assistant system	"Cancel"	No

■ Navigation

Intelligent Assistant system enables navigation voice search. This allows you with variety of features such as searching a point of interest (POI), navigate to an address as well as discovering new POIs.

Function	Example voice command	Subscription
Destination search	"Take me to <location category/business name>" "Take me to <an Italian restaurant>" "Take me to <address>" "Take me to <6565 Headquarters drive Plano TX>" "Take me home" "Take me to work"	Yes
Map control	"Map zoom in" "Map zoom out"	Yes
Route information	"Cancel trip"	Yes
Telematics	"Call Destination Assist"	No

■ Multimedia control

Allows you to engage in a dialog with the Intelligent Assistant to complete various multimedia tasks via voice input.

Function	Example voice command	Subscription
Radio	"Tune to 99.5 FM" "Tune to Rock on FM" "Tune to channel 2 on SiriusXM"	No
Media	"Mute audio" "Next" "Previous"	No
Media Streaming	"Play <artist/album/song/genre/playlist>" "Play Frank Sinatra"	Yes

■ Hands-free phone operation

Allows you to engage in a dialog with the Intelligent Assistant to complete various tasks via voice input, such as making a phone call to a contact, or calling destination assist.

Function	Example voice command	Subscription
Phone call	"Call John Smith" "Dial 0123456789" "Call back" "Redial"	No
Message	"Send message to John Smith" "Read message"	No

■ Screen display switching

Allows you to easily change to various function screen by voice.

Function	Example voice command	Subscription
Navigation	"Show map"	Yes
Phone	"Show recent calls"	No
Multimedia	"Show the FM station list"	No
Settings	"Show display settings"	No

■ Vehicle device control

Allows you to easily change a vehicle setting or activate a function by voice.

Function	Example voice command	Subscription
Climate	"Turn on the air conditioner" "Set the temperature to <70> degrees" "Turn the fan speed up"	No

■ Notifications

Offers notifications based on user preferences, vehicle geolocation and learned behavior. Each service can be set to On/Off from the Lexus app.

Function	Detail	Subscription
POI suggestion (Navigation)	<ul style="list-style-type: none">● A POI shared through a smartphone app● Parking suggestions near destination	Yes
Low fuel (Navigation)	Automatically notifies user of low fuel level. If applicable, provides POI list nearby (ahead) or along route and allows user to select and navigate by touch.	Yes

Connecting to the USB Port

Connect a device such as smartphone or portable player.

- 1 Open the console box and connect the USB cable to the port.

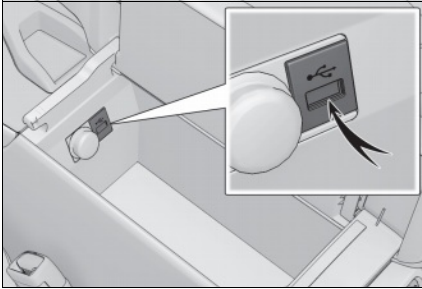

When connecting a USB flash drive, connect it directly to the USB port.

Garage Door Opener (if equipped)

The garage door opener can be programmed using the HomeLink[®] to operate garage doors, gates, entry doors, door locks, home lighting systems, security systems, and other devices.

System components

The HomeLink[®] wireless control system in your vehicle has 3 buttons which can be programmed to operate 3 different devices. Refer to the programming methods on the following pages to determine the method which is appropriate for the device.

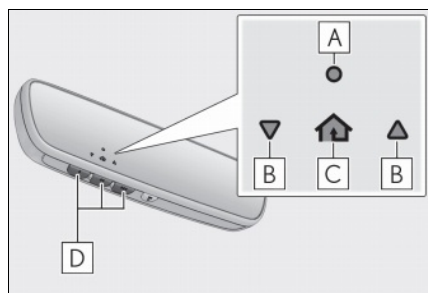

A HomeLink[®] indicator light

B Garage door operation indicators

C HomeLink[®] icon

Illuminates while HomeLink[®] is operating.

D Buttons

■ Before programming HomeLink[®]

- During programming, it is possible that garage doors, gates, or other devices may operate. For this reason, make sure that people and objects are clear of the garage door or other devices to prevent injury or other potential harm.
- It is recommended that a new battery be placed in the remote control transmitter for more accurate programming.
- Garage door opener motors manufactured after 1995 may be equipped with rolling code protection. If this is the case, you may need a stepladder or other sturdy, safe device to reach the “Learn” or “Smart” button on the garage door opener motor

■ HomeLink® programming procedure

The programming procedures can also be found at the following URL.

Website: www.homelink.com/lexus



The word “QR Code” is registered trademark of DENSO WAVE INCORPORATED in Japan and other countries.

For support, contact customer support at the following.

Help Line: 1-800-355-3515

■ Programming HomeLink®

Steps **1** through **3** must be performed within 60 seconds, otherwise the indicator light will stop flashing and programming will not be able to be completed.

- 1** Press and release the HomeLink® button you want to program and check that the HomeLink® indicator light flashes (orange).

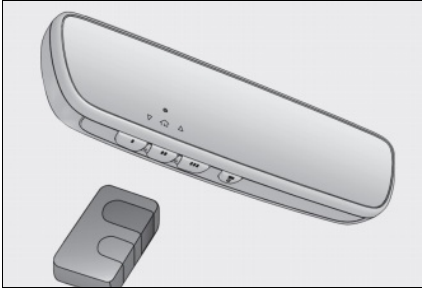

- 2** Point the remote control transmitter for the device at the rear view mirror, 1 to 3 in. (25 to 75 mm) from the HomeLink® buttons.

Keep the HomeLink® indicator light in view while programming.

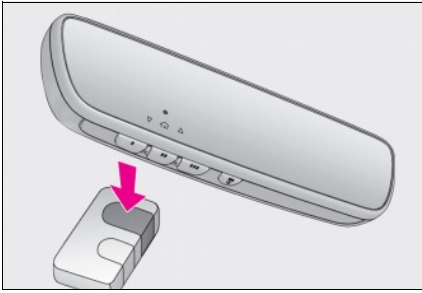

- 3** Program a device.

► Programming a device other than an entry gate (for U.S.A. owners)

Press and hold the remote control transmitter button until the HomeLink® indicator light changes from slowly flashing orange to rapidly flashing green (rolling code) or continuously lit green (fixed code), then release the button.

► Programming an entry gate (for U.S.A. owners)/Programming a device in the Canadian market

Press and release the remote control transmitter button at 2 second intervals, repeatedly, until the HomeLink® indicator light changes from slowly flashing (orange) to rapidly flashing (green) (rolling code) or continuously lit (green) (fixed code).

- 4 Test the HomeLink[®] operation by pressing the newly programmed button and observing the indicator light:
 - Indicator light illuminates: Programming of a fixed code device has completed. The garage door or other device should operate when a HomeLink[®] button is pressed and released.
 - Indicator light flashes rapidly: The garage door opener motor or other device is equipped with a rolling code. To complete programming, firmly press and hold the HomeLink[®] button for 2 seconds then release it.
 - If the garage door or other device does not operate, proceed to “Programming a rolling code system”.
- 5 Repeat the steps above to program another device for any of the remaining HomeLink[®] buttons.

■ Programming a rolling code system

2 or more people may be necessary to complete rolling code programming.

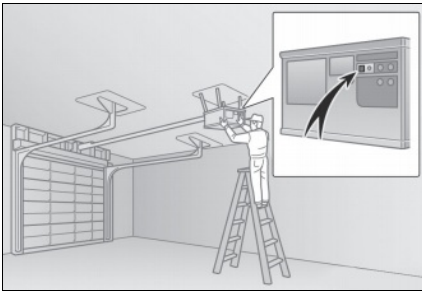

- 1 Locate the “Learn” or “Smart” button on the garage door opener motor in the garage.
This button can usually be found where the hanging antenna wire is attached to the unit. The name and color of the button may vary by manufacturer. Refer to the owner’s manual supplied with the garage door opener motor for details.

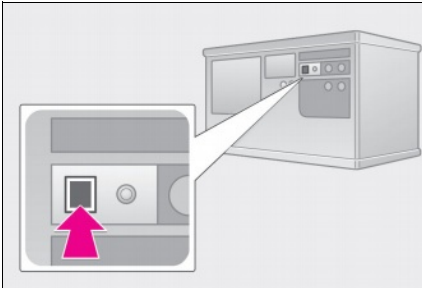

- 2 Press and release the “Learn” or “Smart” button.
Perform 3 within 30 seconds after performing 2.

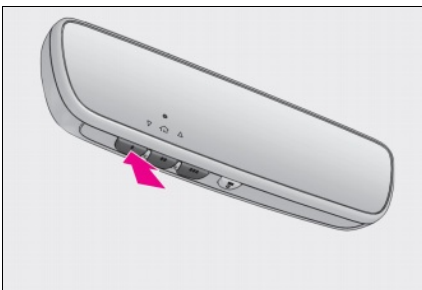

- 3 Press and hold the desired HomeLink[®] button (inside the vehicle) for 2 seconds and release it. Repeat this sequence (press/hold/release) up to 3 times to complete programming.
If the garage door opener motor operates when the HomeLink[®] button is pressed, the garage door opener motor recognizes the HomeLink[®] signal.

■ Enabling 2-way communication with a garage door (only available for compatible devices)

When enabled, 2-way communication allows you to check the status of the opening and closing of a garage door through indicators in your vehicle.

2-way communication is only available if the garage door opener motor used is a compatible device. (To check device compatibility, refer to www.homelink.com.)

- 1 Within 5 seconds after programming the garage door opener has been completed, if the garage door opener motor is trained to HomeLink[®], both garage door operation indicators will flash rapidly (green) and the light on the garage door opener motor will blink twice, indicating that 2-way communication is enabled.

If the indicators do not flash, perform **2** and **3** within the first 10 presses of the HomeLink[®] button after programming has been completed.

- 2 Press a programmed HomeLink[®] button to operate a garage door.
- 3 Within 1 minute of pressing the HomeLink[®] button, after the garage door operation has stopped, press the “Learn” or “Smart” button on the garage door opener motor. Within 5 seconds of the establishment of 2-way communication with the garage door opener, both garage door operation indicators in the vehicle will flash rapidly (green) and the light on the garage door opener motor will blink twice, indicating that 2-way communication is enabled.

■ Reprogramming a single HomeLink[®] button

When the following procedure is performed, buttons which already have devices registered to them can be overwritten:

- 1 With one hand, press and hold the desired HomeLink[®] button.
- 2 When the HomeLink[®] indicator starts flashing (orange), continue to hold the HomeLink[®] button and perform “Programming HomeLink[®]” **1** (it takes 20 seconds for the HomeLink[®] indicator to start flashing).

Operating HomeLink[®]

Press the appropriate HomeLink[®] button. The HomeLink[®] indicator light should turn on.

The status of the opening and closing of a garage door is shown by the indicators.

Safety Connect (if equipped)

Safety Connect is a subscription-based telematics service that uses Global Positioning System (GPS) data and embedded cellular technology to provide safety and security features to subscribers. Safety Connect is supported by Lexus' designated response center, which operates 24 hours per day, 7 days per week.

Safety Connect service is available by subscription on select, telematics hardware-equipped vehicles.

By using the Safety Connect service, you are agreeing to be bound by the Connected Services Terms of Use, as in effect and amended from time to time, a current copy of which is available at Lexus.com. All use of the Safety Connect service is subject to such then-applicable Terms and Conditions.

System components

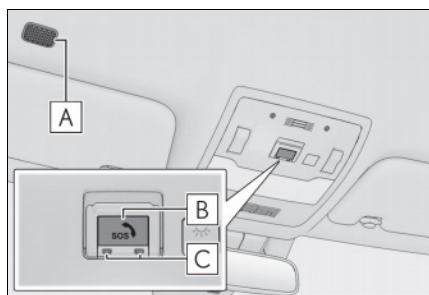

- A** Microphone
- B** "SOS" button
- C** LED light indicators

Services

Subscribers have the following Safety Connect services available:

- **Automatic Collision Notification**

In case of either airbag deployment or severe rear-end collision, the system is designed to automatically call the response center. The responding agent receives the vehicle's location and attempts to speak with the vehicle occupants to assess the level of emergency. If the occupants are unable to communicate, the agent automatically treats the call as an emergency, contacts the nearest emergency services provider to describe the situation, and requests that assistance be sent to the location.

- **Stolen Vehicle Location**

If your vehicle is stolen, Safety Connect can work with local authorities to assist them in locating and recovering the vehicle. After filing a police report, call the Safety Connect response center at 1-800-25-LEXUS (1-800-255-3987) in the United States, 1-877-539-8777 in Puerto Rico or 1-800-265-3987 in Canada, and follow the prompts for Safety Connect to initiate this service.

In addition to assisting law enforcement with recovery of a stolen vehicle, Safety-Connect-equipped vehicle location data may, under certain circumstances, be shared with third parties to locate your vehicle. Further information is available at Lexus.com.

- **Emergency Assistance Button (“SOS”)**

In the event of an emergency on the road, push the “SOS” button to reach the Safety Connect response center. The answering agent will determine your vehicle’s location, assess the emergency, and dispatch the necessary assistance required.

If you accidentally press the “SOS” button, tell the response-center agent that you are not experiencing an emergency.

- **Enhanced Roadside Assistance**

Enhanced Roadside Assistance adds GPS data to the already included warranty-based Lexus roadside service.

Subscribers can press the “SOS” button to reach a Safety Connect response-center agent, who can help with a wide range of needs, such as: towing, flat tire, fuel delivery, etc. For a description of the Roadside Assistance services and their limitations, please see the Safety Connect Terms and Conditions, which are available at Lexus.com.

Subscription

After you have signed the Telematics Subscription Service Agreement and are enrolled, you can begin receiving services.

A variety of subscription terms is available for purchase. Contact your Lexus dealer, call the following or push the “SOS” button in your vehicle for further subscription details.

- **The United States**

1-800-25-LEXUS (1-800-255-3987)

- **Canada**

1-800-26-LEXUS (1-800-265-3987)

- **Puerto Rico**

1-877-539-8777

Remote Connect (if equipped)

The functionality of Remote Connect and Service Connect are made possible by the use of a DCM and a smartphone.

For details about these services, refer to www.lexus.com (U.S.A.), www.lexus.ca (Canada) or www.lexus.mx (Mexico).

Remote Connect subscription

Remote Connect is a smartphone application that lets you view and remotely control certain aspects of your vehicle.

■ Availability of function

This function is not made available in some countries or areas.

Service Connect (if equipped)

Service Connect uses DCM to collect and transmit vehicle data that allows Lexus to provide:

- Vehicle Health Report (VHR) (Safety Recalls, Service Campaigns, Current Vehicle Alerts, Required Maintenance, and Vehicle Condition Status)
- Maintenance Notifications
- Vehicle Alert Notifications

■ Availability of function

This function is not made available in some countries or areas.

Door Locks

The vehicle can be locked and unlocked using the entry function, wireless remote control or door lock switches.

For details about the entry function or wireless remote control, refer to P.17, 18.

Unlocking and locking the doors from the inside

■ Door lock switches (to lock/unlock)

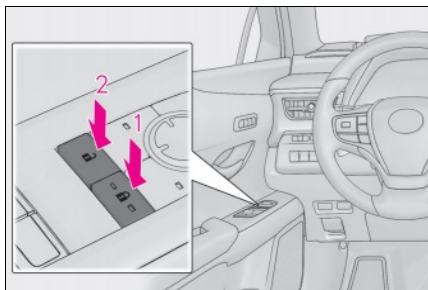

- 1 Locks all the doors
- 2 Unlocks all the doors

■ Inside lock buttons (to lock)

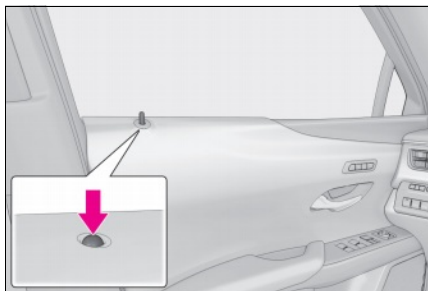

Push down the inside lock button to lock the door.

■ Inside door handles (to unlock)

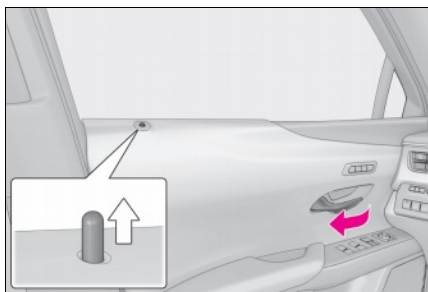

- **For the front doors**
Pull the handle to unlock and open the door.
When the door is unlocked, the inside lock button will pop up.
- **For the rear doors**
Pull the handle to unlock the door. Pull the handle a second time to open the door.
When the door is unlocked, the inside lock button will pop up.

Back Door

Opening the back door from the outside (vehicles without power back door)

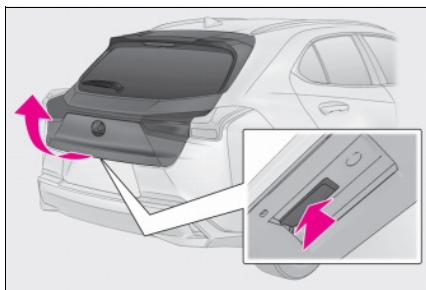

Raise the back door while pressing up the back door opener switch.

Opening/closing the back door (vehicles with power back door)

■ From the inside

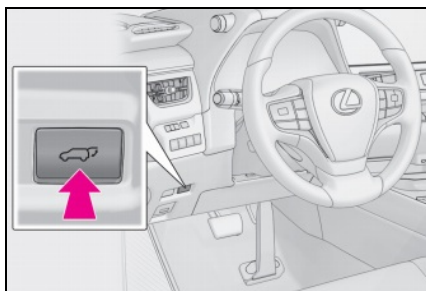

Press the switch for 1 second.

A buzzer sounds and the back door automatically opens and closes.

■ From the outside

▶ Wireless remote control

→ P.17

▶ Power back door switch

● Open

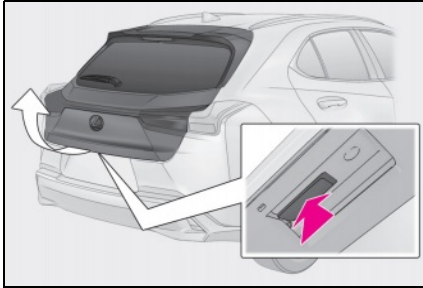

When the back door is unlocked: Press the back door opener switch.

When the back door is locked: While carrying the electronic key on your person, press the back door opener switch.

A buzzer sounds and the back door automatically opens.

Pressing the switch while the back door is opening stops the operation.

● Close

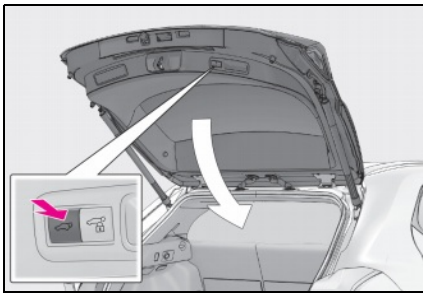

Press the  switch on the lower part of the back door.

A buzzer sounds and the back door automatically closes.

Pressing the  switch while the back door is closing stops the operation.

Pressing the  switch again will open the back door automatically.

● Close the back door and lock all doors after moving away from the back door (close & lock [Walk-Away] function)

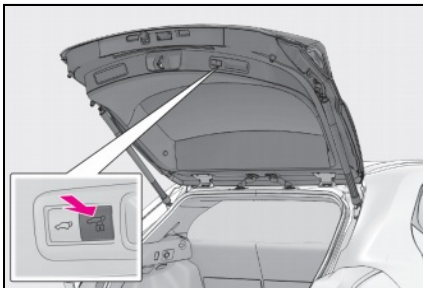

1 Close all of the doors except the back door, carrying an electronic key and press the  switch on the lower part of the back door.

A different buzzer than the normal one will sound and the close & lock (Walk-Away) function will go into standby.

2 While the buzzer is sounding, move away from the back door.

■ Opening/closing the back door using the Hands Free Power Back Door

- 1 While carrying an electronic key, stand within the smart access system with push-button start operation range, approximately 19.7 to 27.6 in. (50 to 70 cm) from the rear bumper.

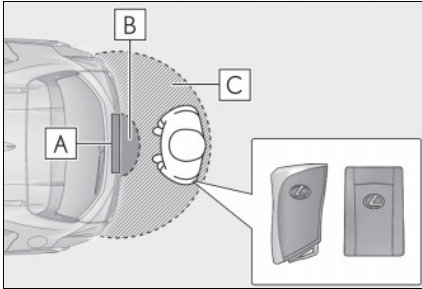

- A** Kick sensor
- B** Hands Free Power Back Door operation detection area
- C** Smart access system with push-button start operation detection area

- 2 Perform a kick operation by moving your foot to within approximately 3.9 in. (10 cm) of the rear bumper, and then pulling your foot back after the buzzer sounds.

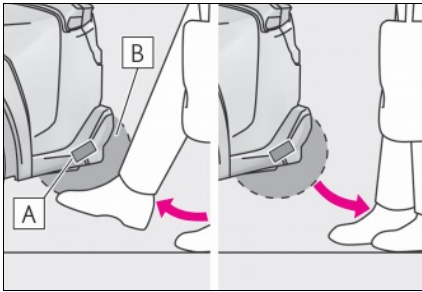

- A** Kick sensor
- B** Hands Free Power Back Door operation detection area

- 3 When the kick sensor detects that your foot is pulled back, a buzzer will sound and the back door will automatically fully open/close.

Fuel Tank Cap

Before refueling the vehicle

- Turn the power switch off and ensure that all the doors and windows are closed.
- Confirm the type of fuel.

Opening the fuel tank cap

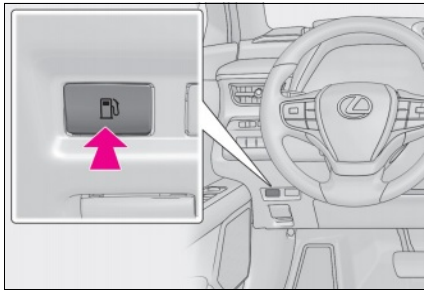

- 1** Press the opener switch.

The fuel filler door will open within about 10 seconds of the switch being pressed. Before refueling is possible, a message will be shown on the multi-information display in the instrument cluster to indicate the progress of the fuel filler door opener.

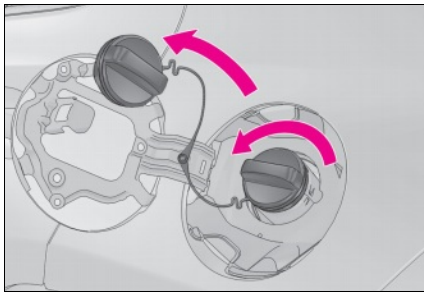

- 2** Turn the fuel tank cap slowly and remove it, then put it into the holder on the fuel filler door.

Closing the fuel tank cap

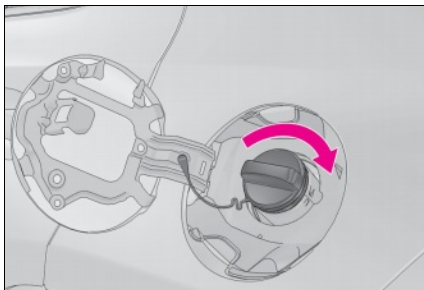

After refueling, turn the fuel tank cap until you hear a click. Once the cap is released, it will turn slightly in the opposite direction.

What to do if...

List of Warning/Indicator Lights

Immediately stop the vehicle in a safe place and contact your Lexus dealer. Continuing to drive the vehicle may be dangerous.

BRAKE

(U.S.A.)

Brake system warning light



(Canada)

(Red)

Immediately stop the vehicle in a safe place and contact your Lexus dealer.



Low engine oil pressure warning light



(U.S.A.)

Malfunction indicator lamp



Charging system warning light



(Canada)

Have the vehicle inspected by your Lexus dealer immediately.



SRS warning light

HOLD

Brake hold operated indicator

(Flashes)

ABS

(U.S.A.)

ABS warning light



Intuitive parking assist OFF indicator



(Canada)



Brake system warning light

(Yellow)



Electric power steering system warning light

(Red or yellow)



Tire pressure warning light

(Blinking and then continuously on)



Slip indicator

For further information, refer to the "OWNER'S MANUAL".

What to do if...

Follow the correction procedures.

PARK

(Flashes)

(U.S.A.)

Parking brake indicator



(Flashes)

(Canada)



(Illuminates without blinking)

Tire pressure warning light*



(Yellow)

LTA indicator



Inappropriate pedal operation warning light



(Yellow)

LDA indicator



Low fuel level warning light



(Yellow)

PDA indicator



Driver's and front passenger's seat belt reminder light



(Yellow)

Cruise control indicator



Rear passengers' seat belt reminder lights (if equipped)



(Yellow)

Dynamic radar cruise control indicator



REAR

Rear passengers' seat belt reminder lights (if equipped)



(Yellow)

Driving assist information indicator



OFF

PCS warning light

Stop and check.



High coolant temperature warning light



Hybrid system overheat warning light

For further information, refer to the "OWNER'S MANUAL".

What to do if...

See the "OWNER'S MANUAL"



Turn signal indicator



(U.S.A.)

Headlight indicator



(Canada)

Tail light indicator



Headlight high beam indicator



AHB indicator



Fog light indicator
(if equipped)



PCS warning light



(White or green)

LTA indicator



(Flashes in yellow)

LTA indicator



(White or green)

LDA indicator



(Flashes in yellow)

LDA indicator



LDA OFF indicator
(if equipped)



(White or green)

PDA indicator



(White or green)

Cruise control indicator



(White or green)

Dynamic radar cruise control indicator



Driving assist information indicator



Outside rear view mirror indicators



Intuitive parking assist OFF indicator



Intuitive parking assist detection indicator



(Flashes)

Slip indicator



VSC OFF indicator





Smart access system with push-button start indicator

For further information, refer to the "OWNER'S MANUAL".

What to do if...

See the "OWNER'S MANUAL"

	"READY" indicator		"AIR BAG ON/OFF" indicator (Canada)
	EV drive mode indicator		
	Parking brake indicator (U.S.A.)		Stop light indicator (if equipped)
	Parking brake indicator (Canada)		Stop light indicator (if equipped)
	Brake hold standby indicator		Eco drive mode indicator
	Brake hold operated indicator		Sport mode indicator (if equipped)
	EV indicator		Sport S mode indicator (if equipped)
	Low outside temperature indicator		Sport S+ mode indicator (if equipped)
	Security indicator		Custom mode indicator (if equipped)
	"AIR BAG ON/OFF" indicator (U.S.A.)		

For further information, refer to the "OWNER'S MANUAL".

*: The tire pressure warning light may come on due to natural causes such as natural air leaks and tire inflation pressure changes caused by temperature. In this case, adjusting the tire inflation pressure will turn off the warning light (after a few minutes). In case the light does not turn off even if the tire inflation pressure is adjusted, have the system checked by your Lexus dealer.

What to do if...

If the electronic key does not operate properly

Locking and unlocking the doors

■ Unlocking the door

Use the mechanical key to perform the following operations.

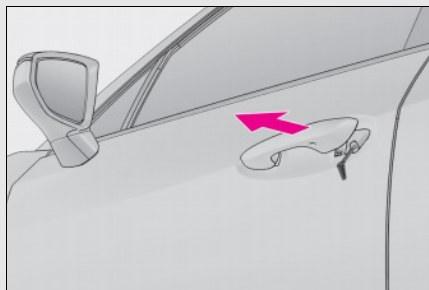

- 1 Insert the mechanical key while pulling on the driver's door handle.

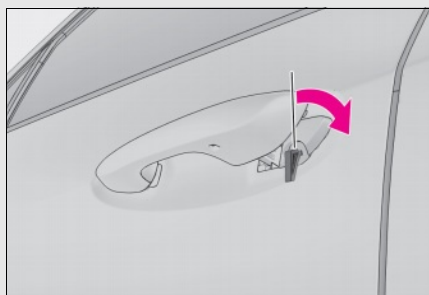

- 2 Unlock the door.

- 3 Remove the key, return the handle, and then pull the handle again.

■ Locking the door

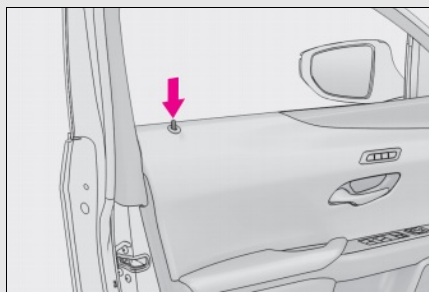

- 1 With the door open, push down the inside lock button.

- 2 Close the door.

What to do if...

Starting the hybrid system

- 1 Ensure that the shift lever is in P and depress the brake pedal.

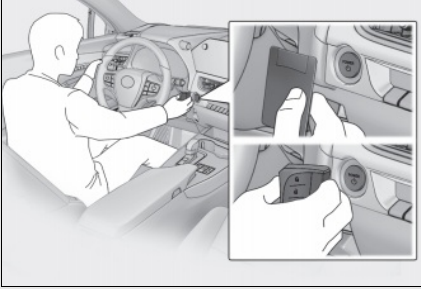

- 2 Touch the Lexus emblem side of the electronic key to the power switch.

When the electronic key is detected, a buzzer sounds and the power switch will turn to ON.

When the smart access system with push-button start is deactivated in customization setting, the power switch will turn to ACC.

- 3 Firmly depress the brake pedal and check that  is shown on the multi-information display.
- 4 Press the power switch.

In the event that the hybrid system still cannot be started, contact your Lexus dealer.

Replace the battery with a new one. For instructions on replacing the battery, refer to the "OWNER'S MANUAL".

If you need further assistance, contact your Lexus dealer.

What to do if...

If the hybrid system will not start

Make sure that the correct operating procedures have been followed.

Brake pedal

Make sure that the brake pedal is firmly depressed when attempting to start the hybrid system. (→P.20)

If the hybrid system still does not start, see the "OWNER'S MANUAL" for more information or contact your Lexus dealer.



Your Lexus dealer

Your Lexus dealer will provide quality maintenance and any other assistance you may require.

If there is not a Lexus dealer near you, please call the following number:

■ U.S. OWNERS

- In the U.S. mainland or Canada:

Lexus Roadside Assistance

1-800-25-LEXUS or 1-800-255-3987 (Toll-Free)

- In Hawaii:

Servco Automotive Roadside Assistance/Customer Services

1-800-25-LEXUS or 1-800-255-3987 (Toll-Free)

■ CANADIAN OWNERS

- In Canada or the U.S. mainland:

Lexus Roadside Assistance/Customer Service

1-800-26-LEXUS or 1-800-265-3987 (Toll-Free)

Please access our **websites** for further information.

- The U.S. mainland: **www.lexus.com**

- Hawaii: **www.servcolexus.com**

- Canada: **www.lexus.ca**

©2024 TOYOTA MOTOR CORPORATION

All rights reserved. This material may not be reproduced or copied, in whole or in part, without the written permission of Toyota Motor Corporation.



Owner's Manual Quick Guide:

Publication No. OM76715U

Part No. 01999-76715

Printed in Japan 01-2401-00 

UX 300h Owner's Manual Quick Guide (北米U)