

WALK THE CUSTOMER THROUGH EACH OF THE FOLLOWING KEY DELIVERY FEATURES

❑ DEFROST – page 14 & 16

- ① Press the front defrost button.
- ② Set to warmest temperature setting.
- ③ Set to highest fan speed.

❑ BLUETOOTH – page 20-21

- Show phone compatibility website:
www.hyundaiusa.com/bluetooth
- Make a test call using Bluetooth with the customer's phone.
- Demonstrate Voice Recognition (VR)



❑ BLUE LINK – page 22-23 (if applicable)

- Assist with creating MyHyundai.com account
- Assist with Blue Link enrollment
- Show Blue Link Users Manual & tear out Voice Commands/Quick Tip Card
- Encourage customers to press the Blue link button  after enrollment to initiate Welcome Call

❑ WINDSHIELD WIPER/WASHER – page 09

- Explain wiper function (int speed, front & rear wipers) and how it may differ from customer's previous vehicle

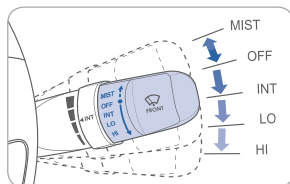

❑ VEHICLE SETTINGS – pages 12-13

- Demonstrate vehicle settings in instrument cluster

❑ CLOCK – page 29

- Demonstrate how to set clock (including daylight savings setting for Navigation equipped vehicles)

❑ READY MODE – page 31

- When the Hybrid system is active, the READY symbol turns on. Even if the gasoline engine is off, you can drive the vehicle

READY

MAINTENANCE

Scheduled Maintenance	Normal Usage		Severe Usage*	
Engine Oil And Filter*	Replace	7,500 or 12 mos	Replace	3,750 or 6 mos
Fuel Additives	Add	7,500 or 12 mos	Inspect	Same As Normal
Tire Rotation	Perform	7,500	Perform	7,500
Air Cleaner Filter	Inspect Replace	7,500 30,000	Inspect Replace	Same As Normal More Frequently
Vacuum Hose	Inspect	7,500	Inspect	Same As Normal
Climate Control Air Filter (For Evaporator And Blower Unit)	Replace	15,000	Replace	More Frequently
Air Conditioning Refrigerant	Inspect	15,000	Inspect	Same As Normal
Brake Hoses & Lines	Inspect	15,000	Inspect	Same As Normal
Drive Shafts & Boots	Inspect	15,000	Inspect	More Frequently
Exhaust Pipe & Muffler	Inspect	15,000	Inspect	Same As Normal
Front Disc Brake/Pads, Calipers & Rotors	Inspect	15,000	Inspect	More Frequently
Rear Brake Disc/Pads	Inspect	15,000	Inspect	More Frequently
Steering Gear Box, Linkage & Boots/ Lower Arm Ball Joint, Upper Arm Ball Joint	Inspect	15,000	Inspect	7,500 or 6 mos
Suspension Mounting Bolts	Inspect	15,000	Inspect	Same As Normal
Brake Fluid	Inspect	30,000	Inspect	Same As Normal
Fuel Filter	Inspect	30,000	Inspect	Same As Normal
Fuel Lines, Fuel Hoses And Connections	Inspect	30,000	Inspect	Same As Normal
Fuel Tank Air Filter	Inspect	30,000	Inspect	Same As Normal
Parking Brake	Inspect	30,000	Inspect	More Frequently
Rear Disc Brake/Pads, Parking Brake	Inspect	30,000	Inspect	More Frequently
Vapor Hose, Fuel Tank & Fuel Filler Cap	Inspect	30,000	Inspect	Same As Normal
Valve Clearance	Inspect	60,000	Inspect	Same As Normal
Spark Plugs (Iridium Coating)	Replace	105,000	Replace	More Frequently
Automatic Transaxle Fluid	No check, No service required		Replace	60,000
Water pump belt	1st Inspect add. Inspect	60,000 or 72 mos 15,000 or 24 mos	Same as normal	
Inverter coolant	1st Replace add. Replace	120,000 or 120 mos 30,000 or 24 mos	Same as normal	
Hybrid Starter Generator (HSG) Belt	Inspect Replace	7,500 or 12 mos 60,000 or 48 mos	Inspect Replace	3,750 or 6 mos 30,000 or 24 mos
Coolant	1st Replace Add Replace	120,000 or 120 mos 30,000 or 24 mos	Same as normal	

*Check the engine oil regularly between recommended oil change. Hyundai recommends Quaker State oil.

*See Owner's Manual for details.

Looking for more detailed information? This Quick Reference Guide does not replace your vehicle's Owner's Manual. If you require additional information or are unsure of a specific issue, you should always refer to the vehicle's Owner's Manual or contact your authorized Hyundai dealer.

The information contained in this Quick Reference Guide was correct at the time of printing; however, specifications and equipment can change without notice. No warranty or guarantee is being extended in this Quick Reference Guide, and Hyundai reserves the right to change product specifications and equipment at any time without incurring obligations. Some vehicles are shown with optional equipment. Specifications apply to U.S. vehicles only. Please contact your Hyundai dealer for current vehicle specifications.

NP150-F2014-B
(Rev 10/20/14)
Printing 10/23/14

HYUNDAI

SONATA HYBRID

Quick Reference Guide



www.hyundai.com

HYUNDAI
NEW THINKING.
NEW POSSIBILITIES.

Roadside Assistance: **1-800-243-7766**
Consumer Affairs: **1-800-633-5151**
XM® Radio: **1-800-967-2346**
Blue Link: **1-855-2BLUELINK**
(1-855-225-8354)

Table of Contents

GETTING STARTED

Engine start /stop button	03
Front seat adjustment	04
Headrest adjustment	05
Remote keyless entry	02
Seat belt adjustment (Front seat)	05
Trunk	03

FEATURES AND CONTROLS

AUX, USB, and iPod® Port	27
Blue Drive mode	34
Central door lock switch	07
Child-protector rear door lock	29
Climate control - Standard	14-15
Climate control - Navigation	16-17
Clock adjustment	29
Cruise control system	18
Driver's main controls	07
ECO guide	31
ECO score	31
Electronic Stability Control (ESC)	30
EV mode	31
Fuel filler door	06
Head lights and fog lights	08
HomeLink wireless control system	11
Hybrid battery vent	35
Hybrid driving tips	33
Hybrid service indicator	31
Hybrid system modes	32
Instrument cluster	12-13
Instrument panel illumination	13
Interior lights	11
Ready mode	31
Rearview camera	28
Seat warmer	28
Service plug	34
Steering wheel adjustments	06
Steering wheel functions	18-19
Sunroof	10
Tire Pressure Monitoring System (TPMS)	30
Trip computer	13
Wiper and washer	09

MULTIMEDIA

Blue Link Telematic system	22-23
Bluetooth operational tips	20
Bluetooth phone pairing	21
Navigation	25-27
Standard Audio	24

*Some vehicles may not be equipped with all the listed features.



Head lights and fog lights
Page 08

Instrument cluster
Pages 12-13

Wiper and washer
Page 09



Blue Link
Pages 22-23

Climate control
Pages 14-17

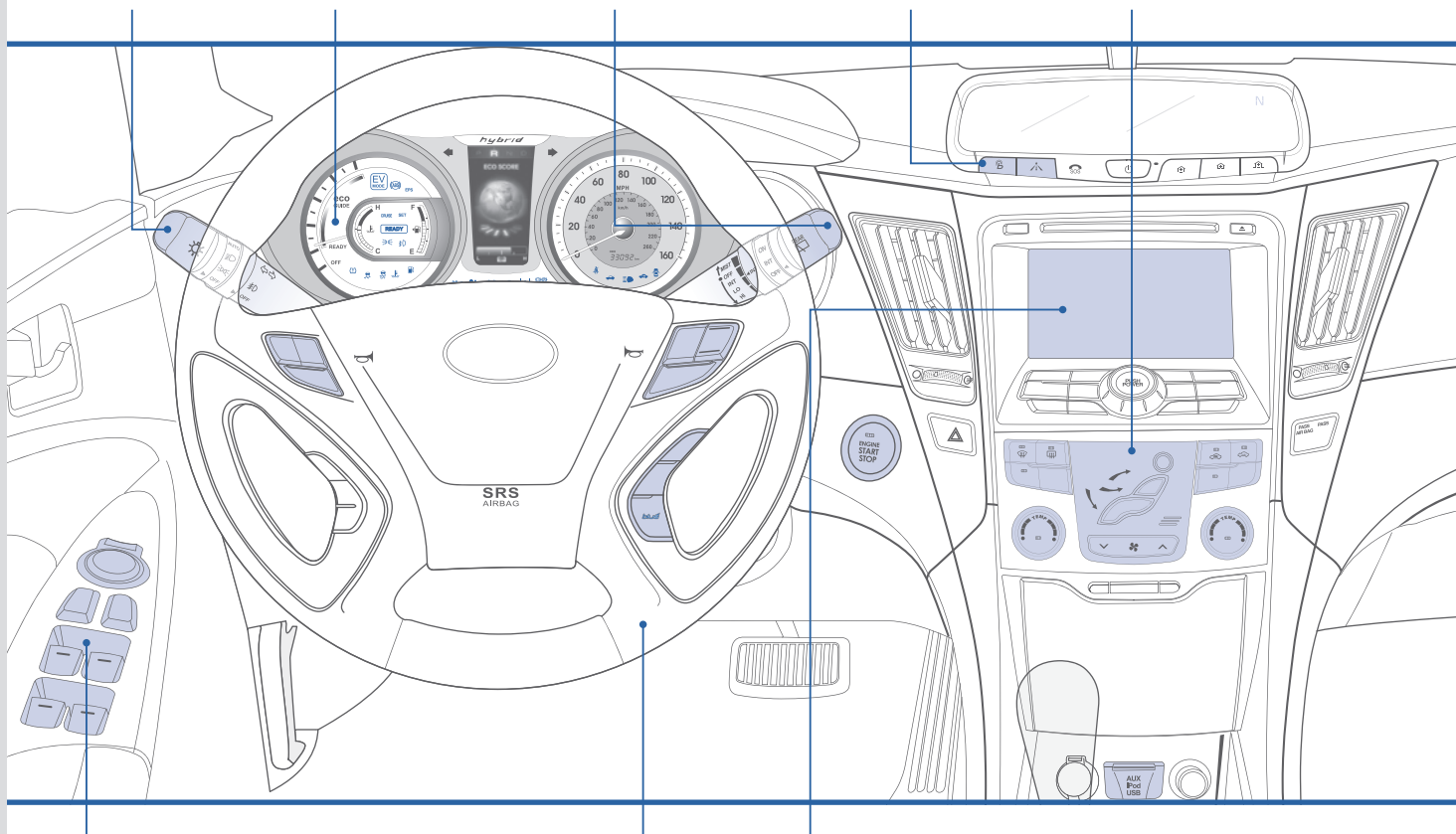

Driver's main controls
Page 07



Central Door Lock



Outside Mirrors

Steering wheel adjustments
Page 06

Audio/Navigation
Pages 24-27



Standard Audio



Navigation Audio



Navigation

FREQUENTLY ASKED QUESTIONS

- Pair phone to your vehicle. Refer to page 21.
- Garage door opener set up. Refer to page 11.
- Getting started with Blue Link. Refer to pages 22-23.

Use this Quick Reference Guide to learn about the features that will enhance your enjoyment of your Hyundai. More detailed information about these features are available in your Owner's Manual.



WARNING!

To reduce the risk of serious injury to yourself and others, read and understand the important SAFETY INFORMATION in your Owner's Manual.

REMOTE KEYLESS ENTRY

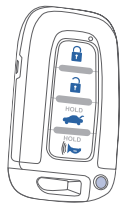
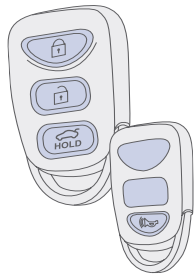

- Lock
- Unlock
- Trunk unlock
- Panic

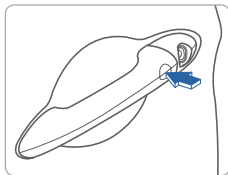

Driver's door Lock/Unlock
Smart key must be within range.

Press:

- Once – Unlock driver door
- Twice – Unlock all doors
- Third – Lock all doors

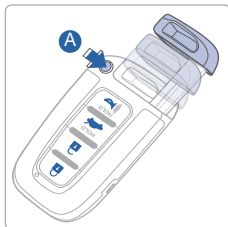

Remove mechanical key

Press and hold the release **A** button and remove the key.

Reinstall mechanical key

Put the key into the hole and push it until a click sound is heard.

TRUNK

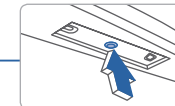
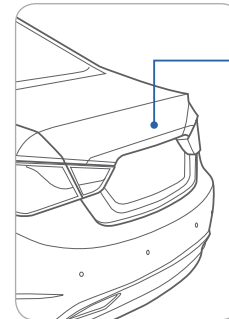

Press to open.
Smart key needs to be within range.



Press and hold to open.

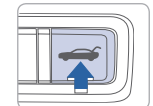

Press the release button in the vehicle.

ENGINE START/STOP BUTTON

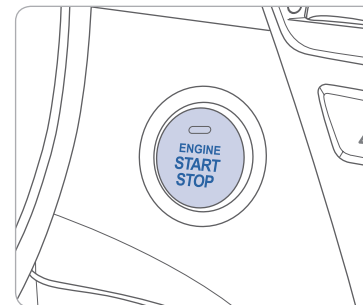

With the ignition OFF, press the engine start/stop button:

- Once for ACC (Accessory) mode.
- Twice for ON mode.
- Three times for OFF.

To start the engine, press the start/stop button while depressing the brake pedal. To shut engine OFF, shift to P (Park) and press the start/stop button.

Emergency situations

Shut off engine while driving:

- Press engine start/stop button for more than 2 seconds or press it 3 times consecutively within 3 seconds.

Restart engine while driving:

- Press engine start/stop button with shift lever in N (Neutral).

GETTING STARTED

FRONT SEAT ADJUSTMENT (MANUAL)

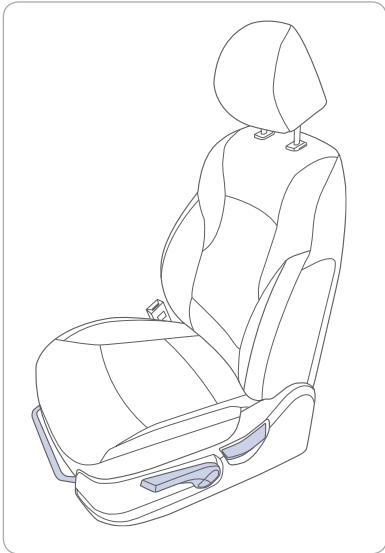

Forward and backward



Seat cushion height (for driver's seat)



Seatback angle



FRONT SEAT ADJUSTMENT (POWER)

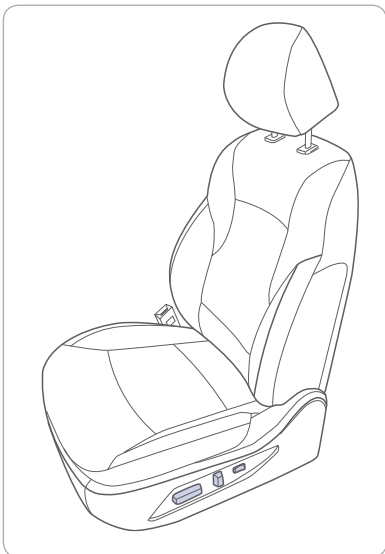

Forward and backward

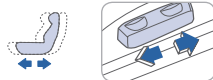

Seat cushion height (for driver's seat)

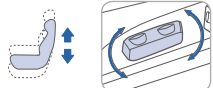

Seatback angle



Lumbar support



HEADREST ADJUSTMENT

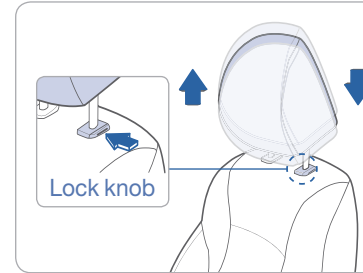

To raise headrest height, pull up on headrest.

To lower headrest, press lock knob while pushing down on headrest.

SEAT BELT ADJUSTMENT (Front seat)

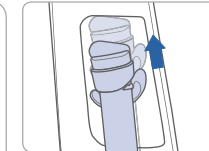
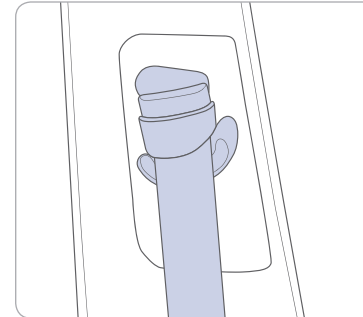

Pull up to raise.

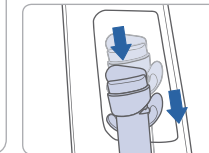

Press button and push down to lower.

STEERING WHEEL ADJUSTMENT

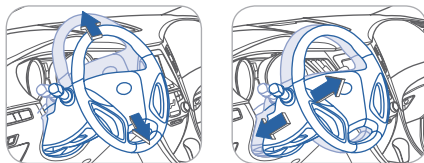
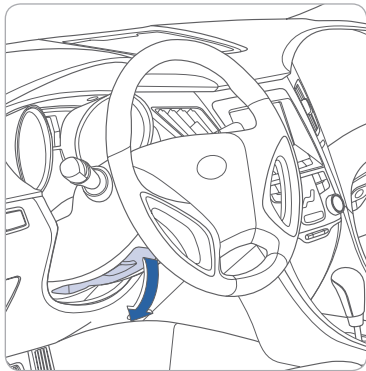

Tilt

Telescopic

CAUTION: Do not adjust while driving.

1. Push the lever downward to release.
2. Set the angle and height.
3. Pull the lever upward to lock in place.

FUEL FILLER DOOR

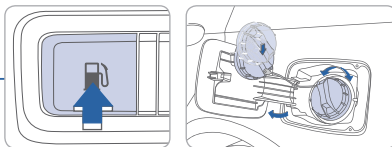
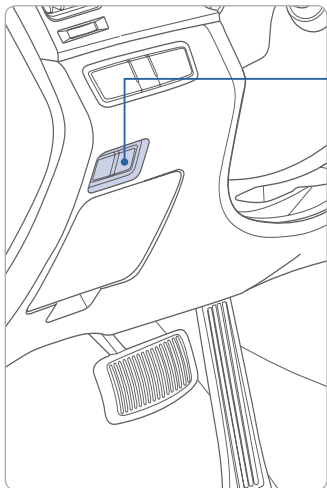

NOTE

After adding fuel, always reinstall the fuel cap onto the filler neck by rotating it clockwise until it clicks one time.

Failure to do this may result in the Check Engine Light () illuminating.

Check the engine oil regularly between recommended oil changes.

DRIVER'S MAIN CONTROLS

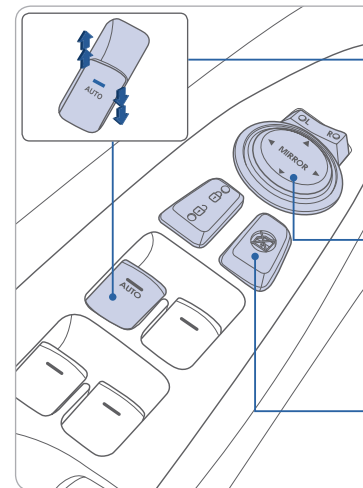

Window Auto down/up (driver's side only)

Press past detent to fully open/close window.



Outside Rearview Mirrors

Press L (left) or R (right) on the switch. Then adjust the mirror by using the directional switch.

Power Window Lock Switch

Disables the power window switches on the passenger doors.

CENTRAL DOOR LOCK SWITCH

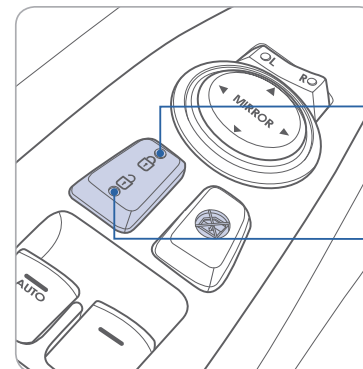

All doors will lock.

All doors will unlock.



FEATURES AND CONTROLS

HEAD LIGHTS AND FOG LIGHTS

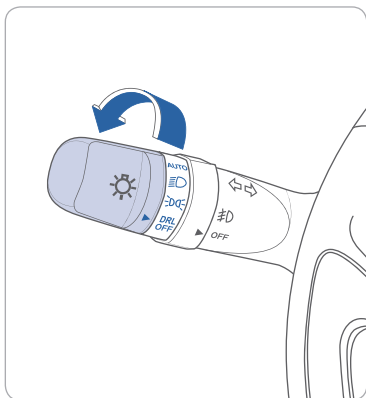

- ▶ **AUTO** Auto light
- ▶ Head light
- ▶ Parking light
- ▶ **DRL OFF** OFF



Escort Function

Head lights may stay on for 30 seconds after exiting and locking vehicle. Press remote lock button twice to turn head lights off.

Turn signals and lane change signals Flashing head lights

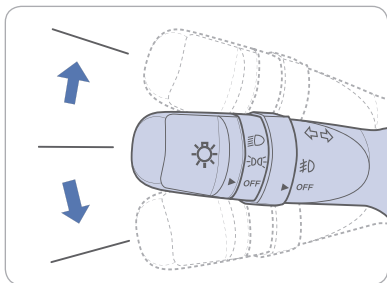

High beam

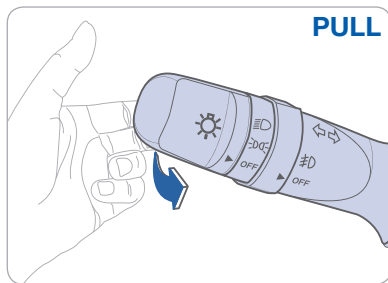

Fog light

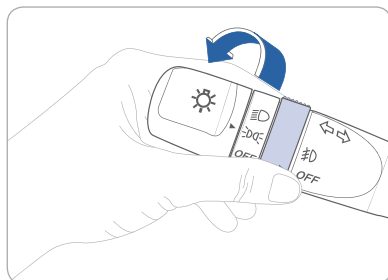
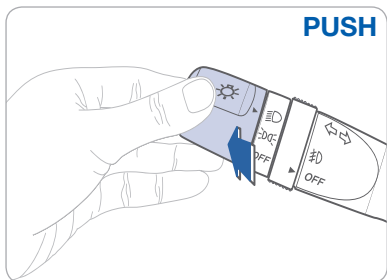

WIPER AND WASHER

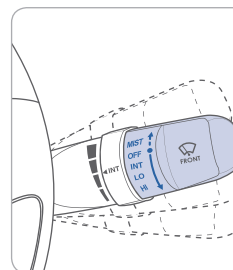

- MIST** - Single wipe
- OFF** - Off
- INT** - Intermittent wipe
- LO** - Normal wiper speed
- HI** - Fast wiper speed



Intermittent wipe time adjustment

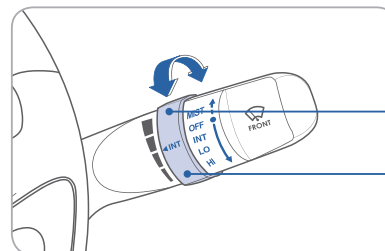

- Fast wiper speed
- Slow wiper speed

Wash with brief wipes

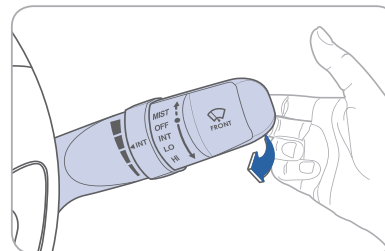

PANORAMA SUNROOF

Sliding the sunroof

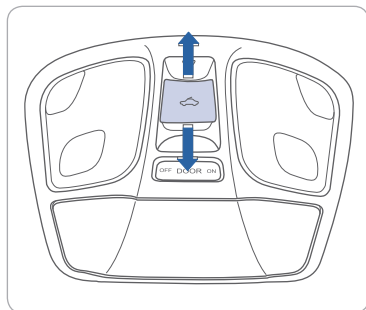

To open with sunshade and sunroof glass closed:

Pull backward
First detent - open sunshade only
Second detent - open both

To close with sunshade and sunroof glass open:

Press forward
First detent - close sunroof glass only
Second detent - close both



Tilting the sunroof

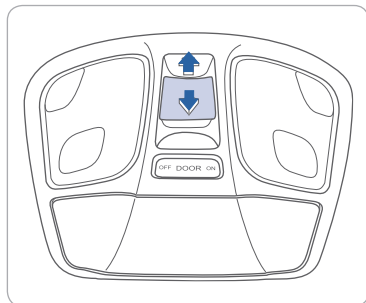

With sunshade and roof glass closed:

To tilt open, press the lever upward.
To close, pull the lever downward.

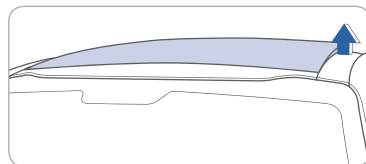

INTERIOR LIGHTS

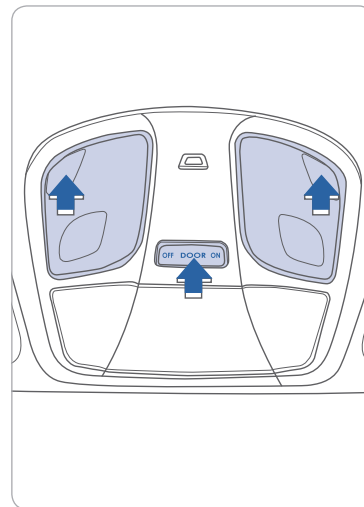

Press the lens to turn the lamp on or off.

ON

Light will turn on.

DOOR

Light will turn on when any door is open except trunk.

OFF

The lights stay off at all times except when individually turned on.

The lights automatically turn off approximately 20 minutes after the ignition switch is turned off or 5 seconds after the system is armed.

HOMELINK WIRELESS CONTROL SYSTEM

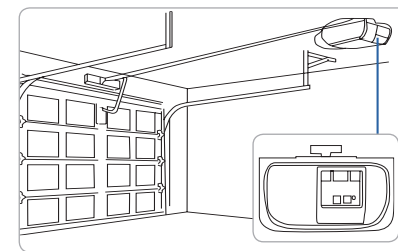
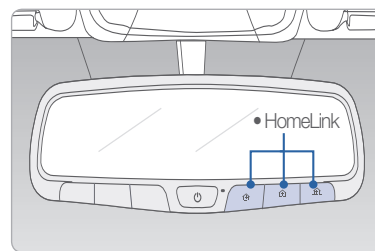

Programming Rolling Code Garage

Press and hold your selected HomeLink button for 20 seconds. Release when light flashes rapidly.

Press and release the "learn" or "smart" button on the garage door opener motor-head unit.
(Note: 30 seconds window to initiate next step.)

Press and hold the desired HomeLink button for 2 seconds and release. Repeat this sequence up to 3 times. If programming is successful, the garage door should open or close during this step.

For detail instructions including "Standard type" garage door, refer to your Owner's Manual or visit www.homelink.com.

FEATURES AND CONTROLS

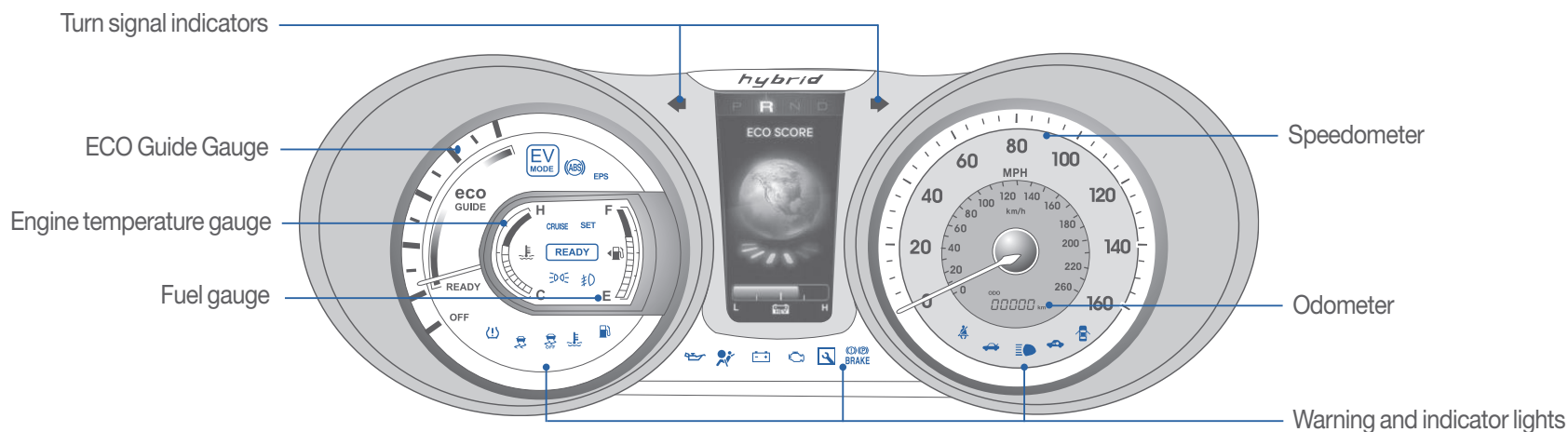

WARNINGS AND INDICATORS

Air bag warning light	Parking brake & Brake fluid warning light	ABS warning light
Seat belt warning light	Low Tire Pressure Indicator / TPMS (Tire Pressure Monitoring System) malfunction indicator	
High beam indicator	Engine oil pressure warning light	Charging system warning light
EPS Electric Power Steering system warning light	Door open position indicator	Turn signal indicator
Immobilizer indicator	Automatic transaxle shift indicator	ESC(Electronic Stability Control) indicator
Trunk open warning light	Low fuel level warning light	Malfunction indicator light
ESC(Electronic Stability Control) OFF indicator	CRUISE Cruise indicator	EV MODE
SET Cruise SET indicator	Front fog light indicator	READY Vehicle ready indicator (vehicle is ready to operate)
Light on indicator	Hybrid Service indicator	eco GUIDE

INSTRUMENT PANEL ILLUMINATION

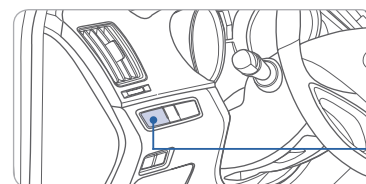

Push button to the left to reduce brightness and push button to the right to increase brightness.



TRIP COMPUTER

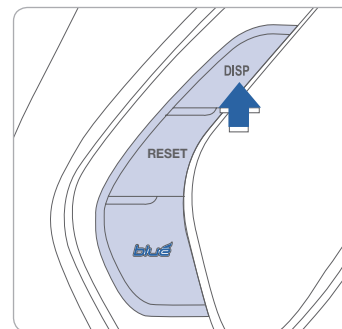

Press the DISP button for less than 1 second to scroll through the displays below:

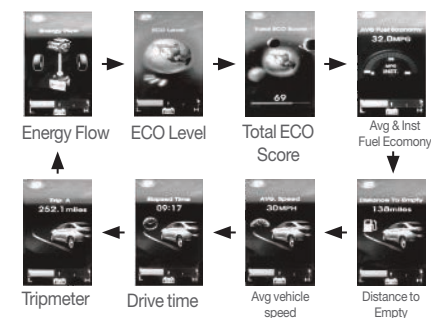

FEATURES AND CONTROLS

CLIMATE CONTROL (STANDARD)

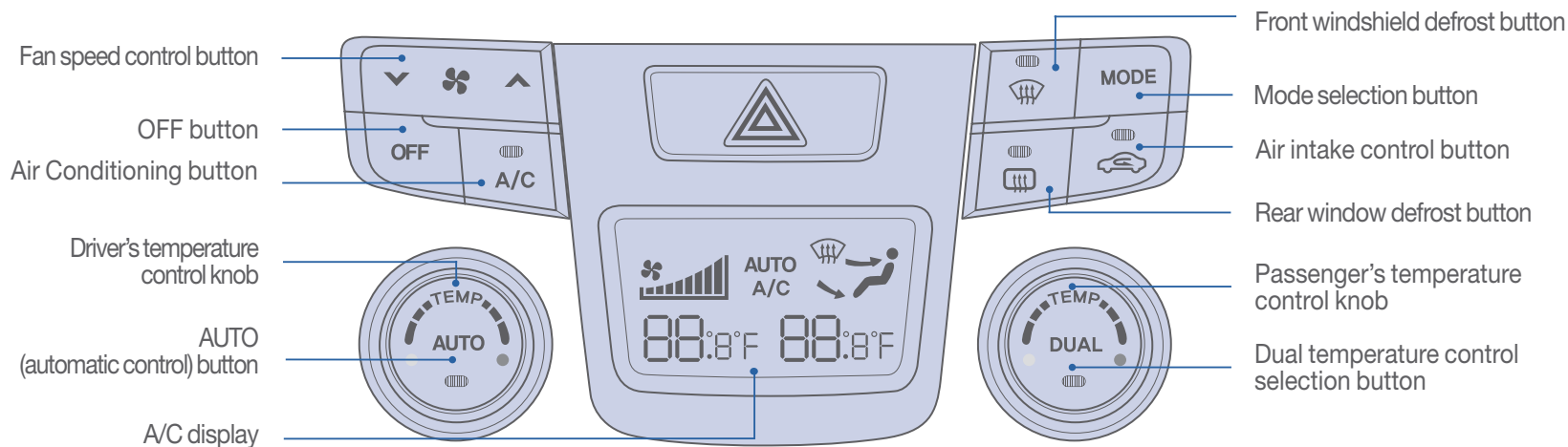

DEFROSTING / DEFOGGING



1. Press the front windshield defrost control.



2. Set the temperature control to the warmest setting.



3. Set the fan speed to the highest setting.

SYSTEM OFF MODE

Pressing the OFF button will place the system in the off mode.

- Front blower will turn off.
- Outside (fresh) air position selected.
- Vented air at last set temperature.

AIR INTAKE CONTROL

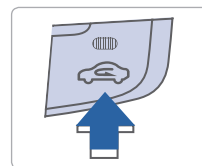

Recirculated air position



Outside (fresh) air position

DUAL BUTTON

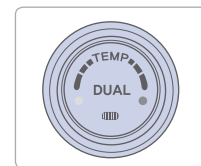

Press the DUAL button to operate the driver and passenger side temperatures individually.

REAR WINDOW DEFROSTER

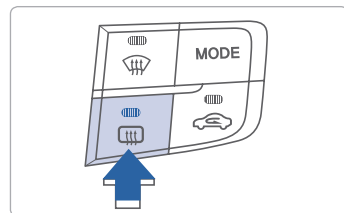

Press to activate/deactivate the rear defroster.

MODE SELECTION

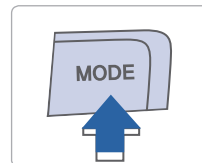

Changing the direction of the air flow as follows.

FEATURES AND CONTROLS

CLIMATE CONTROL (NAVIGATION)

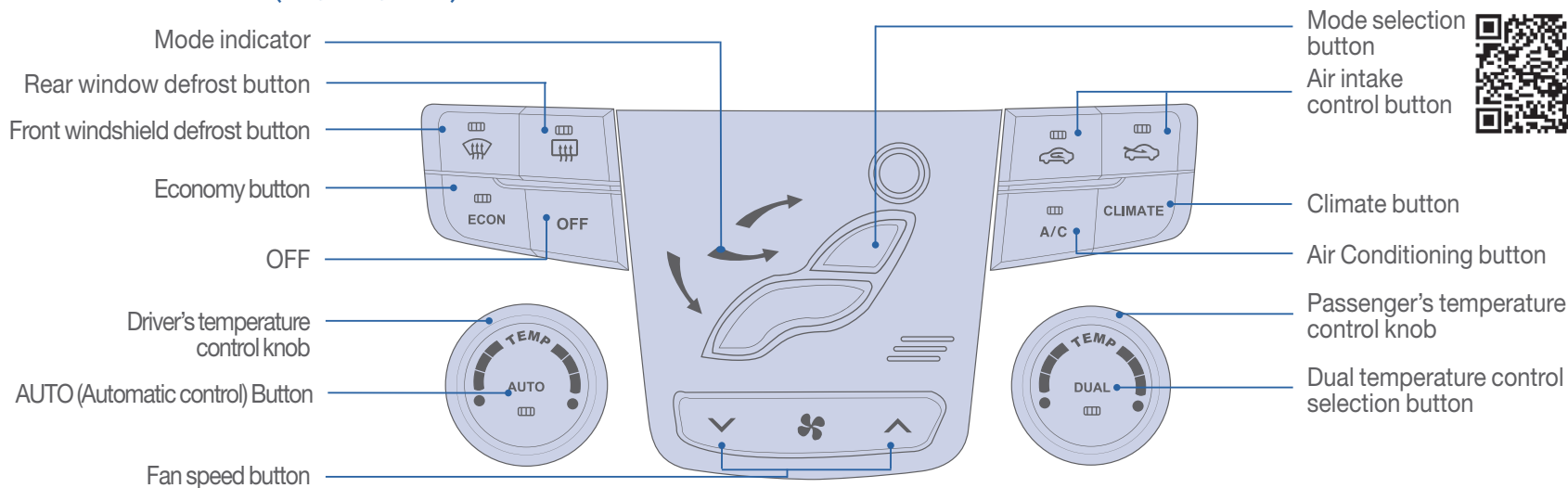

DEFROSTING / DEFOGGING

1. Press the front windshield defrost control.
2. Set the temperature control to the warmest setting.
3. Set the fan speed to the highest setting.

SYSTEM OFF MODE

Pressing the OFF button will place the system in the off mode.

- Front blower will turn off.
- Outside (fresh) air position selected.
- Vented air at last set temperature.

REAR WINDOW DEFROSTER

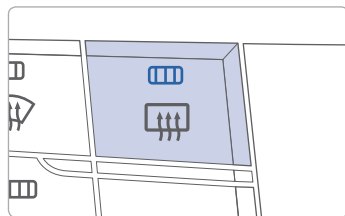

Press to activate/deactivate the rear defroster.

AIR INTAKE CONTROL

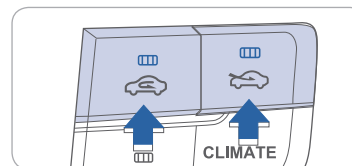

- Recirculated air position
- Outside(fresh) air position

DUAL BUTTON

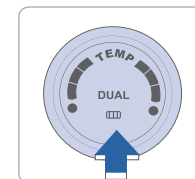

Press the DUAL button to operate the driver and passenger side temperatures individually.

MODE SELECTION



- Floor Level
- Floor & Defrost
- Face Level
- Bi-Level

Changing the direction of the air flow as follows.

STEERING WHEEL FUNCTIONS

Cruise control system

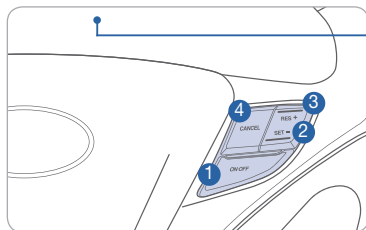

CRUISE

Cruise indicator

SET

Cruise set indicator



To set a cruising speed

1. Press ON/OFF button ① and the CRUISE indicator will illuminate in the instrument cluster. Accelerate to desired cruising speed (above 25 mph).
2. Press SET - button ② and remove your foot from the accelerator pedal.

To accelerate or decelerate

Press RES + button ③ to increase set cruising speed.
Press SET - button ② to decrease set cruising speed.

To cancel cruising speed

Press CANCEL button ④, depress brake pedal, or press ON/OFF button ①.

Audio control

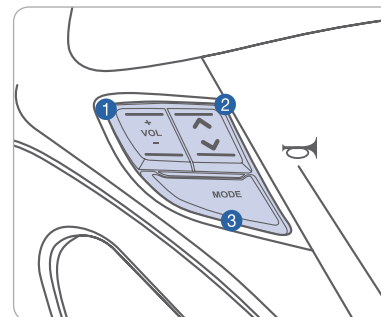

① VOLUME

Raises or lowers speaker volume.

② SEEK/PRESET

Change station

③ MODE

Change the audio source.



Bluetooth control

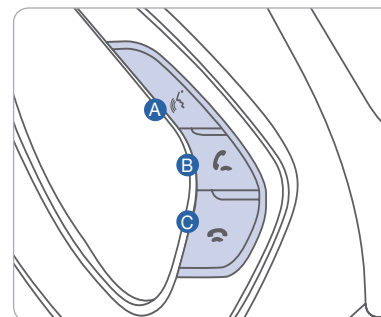

A TALK

Activates voice recognition.

B CALL

Answer, place, and transfer calls.

C END

Ends calls or cancels functions.

BLUETOOTH OPERATIONAL TIPS

In the following situations you or the other party may have difficulty hearing each other:

1. Keep the Bluetooth volume to a low level. High level volume may result in distortion and echo.
2. When driving on a rough road, high speeds and/or with the window open.
3. When the air conditioning vents are facing the microphone and/or when the air conditioning fan is at the max speed.

Steering wheel Bluetooth control

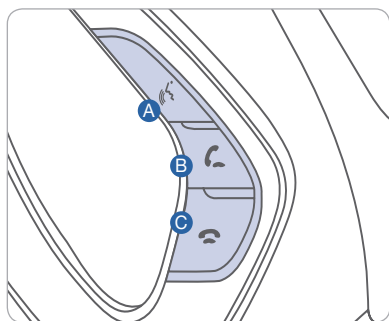

- A TALK**
Activates voice recognition.
- B CALL**
Answer, place, and transfer calls.
- C END**
Ends calls or cancels functions.

VOICE RECOGNITION TIPS

Your vehicle is equipped with Voice Recognition technology which allows drivers to operate their phones without having to take their eyes off the road to minimize distractions.

Voice recognition performance may be affected if driving with windows and sun roof open; when the heating-cooling system is on; when passing in a tunnel or when driving on rugged and uneven roads.

BLUETOOTH PHONE PAIRING

Pairing tutorials, phone compatibility and Operational tips can be found through the Smart QR code using the QR reader application on your Smartphone.



Vehicle must be in Park to complete phone pairing process.

Standard Radio

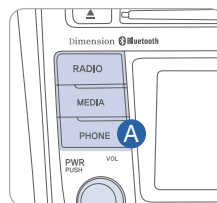

1. Press the PHONE button **A**.
2. Press the PAIR button on the screen.
3. Enable Bluetooth® from your mobile phone. Press OK button from the screen.
4. Select "SONATA" from the device list from your mobile phone. Input passkey displayed on screen when applicable.
5. After pairing is completed, transfer of the contact list to the audio system will begin (if your phone is supported).
6. If your phone prompts a phonebook access request, it is advisable to check box "Always allow" or "Don't ask again".

Navigation Radio

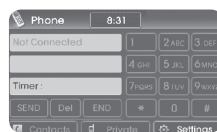
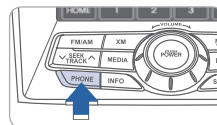

1. Push the PHONE button
2. Press the "Settings" button on the PHONE screen.
3. Press the "Pairings" button on the Settings screen.
4. Press the "Add to" button to pair a new mobile phone.
5. Input the passkey displayed on screen when applicable.
6. Bluetooth connection is successful.
7. If your phone prompts a phonebook access request, it is advisable to check box "Always allow" or "Don't ask again".

Please visit www.hyundaiusa.com/Bluetooth for a list of compatible phones tested to work with Hyundai's Bluetooth® system.

BLUE LINK TELEMATIC SYSTEM

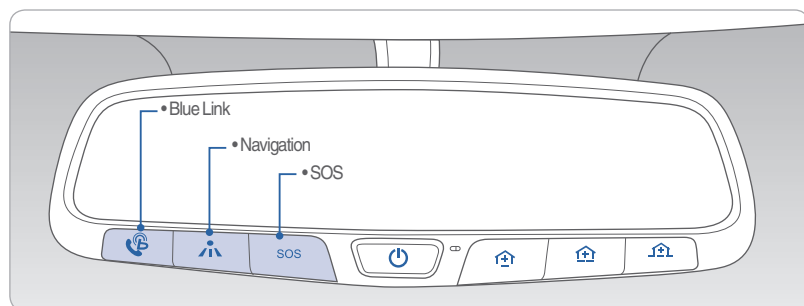



Press the  button for access to the voice-response menu of services.

You have two options:

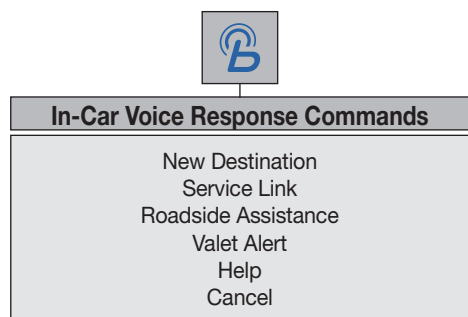
- You can say, "Main Menu" for a listing of main menu choices.
- You can directly select any of the listed menu items by saying its name.



- Press the  button for navigation-related services.
- Press the  button for SOS Emergency Assistance.
- Refer to your Blue Link User's Manual for detailed information on system operation.
- For immediate assistance with subscription services, please call 1-855-2BLUELINK (1-855-225-8354).
- Please register your Blue Link at www.myhyundai.com.

Blue Link feature availability is dependent upon your Blue Link subscription package(s).

Remote Door Unlock/Lock

Blue Link Mobile App



You can download the Blue Link mobile app to your compatible smart phone from the following sites:

- iPhone® — Apple® App Store
- Android® — Google Play

With this feature, you can lock or unlock your vehicle doors from virtually anywhere by using the Blue Link mobile phone app, by dialing the toll-free number, or by using the Blue Link owner's website.

- To use this feature, you must have a Blue Link Personal Identification Number (PIN). To create or change your PIN, log on to www.MyHyundai.com.

To Activate Remote Door Unlock/Lock

- By Blue Link Mobile App: Select DOOR UNLOCK or DOOR LOCK, as desired.
 - Enter your Blue Link PIN.
 - The command to lock or unlock your doors will be sent to your vehicle.
- By phone: Dial toll-free 1-855-2-BLUELINK (1-855-225-8354).
- By web site: Log on to www.MyHyundai.com, select Blue Link.
 - Select Remote Services, then Remote Door Unlock/Lock.
 - Input your Blue Link PIN. (If you need time to get to your vehicle, specify a time delay before your vehicle will be unlocked.)

STANDARD AUDIO

Audio mode

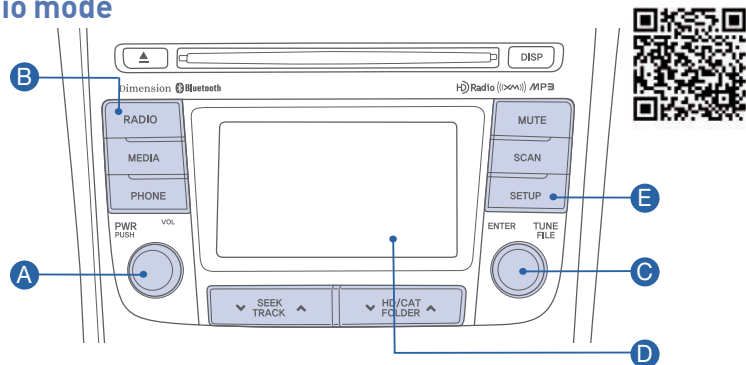

Press **POWER** button **A** to turn radio on.

• TUNING/LISTENING TO CHANNELS

1. Press **RADIO** button **B** to select FM/AM/XM.
2. Press **TUNE** button **C** to desired channel.

NOTE

A clear view of the southern sky is recommended to ensure XM[®] radio reception.

• SETTING PRESET MEMORY BUTTONS (FM/AM/XM[®])

Press and hold any preset button **D** on screen.

• ADJUSTING THE SOUND CONTROL

1. Press the **SETUP** button **E**.
2. Press the "Sound" button on the screen.
3. Press "Sound Setting" button on the screen.

NAVIGATION

Audio mode

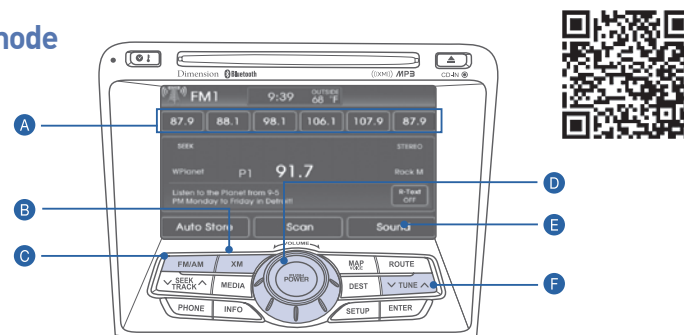

Press **POWER** button **D** to turn radio on.

• TUNING/LISTENING TO CHANNELS

1. Press **FM/AM** **C** or **XM** **B**.
2. Press **TUNE** button **F** to desired channel.

NOTE: A clear view of the southern sky helps to ensure XM[®] radio reception.

• SETTING PRESET MEMORY BUTTONS (FM/AM/XM[®])

Press and hold any preset button (1-6) **A** until an audible beep is heard to store current channel.

• ADJUSTING THE SOUND CONTROL

1. Press **Sound** **E** to enter **SETUP** menu.
2. Press the arrows on the screen to adjust desired sound.

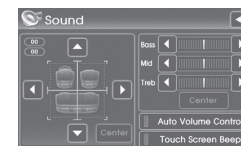

Please refer to your Owner's Manual for more detailed information on how to use your audio system.

Complimentary XM subscription ends three months following the vehicle date of sale. Please contact XM Radio at 1-800-XM-RADIO (1-800-967-2346) to renew your XM subscription.

NAVIGATION

Map position

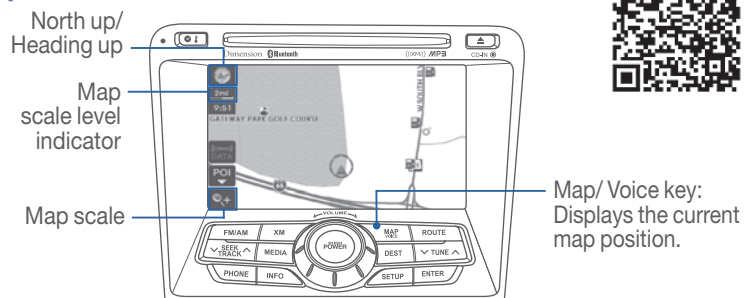

North UP/Heading up.

- Displays the current map mode to reflect the position in reference to the screen. The map mode can be switched between North Up and Heading Up.
- Each time the button is pressed, the screen will switch in the order shown below.
 - Heading Up → North Up → Heading Up →
 - Map Scale: Increases or decreases the map size.
 - Map Scale indicator: shows the scale of the map.
 - Map Voice Key: Activate/deactivate the voice guidance.

Destination menu

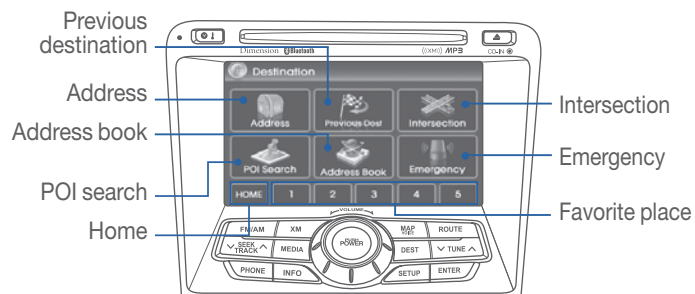

- Previous destination: Sets the destination through the Previous destination list.
- Address: sets the destination through address search.
- POI search: Sets the destination through intersection search.
- HOME: Sets the stores HOME as the destination.
- Intersection: Sets the destination through intersection Search.
- Destination: Sets the destination through the keyboard.
- Emergency: Sets the destination through emergency facilities search.
- Address book: Sets destination through address book Search.
- Favorite Store favorite places.

AUX, USB AND iPod PORT



Use the jack to connect an external audio device and listen to it through the audio system in your vehicle.

NOTE

To operate your iPod® through the vehicle's audio system, a Hyundai adapter cable is required. This cable can only be purchased at your local Hyundai dealer.

iPod® is a trademark of Apple Inc.

FEATURES AND CONTROLS

SEAT WARMER

Front Seat

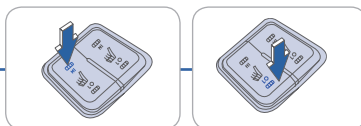
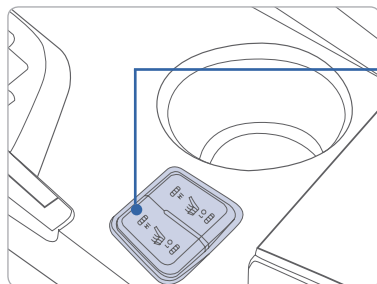

Push desired switch to warm the seat.

- Forward is HI temp
- Backward is LO temp

REARVIEW CAMERA

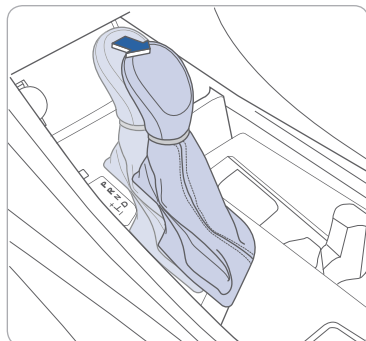

The rearview camera will activate when the ignition switch is ON and the shift lever is in the R (Reverse) position.

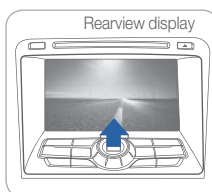

CLOCK ADJUSTMENT

With Standard Radio

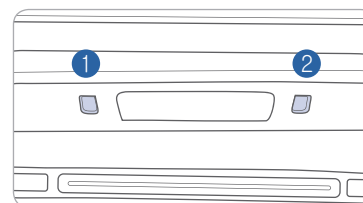

Hour

Press the ① button to adjust the Hour.

Minute

Press the ② button to adjust the Minute.

With Navigation Radio



1. Press and hold button A.

2. Touch the up or down arrows to set the clock.

3. Touch "Done" when finished.

CHILD-PROTECTOR REAR DOOR LOCK

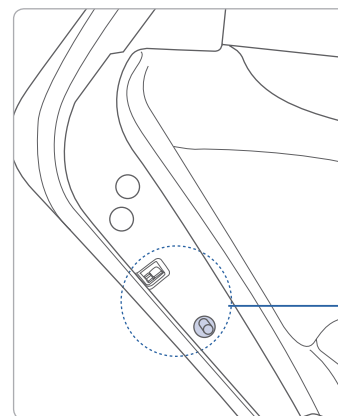

Lock(🔒)

Insert a key into the hole and turn it to the lock (🔒) position.

Unlock(➡)

Allows opening the rear door handle from inside and outside the vehicle.

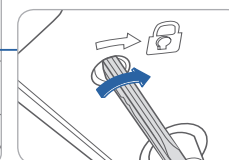

TIRE PRESSURE MONITORING SYSTEM (TPMS)

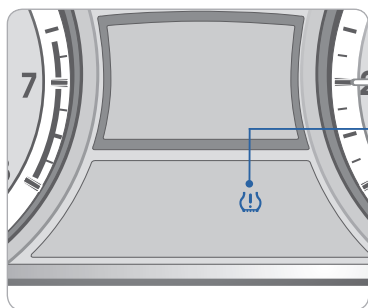

Low Tire Pressure Indicator /
TPMS Malfunction Indicator



LOW TIRE PRESSURE INDICATOR

Illuminates if one or more of your tires is significantly under-inflated.

TPMS MALFUNCTION INDICATOR

Blinks for approximately one minute then remains illuminated if there is a malfunction with the TPMS system. Have the system checked by an authorized Hyundai dealer.

ELECTRONIC STABILITY CONTROL (ESC)

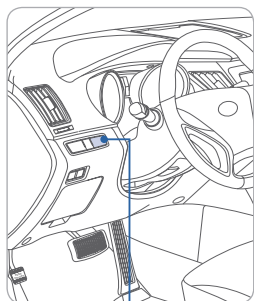

The ESC system is an electronic system designed to help the driver maintain vehicle control under adverse conditions.

- To turn the ESC off, press the ESC OFF button.
- To turn ESC on, press it again.
- ESC system is automatically turned on for every ignition cycle.

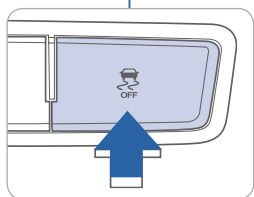

READY MODE

READY

When the Hybrid system is activated, the READY indicator is illuminated. Even if the gasoline engine is off, you can drive the vehicle.

EV MODE



This is an indicator to let drivers know that the vehicle is operating fully in EV Mode (Electric Vehicle Mode)

ECO GUIDE

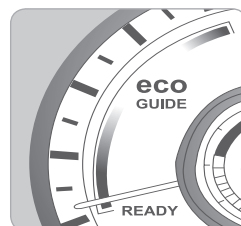

This is an indicator gauge to display ECO driving status.



HYBRID SERVICE INDICATOR



If a problem with the Hybrid System occurs, the service indicator light will illuminate. Have an authorized Hyundai dealer correct the condition as soon as possible.

ECO SCORE



ECO Level

Displays bars awarded for eco-driving.

- 8 bars will earn 1 point towards the Total ECO Score.
- Bars are added or subtracted based on average fuel consumption.

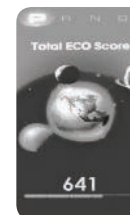

Total ECO Score

Displays cumulative ECO score.

- 200 points will earn 1 planet. (Example: 641 points shown and 3 planets earned)
- Maximum ECO score is 9999.

HYBRID SYSTEM MODES

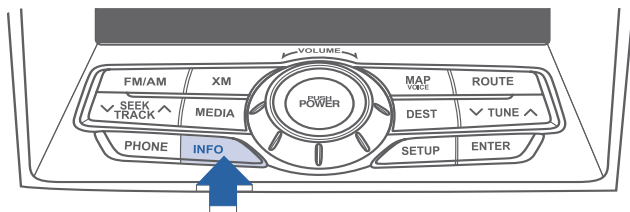

Press the INFO button to select one of the screens.



Earth Mode

This screen displays how the vehicle is driven.

ECO Level - Bars are added or subtracted based on average fuel consumption.



Car Mode

This screen displays if the vehicle is driven economically.

The display will change according to the ECO Level bars.



If a bar is added, the trees in the background will grow and smog will disappear.
If a bar is subtracted, the trees in the background will turn brown and smog is added.



Energy Flow Mode

This screen displays the energy flow from the engine and battery.



Fuel Economy Mode

The graph will add a bar every 2 minutes to display Average Miles Per Gallon.



HYBRID DRIVING TIPS

The following tips may help benefit you to maximizing fuel economy and experience Hybrid driving.

Common practice:

- Check tire pressure
- Roll windows up when driving

- Properly maintain your vehicle
- Turn A/C off

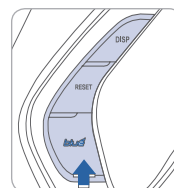

Make sure BLUE mode is on. (page 34)



Set headlight switch to AUTO or OFF when not in use. This will help preserve Hybrid battery charge. (page 08)



Set climate control to ECON mode. (pages 16-17)

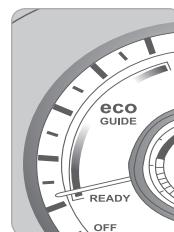

Try to drive in the blue zone on the ECO Guide and maintain EV Mode indicator to illuminate as much as possible. (page 31)

Driving suggestions to improve fuel economy:

- Drive smoothly
- Accelerate at moderate speed
- Try to maintain your speed with traffic to prevent unnecessary speed adjustments.
- Always maintain a safe driving distance from the vehicle in front of you so you can avoid unnecessary braking.

FEATURES AND CONTROLS

BLUE DRIVE MODE

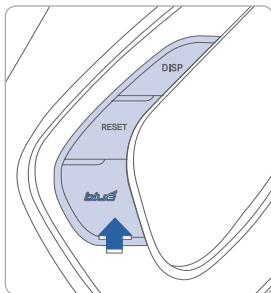

Your vehicle is equipped with highly efficient power train based on Hyundai's Blue Drive technology. This mode is activated automatically each time the vehicle is started.)

If needed, you can temporarily switch ON/OFF by pressing the button on the steering wheel.

ON

This is for normal driving and provides maximum fuel efficiency. The display on the instrument cluster will have a blue glowing background.

OFF

This is intended for brief periods of unusual driving, such as steep roads or hauling heavy loads. The display on the instrument cluster will have a black background.

SERVICE PLUG

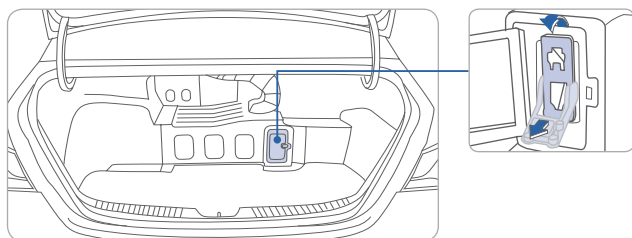

The Service plug is located inside the trunk. This plug should only be serviced or inspected by an authorized Hyundai dealer.

DANGER!

This lever is attached to the Hybrid battery system which contains very high voltage. Do not touch.

HYBRID BATTERY VENT

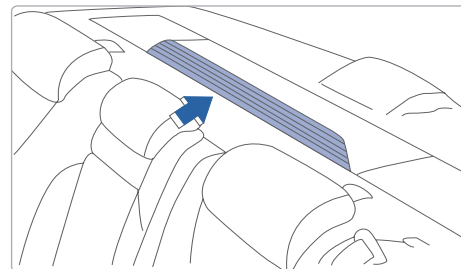

The Hybrid battery air intake vent is located behind the rear seat head rest. Do not cover the air vent or spill liquid.

Key Websites:

- Hyundai website - www.hyundai.com
- Hyundai owner website - www.myhyundai.com
- Bluetooth phone compatibility - www.hyundaiusa.com/bluetooth
- Blue Link - www.hyundaiusa.com/technology/bluelink



MEMO

HYUNDAI OWNER	DEALERSHIP NAME
SALES CONSULTANT	DATE
VIN	PREVIOUS VEHICLE

- ☐ CONFIRM "GOOD BATTERY" USING GR8 AND STAPLE TEST TICKET HERE
- ☐ SET TIRE PRESSURE LF____ RF____ RR____ LR____
- ☐ VERIFY VEHICLE IS CLEAN, IN GOOD CONDITION, FREE OF CHIPS AND SCRATCHES · CLEAN WINDSHIELD AND BACK WINDOW
- ☐ ENSURE FLOORMATS ARE SNAPPED INTO PLACE

Sales Consultant	Date	Sales Manager	Date
Customer			Date
		@	
Email			