

XK

# QUICK START GUIDE

## CONTENTS

Driver controls	2
Vehicle access	3
Convertible top	4
Comfort adjustments	5
Starting and driving	6
Heating and ventilation	10
Audio and Touch screen	11
Navigation	14
Telephone	15
Gas station information	16



Some features may not apply to your vehicle.  
Refer to the Owner's Handbook for full operating instructions.

# DRIVER CONTROLS

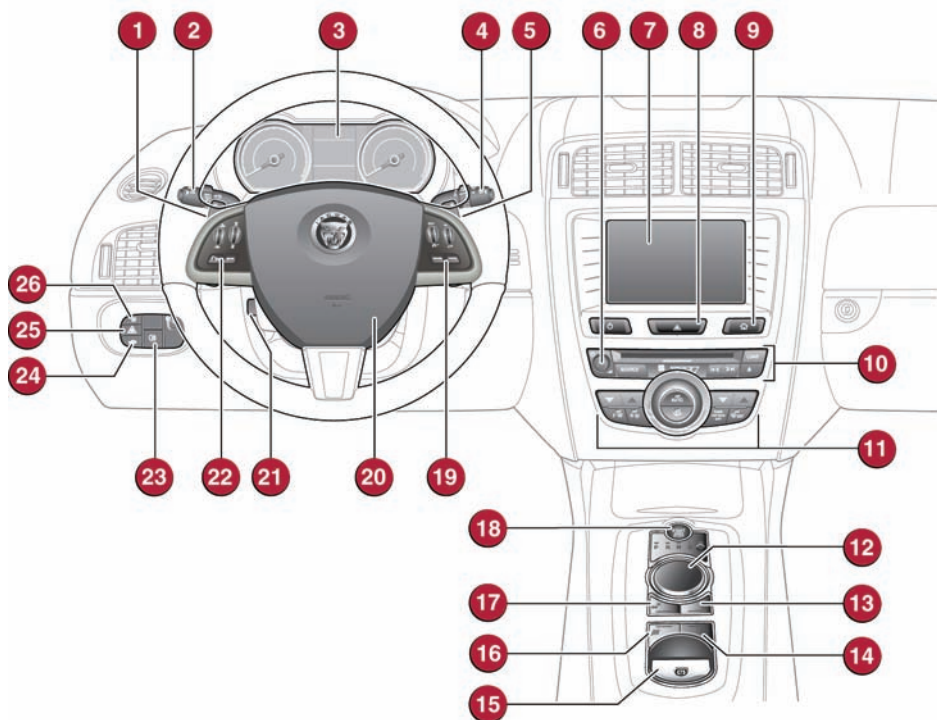

1. Manual gear change paddle (-) down.
2. Headlamps, turn signals, and Trip computer.
3. Instrument panel, warning lamps, Message center, and turn by turn navigation.
4. Wiper/washers.
5. Manual gear change paddle (+) up.
6. Audio on/off.
7. Touch screen on/off.
8. Hazard warning.
9. Home menu.
10. Audio system controls.
11. Climate system controls.
12. Gear selector.
13. Dynamic stability control switch.
14. Automatic speed limiter switch.
15. Electric parking brake.
16. Dynamic mode switch.
17. Winter mode switch.
18. START/STOP.
19. Cruise control switches.
20. Horn/air bag.
21. Steering wheel adjustment.
22. Audio system/telephone controls.
23. Fog lamps on/off.
24. Luggage compartment release.
25. Forward alert.
26. Fuel filler flap release.

# VEHICLE ACCESS

## Smart key



Press once to lock the vehicle and arm only the exterior (perimetric) alarm.



Multi-point entry - Press once to disarm the alarm, unlock both of the doors and unlock the Luggage compartment.

Press and hold to open the windows (Global opening).



Press once to switch the headlamps on for up to 120 seconds. Time delay is set on the lighting control. Press again to switch off.



Press to open only the Luggage compartment. The rest of the security system remains active.



Press and hold for 3 seconds to activate/cancel the panic alarm.

### Unlocking mode alternatives

Single-point entry allows only the driver's door to unlock with a single press. A second press unlocks the other door and the Luggage compartment.

Multi-point entry will unlock both of the doors and the Luggage compartment with a single press.

To change between modes, with the vehicle unlocked, press the lock and unlock buttons simultaneously for 3 seconds. The hazard warning lamps will flash twice to confirm the change.

### Drive-away door locking

When enabled, the Luggage compartment and doors will automatically lock when the vehicle's forward speed exceeds 5 mph (7 km/h). This feature can be disabled/enabled via the Touch screen. From the **Home** screen, select **Vehicle**, then **Veh. settings**, and then **Security**.

## Keyless entry/exit

To unlock the vehicle and disarm the alarm, first make sure that the Smart key is outside of the vehicle but within 3 ft (1 m).

Operate a door handle or the Luggage compartment release button.

To lock the vehicle and arm the alarm, first make sure that the Smart key is outside of the vehicle but within 3 ft (1 m).

Press a door handle button once to lock.

## Emergency key release



1. Release button.
2. Emergency key blade.

Use the blade to lever off the appropriate door lock cover. The cover has a key symbol embossed into it.

Insert the key into the exposed lock, then turn and release it to unlock.

If the security system was previously armed with the Smart key, when the door is unlocked, the alarm will sound. To deactivate the alarm, press the unlock button on the Smart key or press the **START/STOP** button with the Smart key inside the vehicle.

### Keyless start backup

When the Emergency key is used to unlock the vehicle, it will be necessary to use the Keyless start backup to disarm the alarm and start the engine.

1. In the center console, slide open the starter control lid.
2. Insert the Smart key fully into the recess.
3. With the brake pedal applied, press and release the **START/STOP** button to start the engine.

*Note: To remove the Smart key, transmission **P** must be selected and the ignition switched off. Press down on the Smart key and release it. The Smart key will eject out of the recess.*

The Smart key may not be detected if it is placed in a metal container, or if it is shielded by a device with a back-lit LCD screen, (e.g., laptop, smart phone, etc). Keep the Smart key clear of such devices when attempting Keyless entry or Keyless starting.

Do not leave your Smart key in the Luggage compartment, as the vehicle WILL NOT automatically unlock (should it become shielded).

# VEHICLE ACCESS

## Luggage compartment

See page 2, item 24.

### Luggage compartment opening

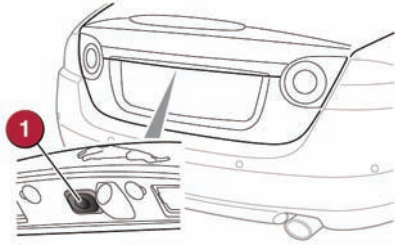

1. Press the release button.



2. Alternatively, press the button on the fascia.

**DO NOT** leave the Smart key inside the Luggage compartment. The vehicle **WILL NOT** automatically unlock if the Smart key is shielded.

## Convertible roof

The vehicle must be stationary with the engine running.

*Note: The luggage separator **MUST** be in the correct position before the roof will retract. See the Owner's Handbook, Convertible roof section.*



1. To open, press and hold the REAR of the switch in the overhead console. An audible chime indicates the start of the opening process. The rear windows will open, the roof will unlatch and start to move, and the front windows will fully lower. When the process is complete, another audible chime will be given.
2. Release the switch.

1. To close, press and hold the FRONT of the switch. Once again, an audible chime will be given. If the windows have been raised, they will lower before the roof moves back into position. When the process is complete, another audible chime will be given.
2. Release the switch.

### Convertible roof operation

**DO NOT** press the engine **START/STOP** button while the roof is operating. Doing so will cause the system to lose its position memory.

**DO NOT** open the Luggage compartment while the roof is operating. This will cause the operation to stop.

**DO NOT** operate the top while the vehicle is in motion. Doing so may damage the convertible top and/or its operating mechanism.

# COMFORT ADJUSTMENTS

## Setting the driving position

### Driver's seat

Set the seat position using the following controls on the door panel:

1. Cushion length.
2. Lumbar support.
3. Seatback angle.
4. Side bolster adjustment.
5. Seat forwards and back, cushion height and cushion angle.

*Note:* Seat heating and cooling controls are accessed via the Touch screen.

### Storing the driving position to memory

When the driver's seat, steering wheel and door mirrors are adjusted to the required position, the settings can be stored.

Press the **M** button to activate the memory store function. The red LED will illuminate.

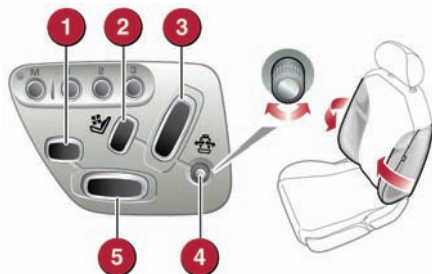

Press button **1**, **2**, or **3**, within 5 seconds, to store the current driving position to the chosen number. The LED will extinguish and a chime will sound.

Use a stored memory position by pressing the required memory button. The seat, steering wheel and mirrors will move to their preset positions.

## Steering wheel position

See page 2, item 21.

1. With the vehicle stationary, turn the rotary control to the **COLUMN** position.
2. With the toggle control, adjust the height and reach of the steering wheel to the required driving position.

### Exit mode

When the rotary control is set to **AUTO** and the driver's door is opened, the steering wheel will move up to provide greater clearance for exiting. The steering wheel will remain in this position until the driver's door is closed and the ignition is turned on.

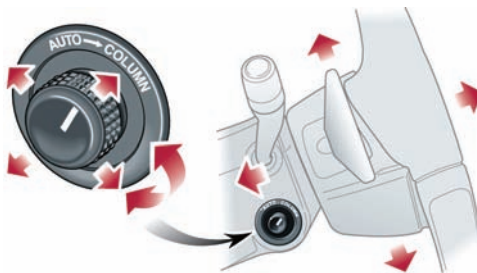

## Door mirror positions

1. Press the left or right mirror selector.
2. Use the mirror adjuster to set the mirror's position.

### Mirror dip when reversing

Reverse dip can be enabled or disabled via the Touch screen. From the **Home** screen, select **Vehicle**, then **Veh. settings**, and then **Parking**.

### Powerfold mirrors

1. Press both buttons simultaneously to fold the mirrors inward. Press again to unfold. The mirrors can be programmed to unfold/fold automatically at vehicle unlock/lock. See your Owner's Handbook.

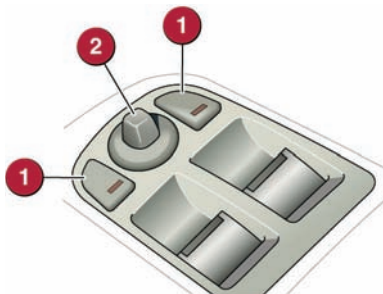

# STARTING AND DRIVING

## Engine start/stop

See page 2, item 18.

### Ignition only on

1. With the Smart key inside the vehicle, press the **START/STOP** button once to switch on the ignition.
2. A second press will switch off the ignition.

### Engine start

- The transmission must be in either **P** or **N** position to enable engine starting.
1. With the brake pedal pressed firmly, press and release the **START/STOP** button to start the engine.
  2. Press again to stop the engine and switch off the ignition.

### Rolling start

If the engine is switched off while the vehicle is moving, it can be restarted after 2 seconds have elapsed. Select transmission **N** position and then press the **START/STOP** button.

### Smart key use

The engine will continue to run, even if the Smart key is removed from the vehicle. However, if the engine is stopped, it cannot be restarted until the Smart key is returned to the vehicle.

## Warning and information lamps

Displayed in the Instrument panel. **DO NOT** ignore warning lamps.



Parking brake applied, system fault or brake fluid low. USA only.



Parking brake applied, system fault or brake fluid low. Canada only.



Anti-lock braking system fault. USA only.



Anti-lock braking system fault. Canada only.



Engine malfunction



Low tire pressure



Seat belt reminder.



Automatic speed limiter active.



Dynamic stability control fault. Flashes when DSC is operating.



Dynamic stability control switched off, TracDSC on.



Air bag fault.



Rear fog lamp on.



Forward alert active.



Adaptive cruise control active.

## Electric parking brake (EPB)

See page 2, item 15.

### Applying

1. With the vehicle stationary, lift up the EPB switch and then release it. The red warning lamp in the Instrument panel will illuminate.

### Releasing

1. With the ignition on, apply the brake pedal and press down on the EPB switch.
2. If the vehicle is stationary with the EPB applied and either transmission **D** or **R** is selected, pressing the accelerator will automatically release the EPB.

- The EPB is automatically released when the transmission is moved from the **P** position.



Note: **DO NOT** use the EPB recess as a storage area.

# STARTING AND DRIVING

## Transmission

See page 2, items 1, 5 and 12.

Apply the brake pedal, then rotate the gear selector from the **P** position. Maintain brake pressure until a gear is selected.

Select transmission **P** before switching off the engine. However, if the engine is switched off with **R**, **D** or **S** selected, the selector will automatically return to **P** while retracting.



### Operating note

If the engine is switched off with **N** selected, automatic selection of **P** is delayed for 10 minutes. **DO NOT** use this feature to enable towing of the vehicle. Refer to **Vehicle recovery** in the Owner's Handbook.

## Sport mode

When selected, automatic gear change points are modified to make full use of engine power.

Press the selector down and rotate from **D** to **S**.

## Manual gear changes

Manual gear change mode is effective when rapid acceleration and engine braking are required.

- To shift down, briefly pull the left (downshift) paddle.

- To shift up, briefly pull the right (upshift) paddle.



When the paddles are used while in transmission **D** position, gear selection will revert to automatic if use of the paddles is not maintained. With **S** selected, continuous manual operation is initiated if the paddles are used.

### Return to automatic operation

To return to automatic operation, pull and hold the right (upshift) paddle for 2 seconds or rotate the gear selector from **S** to **D** position.

## Auto headlamps and wipers

See page 2, items 2 and 4.

### Auto headlamps

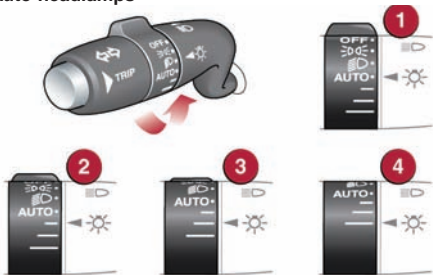

1. When **AUTO** position is selected, the side lamps and headlamps will turn on automatically as ambient light falls below a preset level.
2. 3. 4. The headlamps can temporarily illuminate the way ahead when exiting the car at night. Rotate the control for delay periods of 30, 60, or 120 seconds. Use the Smart key headlamp button to turn the headlamps on or off.

### Auto wipers

For automatic wipe, activated by the Rain sensor, move the wiper control up to the first position. Sensitivity can be adjusted by rotating the collar.

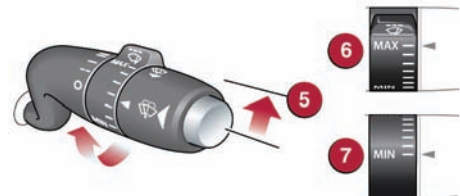

5. First stop for the Auto position.
6. Rain sensor maximum sensitivity.
7. Rain sensor minimum sensitivity.

Before entering an automatic car wash, turn the wipers off to deactivate the Rain sensor. Otherwise, the wipers will operate during the washing process and may be damaged.

# STARTING AND DRIVING

## Cruise control and Forward alert

See page 2, item 19 and 25.

### Setting the cruise control speed



1. Use to set the cruise speed or to increase/decrease speed while Cruise control is operating.
2. Resumes the set speed after a cancellation.
3. Press to cancel but retain the set speed in memory.

Cruise control will also cancel if the brake pedal is pressed or if the vehicle's speed falls below 18 mph (30 km/h).

### Adaptive cruise control (ACC)

This enhancement uses a front mounted radar to monitor traffic ahead. ACC can be programmed to maintain a set gap to the vehicle ahead. When a vehicle ahead enters the same lane as you, or, if the vehicle ahead is traveling slower than the set speed, your vehicle will automatically slow down and then maintain the set gap until the road ahead clears. At that point, your vehicle will accelerate to the set speed.

### ACC gap setting

4. Press to decrease or increase the set gap to the vehicle ahead. There are 4 gap settings to choose from.



When ACC is active, the amber warning lamp will illuminate in the Instrument panel. The Message center will display the current set gap.

Set speeds are cleared at ignition switch off.

ACC IS NOT a collision warning or avoidance system. Additionally the system WILL NOT detect:

- Stationary or slow moving vehicles below 6 mph (10 km/h).
- Pedestrians or objects in the roadway.
- Oncoming vehicles in the same lane.

### Forward alert

Forward alert is an additional feature of ACC and provides limited detection of objects in the road ahead. When necessary, it will give an audible warning plus the Message center warning, **FORWARD ALERT**. The driver must take appropriate action.

1. Press to activate the Forward alert function.



The Forward alert amber warning lamp will illuminate in the Instrument panel.

Sensitivity of detection can be adjusted. With ACC disengaged, use the ACC gap setting control 4 to select one of 4 sensitivity settings. The Message center will confirm the selected setting.

## Restraints and air bags



A warning indicator in the Instrument panel will illuminate as a warning if the driver's and/or front passenger's seat belt is unbuckled.

Dependent on specification, this may be accompanied by a warning chime.

### Child seats

It is important to remember that your child's weight, rather than age, determines the type of seat that is required. Refer to **Child Seats** in the Owner's Handbook to determine the correct seat for your child.

The front passenger seat occupancy sensor determines the state of seat occupancy and sets the air bag status to suit:

- Seat unoccupied - air bag deactivated and indicator off.
- Seat occupied - air bag activated and indicator off.
- Low weight occupant or object - air bag deactivated and indicator on.





# STARTING AND DRIVING

## Rear camera and Parking aids

### Rear camera



Activates when transmission **R** is selected. The Touch screen will display guidance lines to aid reversing. When a forward gear is selected and the vehicle's speed is greater than 10 mph (16 km/h), the Rear camera will deactivate.

The Rear camera view has priority over the Parking aid view. To display the Parking aid view instead, touch the screen.

*Note: Sensors may activate when water, snow, or ice is detected on their surfaces. Make sure that the sensors are cleaned regularly.*

### Parking aids

When transmission **R** is selected, Parking aids at the rear and front will activate.



The Touch screen will display a representation of the vehicle and indicate any obstruction detected. A colored bar will show the approximate distance from the vehicle to the obstruction.

An audible alert is also triggered and will increase in frequency as the obstruction is approached.

When moving forward into a space, enable the sensors with the Parking aid switch. Alternatively, first select **Reverse** then **Drive**.

Audible alert volume can be adjusted via the Touch screen. From the **Home** screen, select **Vehicle**, then **Syst. settings**. Now select **Vol.presets** and adjust the volume as required.

Parking aids will cancel when the vehicle's forward speed exceeds 10 mph (16 km/h).

### Parking aids switch

To activate the front sensors manually, press the Parking aid switch in the overhead panel.

1. Press to disable the Parking aid. Press again to enable.



The switch LED illuminates whenever the system is on.

### Canceling the parking aid screen

Touch the screen to return to the previous view.

## Garage door opener

1. The buttons in the roof console can be programmed to transmit radio frequencies that can operate external devices, such as, garage doors, entry gates, security systems, etc.

See the Owner's Handbook for full operating instructions.



# HEATING AND VENTILATION

## Heating and ventilation

See page 2, item 11.

### Primary controls

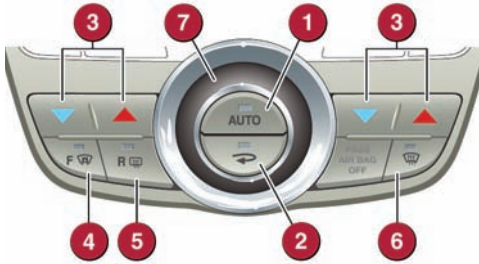

- 1. AUTO.** This is the recommended operating mode. Automatically adjusts the air conditioning, blower speed, air intake, and airflow distribution, to maintain the selected temperature(s). Helps to prevent screen fogging.
- 2. Recirculation.** Helps to prevent fumes from entering.
- 3. Temperature control.** Temperature is displayed on the Touch screen. Press the red buttons to increase temperature. Temperatures in the separate passenger and driver zones will automatically synchronize if HI or LO is selected via the driver's side control.
- 4. Heated windshield.** The heaters will operate only when the engine is running.
- 5. Heated rear screen.** The rear screen heater button also controls the door mirror heaters.
- 6. Windshield defrost/demist.** Press to remove frost or heavy fogging from the windshield. To deselect defrost mode, press the **DEF** or **AUTO** buttons.
- 7. Blower speed.** Rotate to adjust the airflow speed through the vents.

### Operating note

Seat heating and ventilating will operate only while the engine is running. This is to prevent the battery becoming discharged.

### External water deposits

The system removes moisture from the air and deposits the excess water beneath the vehicle. This is normal and is no cause for concern.

### Touch screen controls

Touch **Climate** on the **Home** menu.

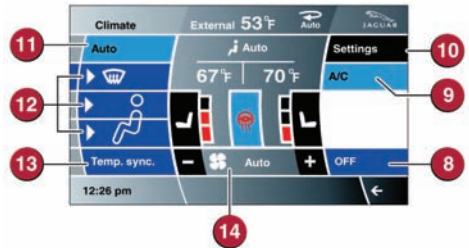

- 8. OFF.** Select to turn climate on/off.
- 9. A/C.** Select for economy mode. Turns off the air conditioning compressor.
- 10. Settings.** Use to personalize zone settings. Also gives access to the automatic air recirculation sensor control setting.
- 11. AUTO.** This is the recommended operating mode. Automatically adjusts the air conditioning, blower speed, air intake, and airflow distribution, to maintain the selected temperature(s). Helps to prevent screen fogging.
- 12. Air distribution to the windshield, face and feet.**
- 13. Temp. sync.** Synchronizes all of the temperature settings to match the driver's settings.
- 14. Blower speed.** Touch the + or - symbols to increase or decrease the blower speed. Blower speed is automatically set in **Auto** mode. Adjusting the blower speed will cancel **Auto** mode.

# AUDIO AND TOUCH SCREEN

## Home menu

See page 2, items 6, and 7.

The Touch screen requires only light touches. Excess pressure could result in damage.

### Operating note

Always run the engine during prolonged use of the Touch screen. This is to prevent the battery becoming discharged.



1. Press to switch the Audio system on/off. Rotate to adjust the volume.
2. Press repeatedly for Touch screen on/off and screen saver options.
3. Press repeatedly for the available audio sources.
4. Touch to display the **Audio** menu. Select any of the audio sources, set personal preferences, and store stations to presets.
5. Seek down and seek up buttons for the previous/next radio station preset, or the previous/next CD/MP3 track. Hold to enter manual radio seek mode or to skip back through the current audio source track.
6. Eject CD. Hold to eject all of the CDs.
7. Load CDs. Follow the screen instructions.
8. Displays the **Home** menu.

## Steering wheel audio control

See page 2, item 22.

1. Audio volume.
2. Scroll through preset radio stations, CD tracks, or music folders. Roll and release repeatedly to select the next/previous radio station or audio source track.
3. Audio mute/unmute or activate Voice control.
4. Scroll through the available audio sources.

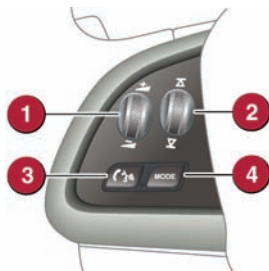

## Radio

Turn on the Audio system. On the Touch screen **Home** menu, touch the **Audio** option. The last used audio source controls will be displayed. If an audio source other than radio is displayed, select **AM/FM**.

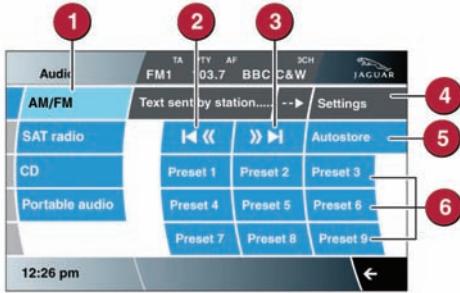

1. Subsequent touches of **AM/FM** will scroll through **FM1**, **FM2**, and **AM**.
2. Seek down to the previous station.
3. Seek up to the next station.
4. **Settings** menu. Select for **Sound**, **Bal/Fade**, **Options**, and **PTY** settings.
5. **Autostore** can automatically select and store up to 9 stations. Touch any preset button to listen to a stored station.
6. Preset soft keys. Can store 9 stations for each waveband. Touch and hold a soft key to store the current radio station. Touch and release a preset soft key to tune the radio to the station stored. Alternatively, use the seek button on the steering wheel, to find the next or previous preset station.

Many screens feature the arrow icon in the bottom right corner. Touch this icon to return to the previous screen.

## Satellite radio

### Satellite radio subscription service

Use channel 184 to preview satellite radio. When the preview time expires, you will need to subscribe to SIRIUS to enable further satellite reception.

### Activating satellite radio

1. Call SIRIUS on the displayed telephone number.
2. Provide them with the ID number, also displayed on the screen.

You will also need your credit card. Make sure you are parked with a clear view of the sky while activation takes place. Activation can take up to 15 minutes.

### Satellite radio

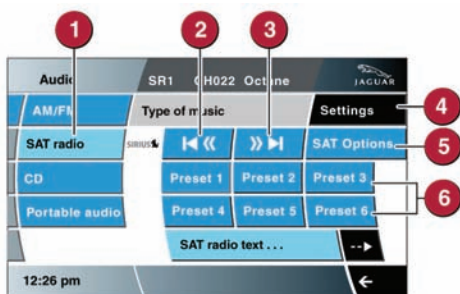

1. Touch to select the satellite bands. Touch to move through **SAT 1**, **2**, and **3**.

2. Seek down to the previous channel.
3. Seek up to the next channel.
4. **Settings**. Select to make personal settings for **Sound**, **Bal/Fade**, and **Song Seek**.
5. **SAT Options**. Touch to access and select from **Category Lists**, **Direct Channel**, **Parental Lock**, **Channel Skip** and **SAT information**. In **Category Lists** a category can be selected for use. **Direct Channel** allows a channel number to be inserted via the keypad. **Parental Lock** allows channels/categories to be censored. In **Channel Skip**, individual channels, or even entire categories, can be selected for exclusion when using the skip soft keys. **SAT Information** gives access to the SIRIUS ID number and subscription contact number.
6. Channel presets. Each **SAT** band has 6 preset soft keys. Touch and hold a soft key to store the current channel. A brief touch will access the stored channel. Alternatively, use the seek button on the steering wheel, to find the next or previous preset channel.

# AUDIO AND TOUCH SCREEN

## CD player and portable media

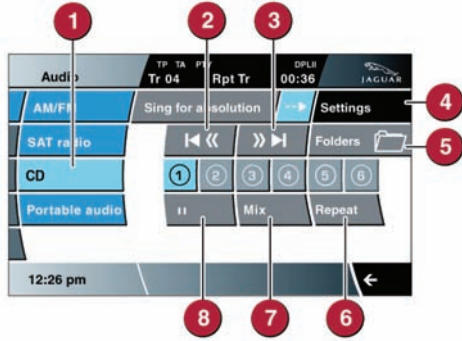

1. Select **CD** to view the CD menu.
2. Touch and release to skip down to the previous track. Hold to scan back through the current track.
3. Touch and release to skip up to the next track. Hold to scan forward through the current track.
4. **Settings** menu. Select for **Sound**, **Bal/Fade**,

**Options**, **Traffic**, and **CD text** settings.

5. **MP3 CD folders**. Select for folder contents and track selection.
6. **Repeat**. Touch and release to repeat the current track continuously. Touch and release again to repeat the current stored CD (or folder for MP3 discs). Touch again to cancel **Repeat** mode.
7. **Mix**. Touch and release once to play random tracks. Hold to randomly play all of the tracks on the media device, or tracks loaded onto the stored CD store. Touch and release again to cancel **Mix** mode.
8. **Pause/Play**. Select to pause playback, select again to resume playback.

Do not use discs with paper labels or dual format discs (Dual Discs or DVD Plus). They could become jammed inside the player.

## Connecting portable media

Connecting ports are located inside the center console cubby box.

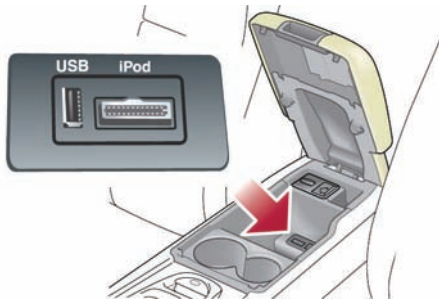

iPod and USB devices can be operated from the Touch screen. Devices connected to the 3.5mm AUX socket are controlled only from the device itself. When connecting to the USB socket, use the cable supplied with your media device.

The system will play MP3, WMA, WAV, and AAC files from a memory stick or a USB controlled MP3 player, or a telephone.

Some MP3 players use proprietary file systems that are not supported by the vehicle's system. MP3 players must be set to Removable Device or Mass Storage Device mode (see the manufacturer's information). Only music files added to the device while in this mode can be played via the vehicle's system.

The vehicle's system will support USB devices with a storage capacity of up to 256GB.

## Using the portable media

From the **Home** screen, select **Audio**, then **Portable audio**. Select **USB** or **iPod**.

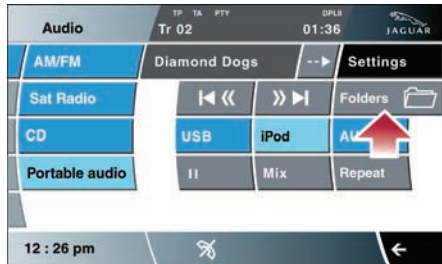

When a device is connected, touch **Folders** to display all search methods such as Playlist, artist, Albums, etc.

Continue through the folders to find the music you want to play. Use the arrow icons to scroll through the list.

 Touch and hold this icon to expand details of music being played.

Pause/Play, **Mix**, **Repeat**, and Seek next/previous are similar to CD use.

## Setting a destination

### Country selection

On initial activation, make sure that both the correct country and search area have been selected. For more information, refer to **Search Area** in the Navigation section of the Owner's Handbook.

1. Select **Navigation** from the **Home** screen. When prompted, touch **Agree** to access the Navigation **Menu** screen.
2. Select **Destination Entry**.
3. Touch **Address**.
4. With **Address** selected, touch **Town**, then use the on-screen keypad to enter address details. As each part of the address is displayed, select from the list to confirm.
5. When the entry is complete, touch **OK**.
6. Touch **Destination** to begin calculation of the route options.
7. The screen will display **Route 1**. To view alternative routes, touch the **3 Route** soft key. To use an alternative route, touch one of the selections.
8. When you have chosen the options, touch **Start**.
9. The selected route will be displayed and guidance will begin. When your destination is reached, voice and visual confirmation is given.



If the map is moved away from your current location, the position icon will be replaced by a soft key near the top left of the screen. Touch to bring the current location map back into view.



Touch this icon to repeat the last voice instruction. To deselect Voice guidance, go to the Navigation **Menu** screen, then select **Auto Voice Guidance Off**.

*Note: The Navigation system has features, which include: **Search area/Country selection, Points of Interest, Memory points, Split screen, Previous destination and Route preferences.***

*For more information, refer to the Navigation section of the Owner's Handbook.*

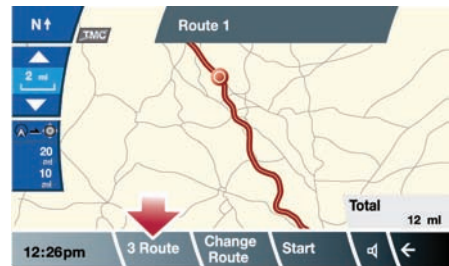
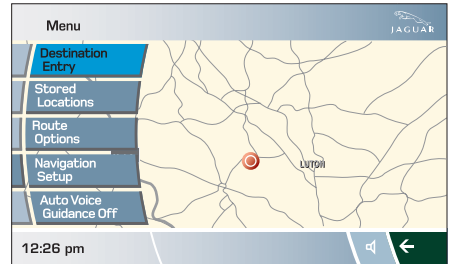

### Canceling guidance

To cancel guidance, touch **Menu**, **Route Options** and then **Cancel Guidance**.

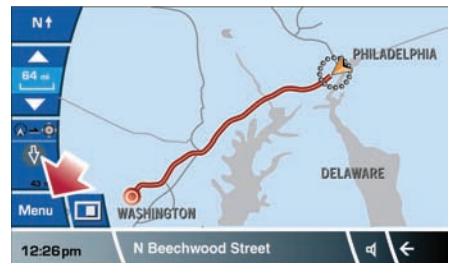

### Message center turn by turn navigation

As well as the main Navigation Touch screen display, there is a navigation feature that utilises the Message center display in the Instrument panel. Once you have set a destination and commenced guidance, a simplified graphic guide is displayed, giving basic turn by turn information about the next part of the trip. This feature can be turned on or off via the Touch screen.

## Bluetooth® wireless technology devices

See page 2, item 22.

### Bluetooth Connectivity

Compatible **Bluetooth** wireless technology devices can communicate with the vehicle's in-built telephone system. For the latest compatibility information, refer to [www.jaguar.com/Ownership support](http://www.jaguar.com/Ownership-support).

Connection must be made with the ignition on or the engine running.

Use the following procedure in conjunction with your phone manufacturer's instructions.

### Pairing and connecting using a phone

*Note: The process of pairing and connecting a phone to the vehicle will vary depending on the type of phone used.*

1. Make sure that the Touch screen is active.
2. From the **Home** menu, select **Phone**.  
*Note: The vehicle's Bluetooth wireless technology system is discoverable for only 3 minutes.*
3. Using your phone, search for **Bluetooth** wireless technology devices. On some phones, this is referred to as a new paired device. See your phone's operating instructions for further information.
4. When the vehicle's system is discovered, select it and begin the pairing process, following the on-screen instructions.
5. When requested, enter the PIN **1313** into your phone and select **OK** to confirm.
6. When your phone is paired and connected, a confirmation message will be displayed.

*Note: Some phones require the pairing to be set as 'authorised' or 'trusted', in order to automatically connect. Please refer to your phone's operating instructions for further information.*

To change or undock a paired phone, go to the **Settings** option on the **Phone** menu screen.

### Downloading phonebook entries



When a phone with phonebook download capability is paired and docked, its phonebook directory can be automatically downloaded to the vehicle's system.

The vehicle's phonebook will be updated each time a phone is docked to the system. To change the **Auto download** setting via the Touch screen, touch **Phone**, select **Phone options**, then **Phonebook**. Apply the change.

### Calls via the Touch screen

1. From the **Home** screen, select **Phone**.



2. Select **Digit Dial**, **Names**, **Last 10**, or **Phone**. With **Digit Dial** selected, use the keypad to enter the number. With **Names** selected, choose a number from the downloaded phonebook. **Last 10** displays the previous 10 calls. Choose one to dial.
3. To make a call, touch the connect icon . The icon will change to a connected call icon.
4. To end a call, touch .

### Calls via the steering wheel controls

1. Volume control. Turn to increase/decrease the call volume.
2. Scroll control. Turn to scroll up/down lists of calls or phonebook entries.
3. Phone/Voice control. Press and release to dial, accept, or end a call.
4. Press and hold to enter phone mode.

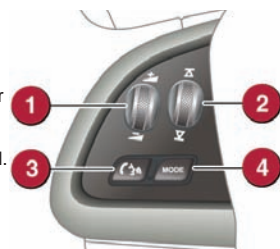

### Signal reception

- Reception is dependent on the phone and network signal. Performance may be improved by changing your phone's settings (e.g., from 3G to 2G).
- If echo is experienced during a call, reduce the Audio system's volume.

# GAS STATION INFORMATION

## Refueling

The gas filler flap is located on the right side of the vehicle. If the vehicle is locked, the filler flap cannot be opened.

Press the filler flap release button.



The correct fuel specification is shown on the inside of the filler flap.

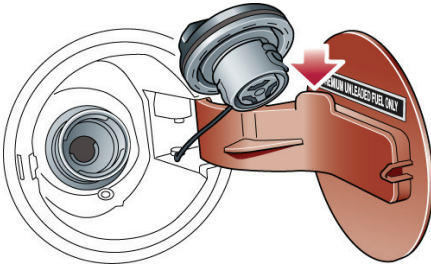

Twist the cap counter-clockwise to release. A hook is provided on the flap hinge to hold the cap while refueling. After refueling, tighten the cap clockwise until it clicks 3 times.

**DO NOT** use E85 fuels (85% ethanol content).

Equipment necessary for the use of fuels containing more than 10% ethanol is not fitted to this vehicle. If E85 fuels are used, serious engine and fuel system damage will occur.

Avoid using fuel containing methanol. If it is unavoidable, do not use a fuel with more than 10% methanol content. The fuel must contain co-solvents and corrosion inhibitors. Fuel system damage and engine performance problems can occur when methanol is used.

Unleaded fuels containing up to 15% MTBE can be used.

No responsibility is accepted for damage caused by using incorrect fuels.

If the vehicle is filled with the wrong type of fuel:

- **DO NOT start the engine!**
- **Call for qualified assistance!**

## Hood release

The hood release is located in the left side footwell.

## Tire pressure label location

Tire pressures are shown on a label attached to the left side door.

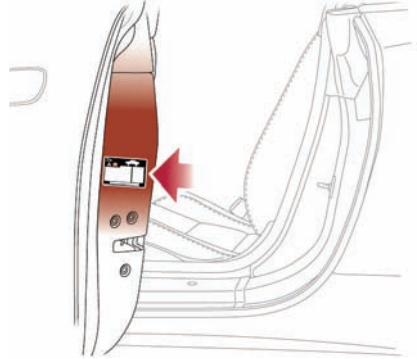

*Note: Tire pressures must be checked and adjusted while the tires are cold.*