



2024

RC F

OWNER'S MANUAL QUICK GUIDE

# Contents

The Quick Guide is not intended as a substitute for your *OWNER'S MANUAL*. We strongly encourage you to review the *OWNER'S MANUAL* and supplementary manuals so you will have a better understanding of your vehicle's capabilities and limitations.

<b>Pictorial Index</b> .....	<b>3</b>
<b>Floor Mat Installation</b>	
Floor Mat Installation.....	11
<b>When Driving</b>	
Turn Signal Lever.....	12
Multi-information Display.....	13
Headlights.....	16
AHB (Automatic High Beam).....	17
Windshield Wipers and Washer.....	19
Intuitive Parking Assist.....	24
BSM (Blind Spot Monitor).....	25
Tire Pressure Warning System.....	26
ASC (Active Sound Control).....	27
Active Rear Wing.....	28

**Driving Comfort**

Remote Touch..... 29  
Center Display .....31  
Fuel Consumption Information ..... 34  
Navigation System \* ..... 36  
Hands-free System For Cellular Phone \* ..... 40  
Audio System\* ..... 45  
Automatic Air Conditioning System \* .....51  
Seat Heaters/Seat Ventilators .....55  
Voice Command System\* ..... 56  
USB/AUX Ports ..... 63  
Garage Door Opener ..... 64  
Lexus Enform Safety Connect..... 68  
Lexus Enform Remote ..... 70  
Lexus Enform Service Connect.....71  
SiriusXM Satellite Radio.....72

**What to do if...**

List of Warning/Indicator Lights.....73  
If the engine doesn't start.....77  
If the electronic key does not operate properly..... 78

\*: This feature may be operated by Voice command (See P.56)

# Pictorial Index

## Instrument panel

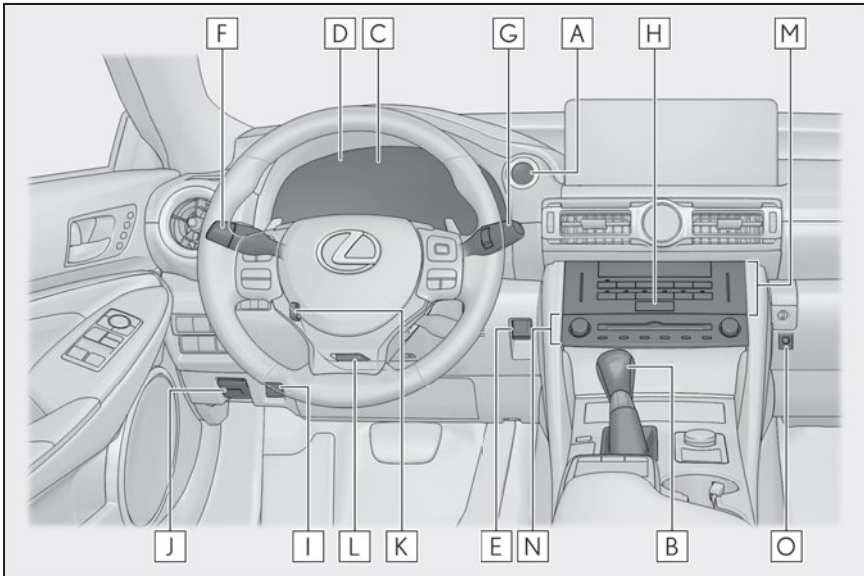

### **A** Engine switch \*1

Starting the engine/changing the mode \*1

Emergency stop of the engine \*1

When the engine will not start ..... P.77

Warning messages \*1

### **B** Shift lever \*1

Changing the shift position \*1

Precautions for towing \*1

When the shift lever does not move \*1

### **C** Meters \*1

Reading the meters/adjusting the instrument panel lights \*1

Warning lights/indicator lights ..... P.73

When a warning light comes on \*1

### **D** Multi-information display ..... P.13

Display ..... P.13

When the warning messages are displayed \*1

<b>E</b>	<b>Parking brake switch</b> *1	
	Applying/releasing *1	
	Precautions for winter season *1	
	Warning buzzer/message *1	
<b>F</b>	<b>Headlight switch</b> .....	P.16
	<b>Turn signal lever</b> .....	P.12
	Headlights/parking lights/tail lights/license plate lights/daytime running lights .....	P.16
<b>G</b>	<b>Windshield wiper and washer switch</b> .....	P.19
	Usage .....	P.19
	Adding washer fluid *1	
	Warning messages *1	
	Headlight cleaners *2 .....	P.19
<b>H</b>	<b>Emergency flasher switch</b> *1	
<b>I</b>	<b>Trunk opener switch</b> *1	
<b>J</b>	<b>Hood lock release lever</b> *1	
<b>K</b>	<b>Tilt and telescopic steering control switch</b> *1,2	
	Adjustment *1	
	Driving position memory *1,2	
<b>L</b>	<b>Tilt and telescopic steering lock release lever</b> *1,2	
<b>M</b>	<b>Air conditioning system</b> .....	P.51
	Usage .....	P.51
	Rear window defogger *1	
<b>N</b>	<b>Audio system</b> .....	P.45
<b>O</b>	<b>Trunk opener main switch</b> *1	

\*1: Refer to the "OWNER'S MANUAL".

\*2: If equipped

## ■ Switches

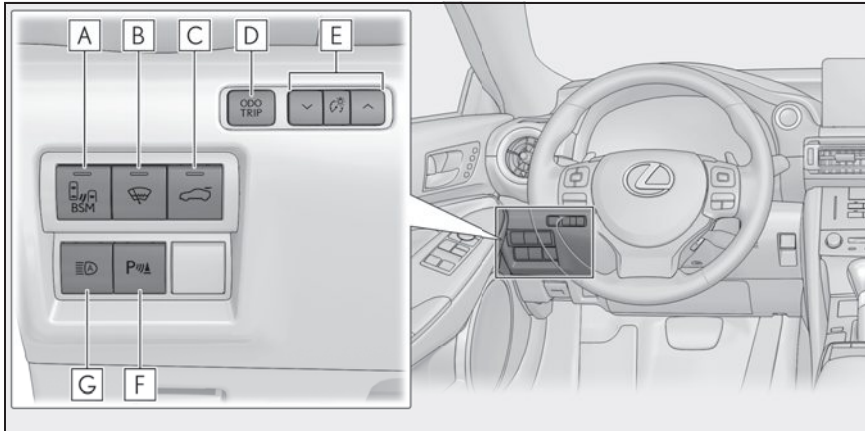

- A** BSM (Blind Spot Monitor) main switch ..... P.25
- B** Windshield wiper de-icer switch \*1,2
- C** Active rear wing switch \*2 ..... P.28
- D** Odometer/trip meter/trip meter reset button \*1
- E** Instrument panel light control switches \*1
- F** Intuitive parking assist switch \*2 ..... P.24
- G** Automatic High Beam switch ..... P.17

\*1: Refer to the "OWNER'S MANUAL".

\*2: If equipped

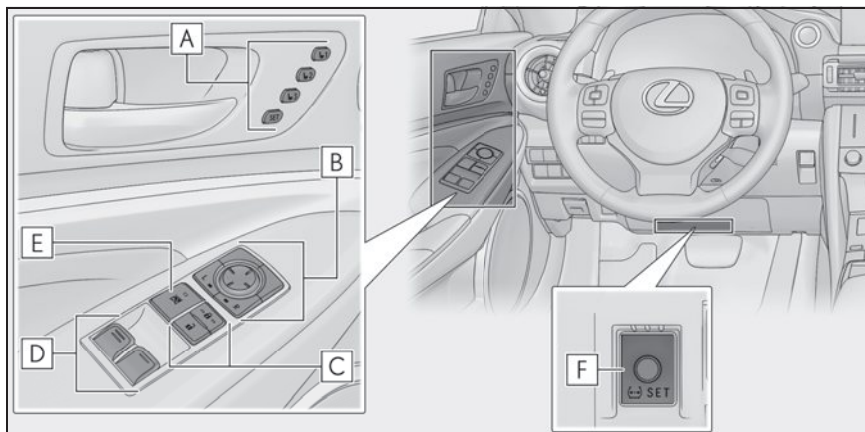

- A** Driving position memory buttons \*1,2
- B** Outside rear view mirror switches \*1
- C** Door lock switches \*1
- D** Power window switches \*1
- E** Window lock switch \*1
- F** Tire pressure warning reset switch..... P.26

\*1: Refer to the "OWNER'S MANUAL".

\*2: If equipped

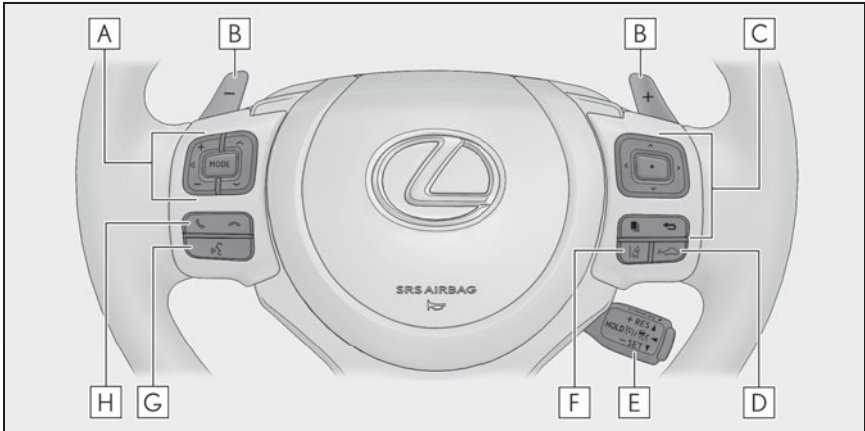

- A** Audio remote control switches..... P.46
- B** Paddle shift switches\*
- C** Meter control switches ..... P.15
- D** Vehicle-to-vehicle distance switch\*
- E** Cruise control switch\*
- F** LTA (Lane Tracing Assist) switch\*
- G** Talk switch ..... P.44
- H** Telephone switches ..... P.44

\*: Refer to the "OWNER'S MANUAL".



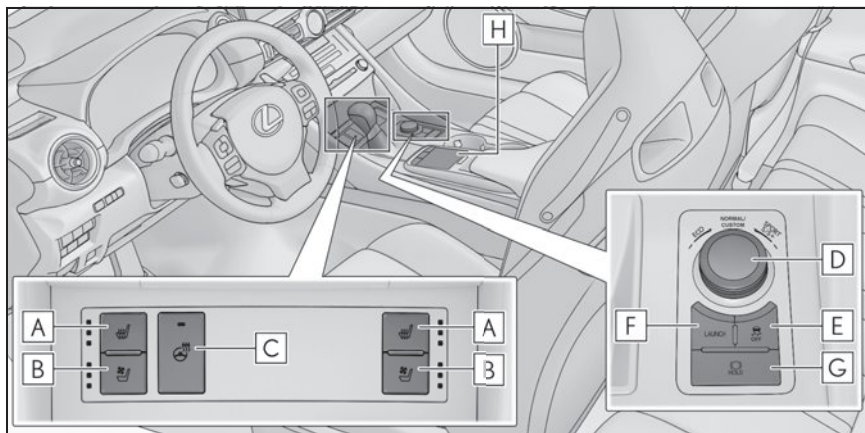

- A** Seat heater switches <sup>\*1</sup> ..... P.55
- B** Seat ventilator switches <sup>\*1</sup> ..... P.55
- C** Heated steering wheel switch <sup>\*1,2</sup>
- D** Driving mode select switch <sup>\*2</sup>
- E** VSC OFF switch <sup>\*2</sup>
- F** "LAUNCH" switch <sup>\*2</sup>
- G** Brake hold switch <sup>\*2</sup>
- H** Remote Touch ..... P.29

<sup>\*1</sup>: If equipped

<sup>\*2</sup>: Refer to the "OWNER'S MANUAL".

## ■ Interior

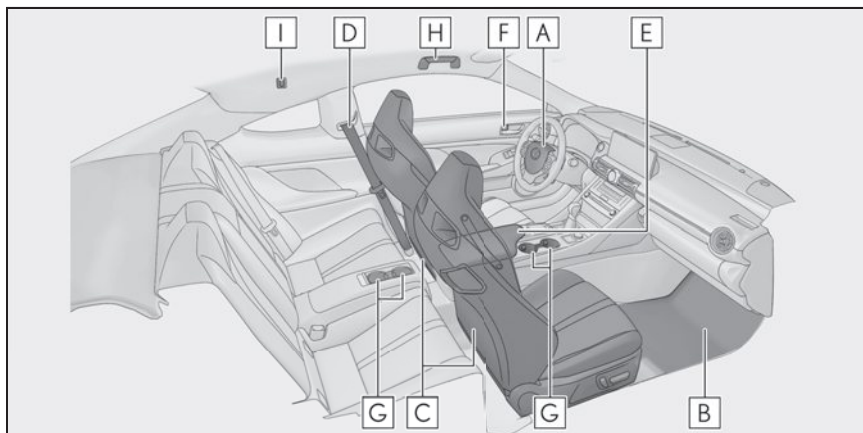

**A** SRS airbags \*1

**B** Floor mats ..... P.11

**C** Front seats \*1

**D** Seat belts \*1

**E** Console box \*1

**F** Inside lock buttons \*1

**G** Cupholders \*1,2

**H** Assist grips \*1

**I** Coat hooks \*1

\*1: Refer to the "OWNER'S MANUAL".

\*2: If equipped

## ■ Ceiling

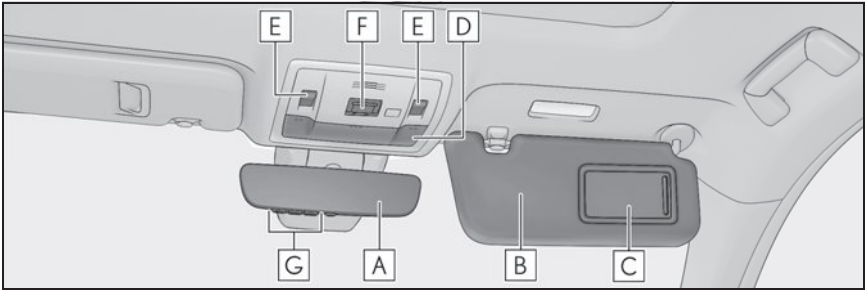

**A** Inside rear view mirror \*1

**B** Sun visors \*1

**C** Vanity mirrors \*1

**D** Interior light \*1  
Personal lights \*1

**E** Moon roof switches \*1,2

**F** "SOS" button \*2 ..... P.68

**G** Garage door opener buttons..... P.64

\*1: Refer to the "OWNER'S MANUAL".

\*2: If equipped

## Floor Mat Installation

Use only floor mats designed specifically for vehicles of the same model and model year as your vehicle. Fix them securely in place onto the carpet.

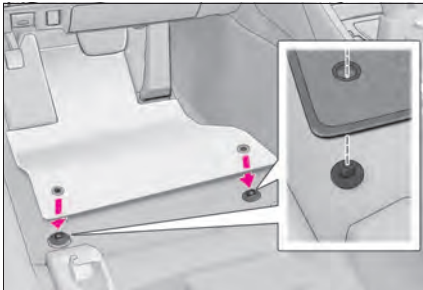

- 1 Insert the retaining hooks (clips) into the floor mat eyelets.

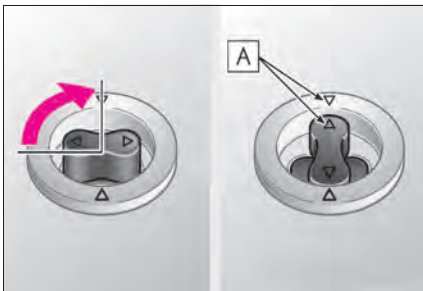

- 2 Turn the upper knob of each retaining hook (clip) to secure the floor mats in place.

Always align the  $\triangle$  **A** marks.

The shape of the retaining hooks (clips) may differ from that shown in the illustration.

## Turn Signal Lever

The lever will return to its original position immediately after operation.

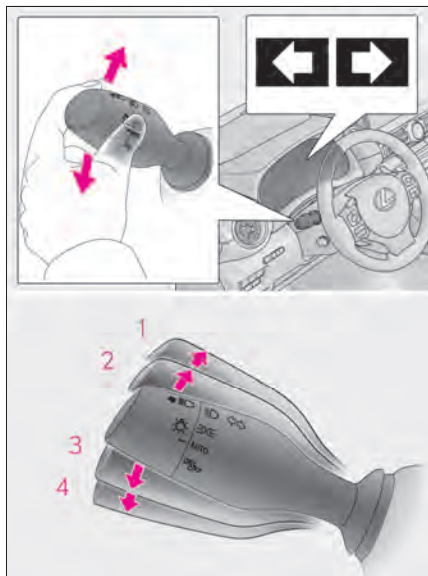

- 1** Right turn
- 2** Lane change to the right (move the lever partway and release it)  
The right hand signals will flash 3 times.
- 3** Lane change to the left (move the lever partway and release it)  
The left hand signals will flash 3 times.

### **4** Left turn

If the turn signals do not stop flashing after turning left or right, or if you want to stop them flashing, operate the lever in the opposite direction to either position **2** or **3**. If you move the lever to either position **1** or **4**, the selected turn signals will flash.

# Multi-information Display

The multi-information display presents the driver with a variety of vehicle data.

## Displays and menu icons

### ► Content display area

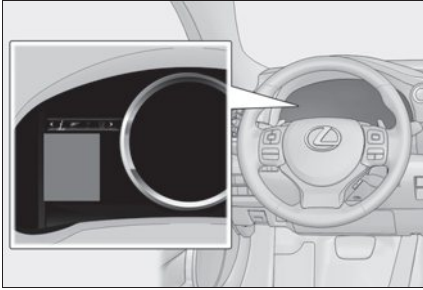

By selecting menu icons on the multi-information display, a variety of driving-related information can be displayed. The multi-information display can also be used to change display settings and other vehicle settings.

Warning or suggestion/advice pop-up displays are also displayed in certain situations.



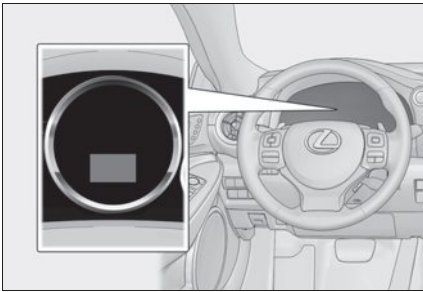



### ► Sub-content display area



Displays some "F" content in conjunction with the content display area.

## ■ Menu icons

The menu icons will be displayed by pressing < or > of the meter control switch.

	Drive information
	"F" content
	Navigation system-linked display (if equipped)
	Audio system-linked display
	Driving assist system information
	Warning message display
	Settings display

If a problem is detected in any of the vehicle's systems, a warning message is shown on the multi-information display.

## Changing the meter display

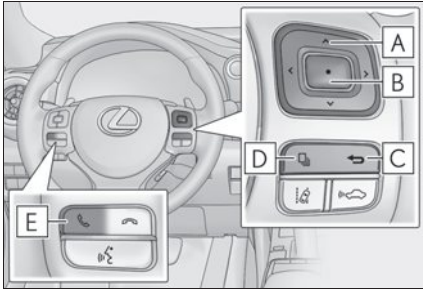



- A** < / > : Select menu icons  
^ / v : Change displayed content, scroll up/down the screen and move the cursor up/down
- B** Press: Enter/Set  
Press and hold: Reset
- C** Return to the previous screen  
Pressing and holding the switch will display the first screen of the selected menu icon.
- D** Press: Display the top screen  
Press and hold: Register current screen as the top screen
- E** Call sending/receiving and history display  
Linked with the hands-free system, sending or receiving call is displayed. For details regarding the hands-free system, refer to the "NAVIGATION AND MULTIMEDIA SYSTEM OWNER'S MANUAL".

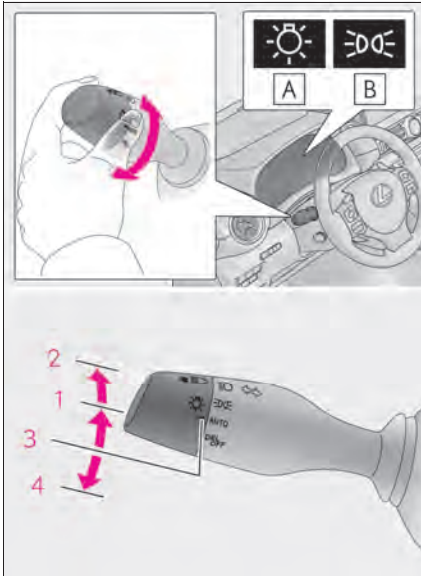

# Headlights



- 1**  The side marker, parking, tail, license plate, instrument panel lights, and daytime running lights turn on.
- 2**  The headlights and all lights listed above (except daytime running lights) turn on.
- 3** **AUTO** The headlights, daytime running lights and all the lights listed above turn on and off automatically. (When the engine switch is in IGNITION ON mode.)
- 4**  (U.S.A.) Off

- A** U.S.A.  
**B** Canada

## Turning on the high beam headlights

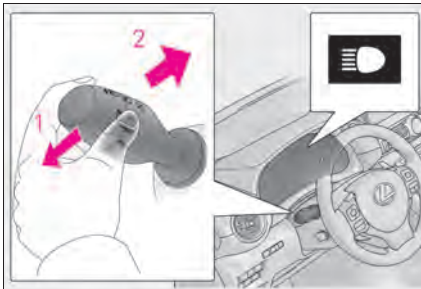

- 1** With the headlights on, push the lever away from you to turn on the high beams.  
Pull the lever toward you to the center position to turn the high beams off.
- 2** Pull the lever toward you and release it to flash the high beams once.  
You can flash the high beams with the headlights on or off.

## AHB (Automatic High Beam)

The Automatic High Beam uses a camera sensor located behind the upper portion of the windshield to assess the brightness of the lights of vehicles ahead, streetlights, etc., and automatically turns the high beams on or off as necessary.

### Activating the Automatic High Beam

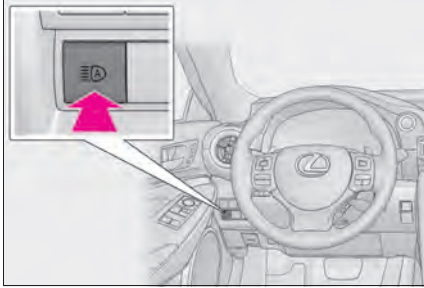

- 1 Press the Automatic High Beam switch.

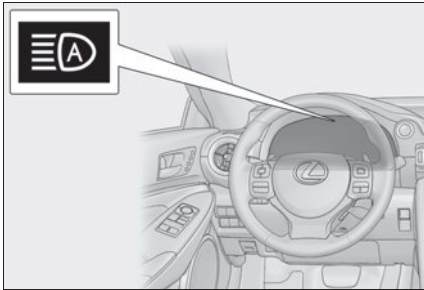

- 2 Turn the headlight switch to the AUTO or  position.

The Automatic High Beam indicator will come on when the system is operating.

## Turning the high beams on/off manually

### Switching to the high beams

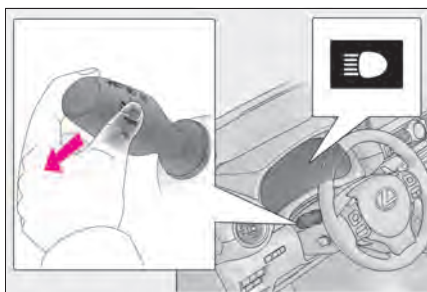

Push the lever away from you.

The Automatic High Beam indicator will turn off and the high beam indicator will turn on.

Pull the lever to its original position to activate the Automatic High Beam system again.

### Switching to the low beams

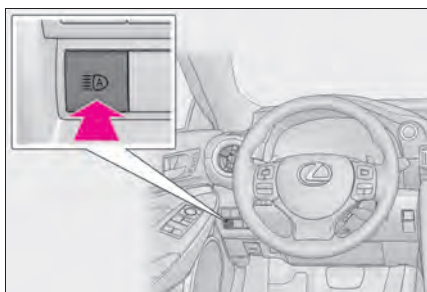

Press the Automatic High Beam switch.

The Automatic High Beam indicator will turn off.

Press the switch to activate the Automatic High Beam system again.

### Temporarily switching to the low beams



Pull the lever toward you and then return it to its original position.

The high beams are on while the lever is pulled toward you, however, after the lever is returned to its original position, the low beams remain on for a certain amount of time. Afterwards, the Automatic High Beam will be activated again.

# Windshield Wipers and Washer

Operating the  lever operates the wipers or washer as follows. The lever will return to its original position after operation.



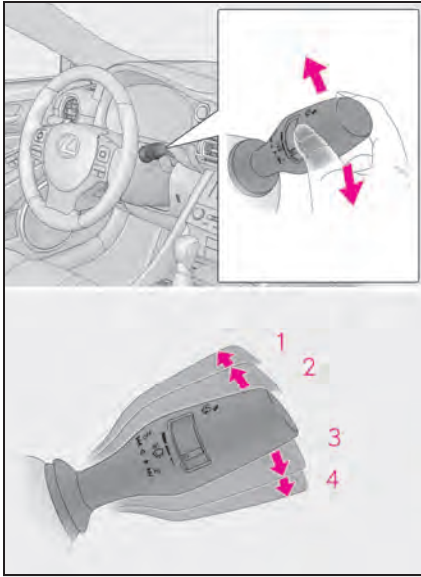



## ► Intermittent windshield wipers with interval adjuster





- 1**  OFF (U.S.A.) or  (Canada)  
Move the lever up by 2 levels
- 2**  Move the lever up by 1 level
- 3**  (U.S.A.) or  (Canada)  
Move the lever down by 1 level
- 4**  HI (U.S.A.) or  (Canada)  
Move the lever down by 2 levels

Depending on the operating state of the wipers when the wiper lever is operated, the wipers will operate as follows.



### • Current wiper operation: Off

Wiper lever operation	Wiper operation
 OFF or 	Temporary operation
	Temporary operation
 or 	Intermittent operation
 HI or 	High speed operation

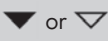
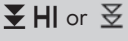

• Current wiper operation: Intermittent operation

Wiper lever operation	Wiper operation
 OFF or 0	Off
	Off
	Low speed operation
	High speed operation

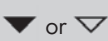
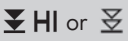
• Current wiper operation: Low speed operation

Wiper lever operation	Wiper operation
 OFF or 0	Off
	Intermittent operation
	High speed operation
	High speed operation

• Current wiper operation: High speed operation

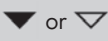
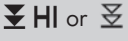
Wiper lever operation	Wiper operation
 OFF or 0	Off
	Low speed operation
	No change
	No change

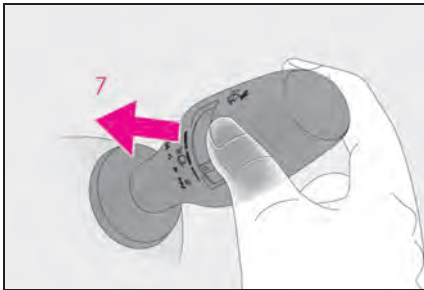
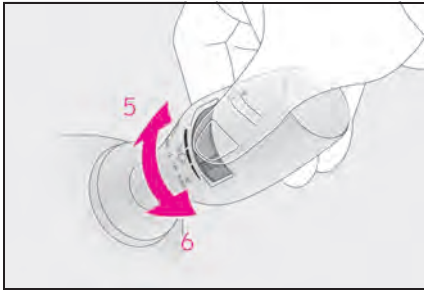

Wiper intervals can be adjusted when intermittent operation is selected.

**5** Increases the intermittent windshield wiper frequency

**6** Decreases the intermittent windshield wiper frequency

**7**  Washer/wiper dual operation

Pulling the lever operates the wipers and washer.

The wipers will automatically operate a couple of times after the washer squirts.

Vehicles with headlight cleaners:  
When the engine switch is in IGNITION ON mode and the headlights are on, if the lever is pulled, the headlight cleaners will operate once. After this, the headlight cleaners will operate every 5th time the lever is pulled.

### ► Rain-sensing windshield wipers

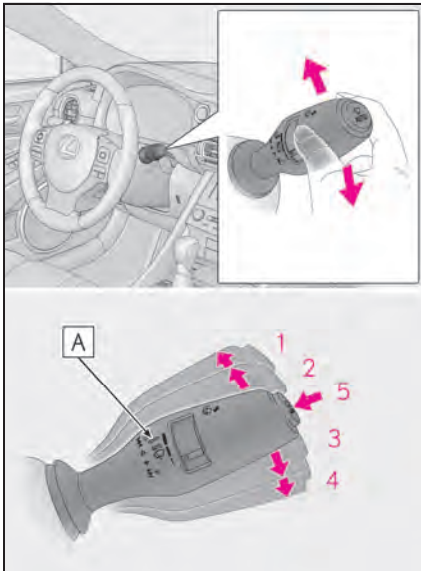

**1**  OFF (U.S.A.) or  (Canada)

Move the lever up by 2 levels

**2**  Move the lever up by 1 level

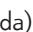
**3**  (U.S.A.) or  (Canada)

Move the lever down by 1 level

**4**  HI (U.S.A.) or  (Canada)

Move the lever down by 2 levels

**5**  AUTO mode on/off switch





The AUTO mode indicator **A** will turn on when AUTO mode is selected.

Depending on the operating state of the wipers when the wiper lever is operated, the wipers will operate as follows.

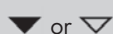

- Current wiper operation: Off

Wiper lever operation	Wiper operation
	Temporary operation
	Temporary operation
	Low speed operation
	High speed operation



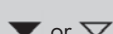
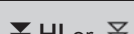

- Current wiper operation: Low speed operation

Wiper lever operation	Wiper operation
	Off
	Off
	High speed operation
	High speed operation

- Current wiper operation: High speed operation

Wiper lever operation	Wiper operation
	Off
	Low speed operation
	No change
	No change

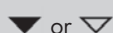
- Current wiper operation: AUTO mode (Intermittent operation)

Wiper lever operation	Wiper operation
	Off
	Temporary operation <sup>*1</sup>
	Low speed operation <sup>*2</sup>
	High speed operation <sup>*2</sup>

• Current wiper operation: AUTO mode (Continuously)

Wiper lever operation	Wiper operation
⏏ OFF or ○	Off
△	No change
▼ or ▽	Low speed operation <sup>*2</sup>
⏏ HI or ⏏	High speed operation <sup>*2</sup>

\*1: After temporary operation, the mode will return to AUTO mode.

\*2: AUTO mode will be canceled.

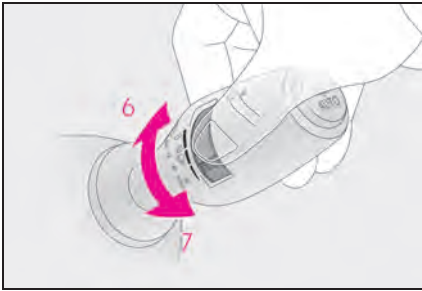

When AUTO mode is selected, the sensor sensitivity can be adjusted by turning the switch ring.

**6** Increases the sensitivity

**7** Decreases the sensitivity

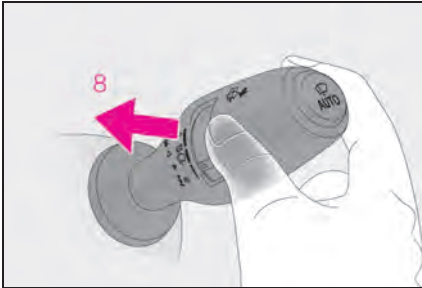

**8**  Washer/wiper dual operation

Pulling the lever operates the wipers and washer.

The wipers will automatically operate a couple of times after the washer squirts.

Vehicles with headlight cleaners:  
When the engine switch is in IGNITION ON mode and the headlights are on, if the lever is pulled, the headlight cleaners will operate once. After this, the headlight cleaners will operate every 5th time the lever is pulled.



## Intuitive Parking Assist (if equipped)

The distance from your vehicle to nearby obstacles when parallel parking or maneuvering into a garage is measured by the sensors and communicated via the multi-information display, Center Display and a buzzer. Always check the surrounding area when using this system.

### Intuitive parking assist switch

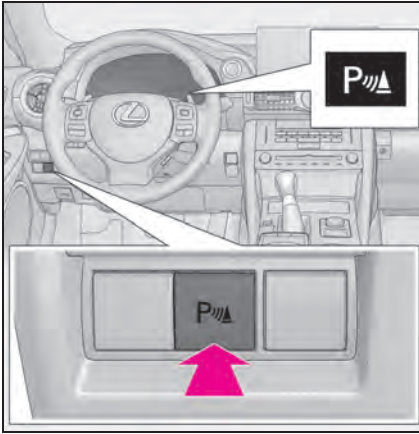

Turns the intuitive parking assist on/off

When on, the indicator light comes on to inform the driver that the system is operational.

## BSM (Blind Spot Monitor)

The Blind Spot Monitor is a system that has 2 functions:

- The BSM (Blind Spot Monitor) function  
Assists the driver in making a decision when changing lanes
- The RCTA (Rear Cross Traffic Alert) function  
Assists the driver when backing up

These functions use same sensors.

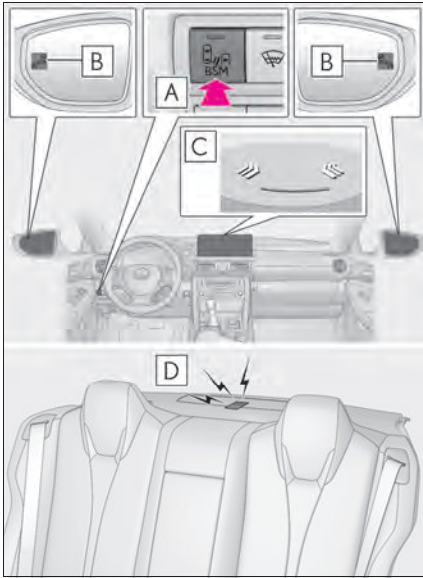

### A BSM main switch

This switch is for both the BSM function and RCTA function.

Pressing the switch turns the system on or off. When the switch is turned on, the indicator on the switch illuminates.

### B Outside rear view mirror indicators

BSM function:

When a vehicle is detected in a blind spot of the outside rear view mirrors or approaching rapidly from behind into a blind spot, the outside rear view mirror indicator on the detected side will illuminate. If the turn signal lever is operated toward the detected side, the outside rear view mirror indicator will flash.

RCTA function:

When a vehicle approaching from the right or left at the rear of the vehicle is detected, both outside rear view mirror indicators will flash.

### C Center Display

If a vehicle approaching from the right or left at the rear of the vehicle is detected, the RCTA icon for the detected side will be displayed on the Center Display.

This illustration shows an example of a vehicle approaching from both sides of the vehicle.

### D RCTA buzzer (RCTA function only)

If a vehicle approaching from the right or left at the rear of the vehicle is detected, a buzzer will sound. The buzzer also sounds for approximately 1 second immediately after the BSM main switch is operated to turn the system on.

## Tire Pressure Warning System

Your vehicle is equipped with a tire pressure warning system that uses tire pressure warning valves and transmitters to detect low tire inflation pressure before serious problems arise.

### The tire inflation pressure display function

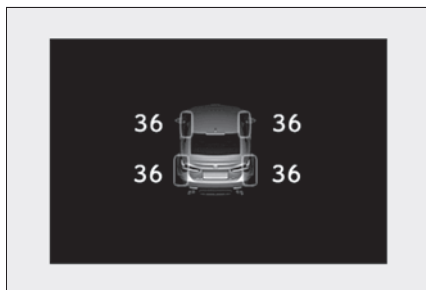

The tire pressure detected by the tire pressure warning system can be displayed on the multi-information display.

The illustration used is intended as an example, and may differ from the image that is actually displayed on the multi-information display.

### Initializing the tire pressure warning system

- 1 Park the vehicle in a safe place, turn the engine switch off and wait 20 minutes or more. Initialization cannot be performed while the vehicle is moving.
- 2 Adjust the tire inflation pressure to the specified cold tire inflation pressure level. Make sure to adjust the tire pressure to the specified cold tire inflation pressure level. The tire pressure warning system will operate based on this pressure level.
- 3 Start the engine.

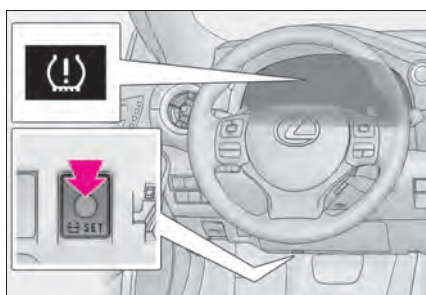

- 4 Press and hold the tire pressure warning reset switch until the tire pressure warning light blinks slowly 3 times.

Then a message will be displayed on the multi-information display.

- 5 Drive straight (with occasional left and right turns) at approximately 25 mph (40 km/h) or more for approximately 10 to 30 minutes.

Initialization is complete when the position of each tire is determined and the inflation pressure of each tire is displayed on the multi-information display.

## **ASC (Active Sound Control) (if equipped)**

The ASC system sonically emphasizes the vehicle's response to the driver's operation of the accelerator pedal and shift lever or paddle shift switches. The dynamic engine sound enabled by this system helps the driver further enjoy the feeling of unity with the vehicle, particularly when driving in M mode.

## Active Rear Wing (if equipped)

The RC F is equipped with an active rear wing that operates automatically while the vehicle is being driven. This active rear wing enhances aerodynamic performance, especially at high speeds, contributing to a more stable ride.

The active rear wing can be controlled using a switch.

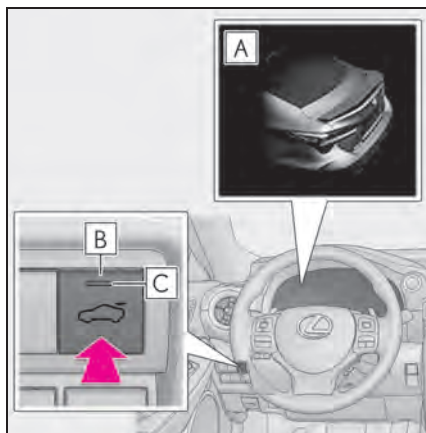

- A** Multi-information display (→P.13)  
Displays the status of the active rear wing
- B** Active rear wing switch  
Operates the active rear wing manually
- C** Indicator  
Illuminates when the active rear wing is raised and turns off when it is retracted

# Remote Touch

The Remote Touch can be used to operate the Center Display.

Remote Touch is the name for the device that includes the "MAP" button, "HOME" button, "MENU" button, back button, touchpad and sub function button.

## Names and operations of each part

### ► Vehicles with a 10.3-inch display

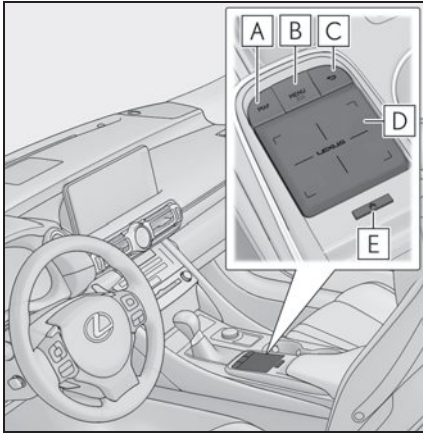

**A** "MAP" button

Press this button to display the vehicle's current position.

**B** "MENU" button

Press this button to display the menu screen.

**C** Back button

Press this button to display the previous screen.

**D** Touchpad

Slide your finger on the touchpad and move the pointer to select a function, letter and screen button.

Press the touchpad to enter the selected function, letter or screen button. Certain finger movements on the touchpad can perform functions, such as changing map scalings and scrolling list screens.

**E** Sub function button

When  is displayed on the screen, a function screen assigned to the screen can be displayed.

► Vehicles with a 8-inch display

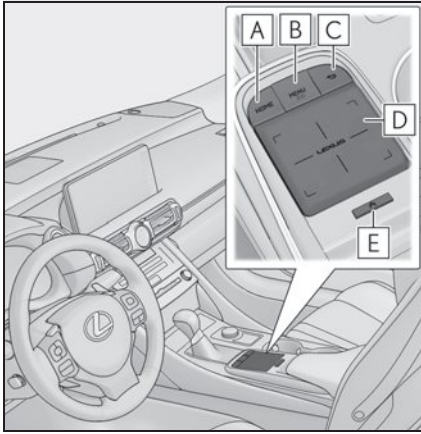

- A** “HOME” button  
Press this button to display the “Home” screen.
- B** “MENU” button  
Press this button to display the menu screen.
- C** Back button  
Press this button to display the previous screen.

**D** Touchpad

Slide your finger on the touchpad and move the pointer to select a function, letter and screen button.

Press the touchpad to enter the selected function, letter or screen button. Certain finger movements on the touchpad can perform functions, such as scrolling list screens.

**E** Sub function button

When  is displayed on the screen, a function screen assigned to the screen can be displayed.

# Center Display

## Menu screen

Press the “MENU” button on the Remote Touch to display the menu screen.









This system can also be operated by the touch screen.

### ▶ Vehicles with a 10.3-inch display



### ▶ Vehicles with a 8-inch display



Switch	Function
	Select to display the “Destination” screen. (→P.36)
	Select to display the media control screen. (→P.47, 48, 49, 50)
	Select to display the hands-free control screen. (→P.40)
	Select to display the “Apps” screen.*1,2
	When an Apple CarPlay/Android Auto connection is established and this button displays “Apple CarPlay”/“Android Auto”, select to display the Apple CarPlay/Android Auto screen.*1,2
	Select to display the information screen.*1 (→P.34)
	Select to display the setup screen.*1
	Select to display the air conditioning control screen. (→P.52)
	Select to adjust the contrast and brightness of the screens, turn the screen off, etc.*1,2

\*1: Refer to the “NAVIGATION AND MULTIMEDIA SYSTEM OWNER’S MANUAL”.

\*2: This function is not available on some models.



## Split-screen display (Vehicles with a 10.3-inch display)

Different information can be displayed on the left and right sides of the screen. For example, air conditioning system screen can be displayed and operated while the fuel consumption information screen is being displayed. The large screen on the left of the display is called the main display, and the small screen to the right is called the side display.

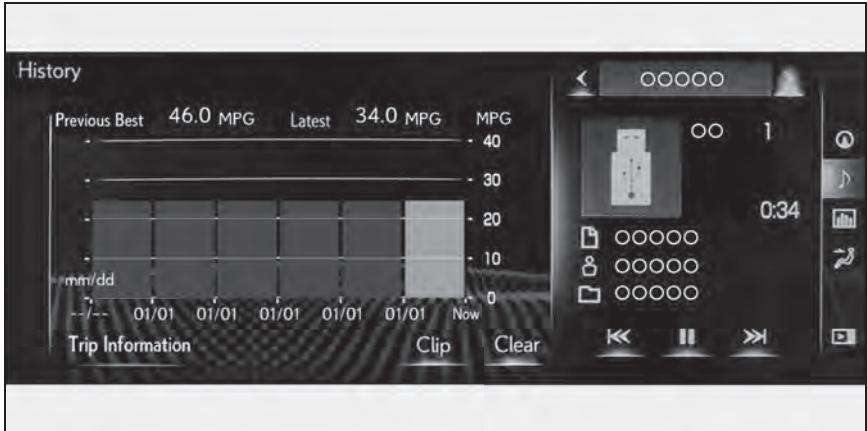

## Side display (Vehicles with a 10.3-inch display)

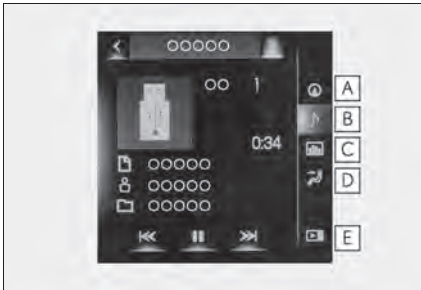

The following functions can be displayed and operated on the side display.

- A** Navigation system (→P.36)
- B** Audio (→P.47, 48, 49, 50)
- C** Vehicle information (→P.35)
- D** Air conditioning system (→P.54)
- E** Show/hide the side display\*

\*: Refer to the "NAVIGATION AND MULTIMEDIA SYSTEM OWNER'S MANUAL".

## Screen scroll operation (Vehicles with a 10.3-inch display)

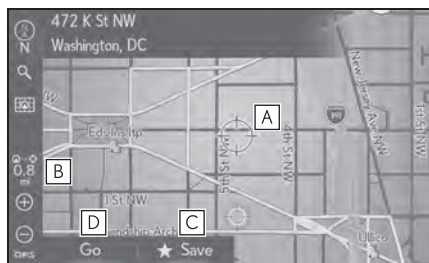

Select the desired point on the map screen.

Move the desired point on the center of the map screen.

- A** Cursor mark
- B** Distance from the current position to the cursor mark
- C** Select to register as a memory point
- D** Select to set as a destination

Press the “MAP” button on the Remote Touch to return to the current position.

## Editing route (Vehicles with a 10.3-inch display)

While route guidance is operating, you can change the route using the following method.

- 1 Select  on the map screen.

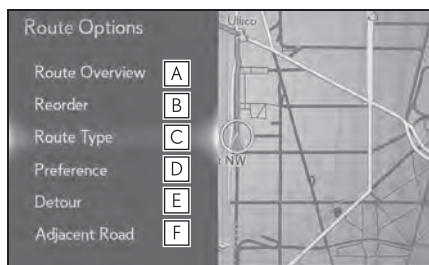

- 2 Select the desired item to be set.

- A** Select to display the overview of the entire route
- B** Select to reorder destinations
- C** Select to change route type
- D** Select to set route preferences
- E** Select to set detours
- F** Select to start from adjacent road

- 3 Check that the route overview is displayed.

Some functions are unavailable while the vehicle is in motion. Refer to the “NAVIGATION AND MULTIMEDIA SYSTEM OWNER’S MANUAL”.

# Fuel Consumption Information

Fuel consumption information can be displayed on the Center Display.

Vehicles with a 10.3-inch display: The fuel consumption information can be displayed and operated on the side display. For details, refer to the “OWNER’S MANUAL”.

## Consumption

Press the “MENU” button on the Remote Touch, then select  on the menu screen, and then select “ECO”.

### ■ Trip information

If a screen other than “Trip Information” is displayed, select “Trip Information”.

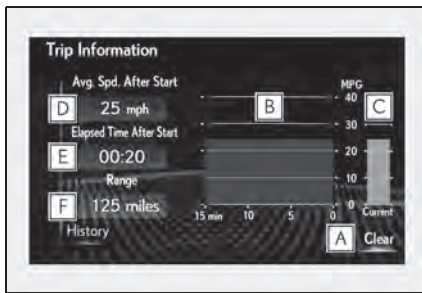

- A** Resetting the consumption data
- B** Fuel consumption in the past 15 minutes
- C** Current fuel consumption
- D** Average vehicle speed since the engine was started.
- E** Elapsed time since the engine was started.
- F** Cruising range

### ■ History

If a screen other than “History” is displayed, select “History”.

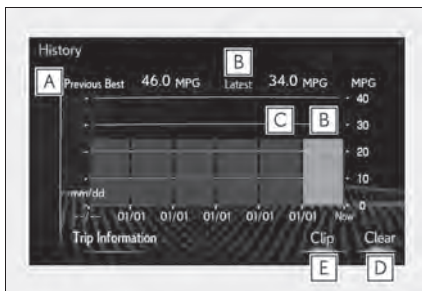

- A** Best recorded fuel consumption
- B** Latest fuel consumption
- C** Previous fuel consumption record
- D** Resetting the history data
- E** Updating the latest fuel consumption data

## Using the side display (vehicles with a 10.3-inch display)

Display the vehicle information on the side display (→P.32), and then select  or  to display the desired screen.



- Trip information (type A/type B)
- History

# Navigation System (Vehicles with a 10.3-inch display)

## Registering home

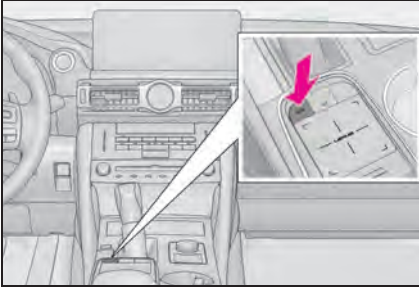

- 1 Press the "MAP" button on the Remote Touch.

Please refer to P.29 for the Remote Touch operation.

- 2 Select .

- 3 Select "Home".

- 4 Select "Yes".

- 5 Select "OK".

Registration of home is complete.

## Destination search

### ■ Searching by address

There are 2 methods to search for a destination by address.

- 1 Display the destination search screen by either operation:

- "MAP" button → 

- "MENU" button → "Destination"

- 2 Select "Address".

- 3** Enter a house number and select "Search".  
"Change State/Province": Select to change the search area.
- 4** Enter a street name and select "Search".
- 5** Select the desired street name.
- 6** Enter a city name and select "Search".
- 7** Select the desired city name.

If multiple locations with the same address exist, the address list screen will be displayed. Select the desired address.

## ■ Searching by point of interest

There are 3 methods to search for a destination by Point of Interest.

1 Display the destination search screen by either operation:

- “MAP” button → 
- “MENU” button → “Destination”

2 Select “Point of Interest”.

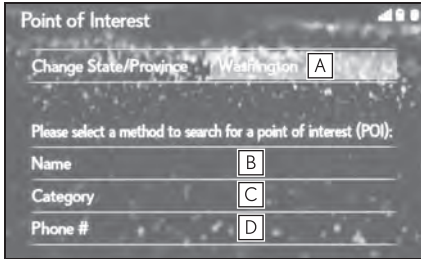

3 Select the desired search method.

A Select to change the search area.

B Select to search by name.

C Select to search by category.

D Select to search by phone number.

► Searching by name (**B**)

4 Select “Name”.

5 Enter a POI name and select “Search”.

6 Select the desired POI.

► **Searching by category (C)**

4 Select "Category".

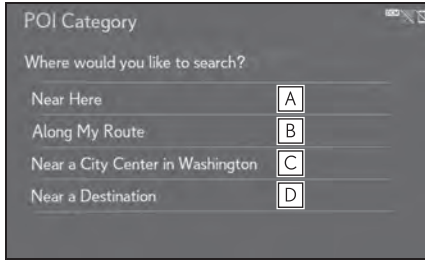

6 Select the desired POI category.

7 Select the desired POI.

► **Searching by phone number (D)**

4 Select "Phone #".

5 Enter a phone number and select "OK".

5 Select the desired search point.

A Select to search for POIs near your current position.

B Select to search for POIs along the set route.

C Select to search for POIs near a specific city center.

D Select to search for POIs near a destination. When more than 1 destination has been set, a list will be displayed on the screen. Select the desired destination.



# Hands-free System For Cellular Phone

## Registering/connecting a Bluetooth® device

To use the hands-free system, it is necessary to register a Bluetooth® phone with the system. Please refer to the cellular phone manufacturer's user guide for pairing procedures, or go to <http://www.lexus.com/MobileLink> to find approved Bluetooth® phones for this system.

- 1 Turn the Bluetooth® connection setting of your cellular phone on.
- 2 Press the "MENU" button on the Remote Touch.  
Please refer to P.29 for the Remote Touch operation.
- 3 Select "Phone".
- 4 Select "Yes" to register a phone.

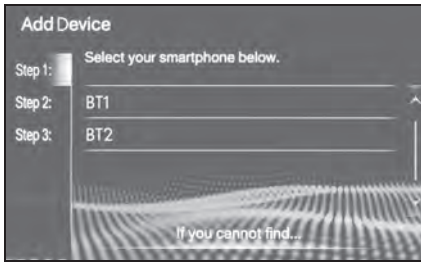

- 5 Select the desired Bluetooth® device.
- 6 Register the Bluetooth® device using your Bluetooth® device.
- 7 Check that the following screen is displayed, indicating pairing was successful.
- 8 Check that "Connected" is displayed and registration is complete.

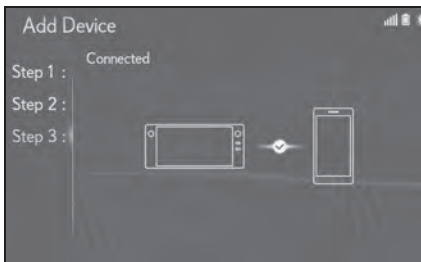

## Contacts transfer

- 1** Press the "MENU" button on the Remote Touch.  
Please refer to P.29 for the Remote Touch operation.
  - 2** Select "Setup".
  - 3** Select  "Phone" on the sub menu.
  - 4** Select "Contacts/Call History".
  - 5** Select "Transfer Contacts from Device".
  - 6** Select "From Phone (Bluetooth\*)".
  - 7** Transfer the contact data to the system using a Bluetooth® phone.
  - 8** Check that a confirmation screen is displayed when the operation is complete.
- \*: The Bluetooth® word mark and logos are registered trademarks owned by Bluetooth SIG, Inc.

Contacts transfer may not be possible depending on the type of phone.



## Registering the contacts in the favorites list

- 1 Press the “MENU” button on the Remote Touch.  
Please refer to P.29 for the Remote Touch operation.
- 2 Select “Setup”.
- 3 Select  “Phone” on the sub menu.
- 4 Select “Contacts/Call History”.
- 5 Select “Add Favorite”.
- 6 Select the desired contact to add to the favorites list.
- 7 Check that a confirmation screen is displayed when the operation is complete.

## Calling by favorites list

- 1 Press the “MENU” button on the Remote Touch.  
Please refer to P.29 for the Remote Touch operation.
- 2 Select “Phone”.
- 3 Select  “Favorites” on the sub menu and select the desired contact.
- 4 Select the desired number.
- 5 Check that the dialing screen is displayed.

## Calling the message sender

- 1 Press the “MENU” button on the Remote Touch.  
Please refer to P.29 for the Remote Touch operation.
- 2 Select “Phone”.
- 3 Select  “Message” on the sub menu.
- 4 Select a desired account name that is displayed on the left side of screen.
- 5 Select the desired message from the list.
- 6 Select , or press the  switch on the steering wheel.
- 7 Check that the dialing screen is displayed.

## Receiving a call

Select "Answer" /  or press the  switch on the steering wheel to talk on the phone.

### ► Main display

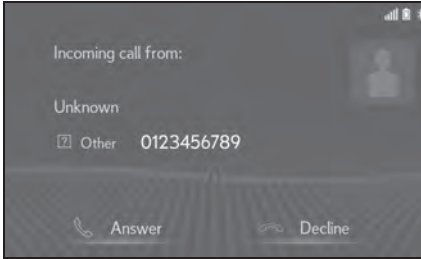

### ► Side display \*

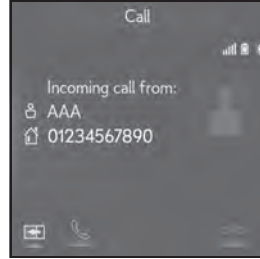

"Decline" / : Select to refuse to receive the call.

\*: 10.3-inch display model

## Steering switches

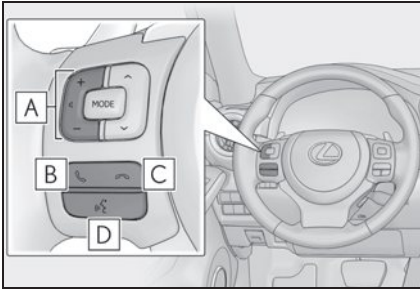

- A** Volume control switch
- Press the “+” side to increase the volume.
  - Press the “-” side to decrease the volume.
- B** Off hook switch
- Press to start talking.
  - Press to put a call on hold.
  - Depending on the system, if the switch is pressed when an Apple CarPlay connection is established, the Apple CarPlay phone application will be displayed on the system screen\*.
- C** On hook switch
- Press to end talking/dialing.
  - Press to refuse to receive the call.
- D** Talk switch
- Press the talk switch to start the voice command system.
  - To cancel voice recognition, press and hold the talk switch.

\*: This function is not available in some countries or areas.

# Audio System

## Audio control screen

Follow the procedure below to display the audio control screen.

▶ **Using the audio control switch**

Press the "RADIO" or "MEDIA" button.

▶ **Using the Remote Touch**

Press the "MENU" button on the Remote Touch, then select "Audio".

Please refer to P.29 for the Remote Touch operation.

## Selecting an audio source

▶ **Using the audio control switch**

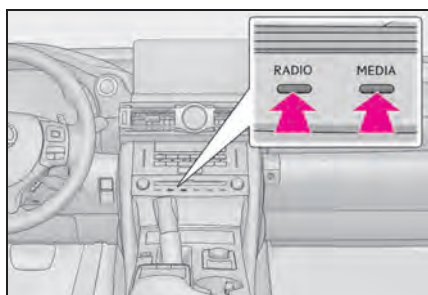

- 1 Press the "RADIO" or "MEDIA" button.

"RADIO" button: Press to change radio modes.

"MEDIA" button: Press to change media modes.

- Each time the "RADIO" or "MEDIA" button is pressed, the audio source changes.

▶ **From the audio source selection screen**

- 1 Display the audio control screen.
- 2 Select  "Source" on the sub menu.
- 3 Select the desired source.

## Steering switch operation

Some parts of the audio/visual system can be adjusted using the switches on the steering wheel.

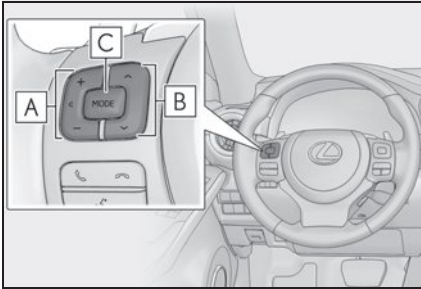

- A** Increases/decreases volume
  - B** AM, FM mode: Selects a channel  
SXM mode: Selects a channel  
Audio CD mode: Selects a track  
MP3/WMA/AAC disc mode: Selects a file  
DVD mode<sup>\*1</sup>: Selects a chapter  
USB mode<sup>\*2,3</sup>: Selects a file/track  
iPod/iPhone (Apple CarPlay) mode<sup>\*3</sup>: Selects a track  
Android Auto<sup>\*2</sup>: Selects a track  
Bluetooth<sup>®</sup> audio mode<sup>\*2,3</sup>: Selects a track
  - C** Press: Change audio modes  
Press and hold: Mute/unmute or pause/resume the current operation
- <sup>\*1</sup>: 10.3-inch display model
- <sup>\*2</sup>: When an Apple CarPlay connection is established, this function will be unavailable.
- <sup>\*3</sup>: When an Android Auto connection is established, this function will be unavailable.

# Radio

## ■ Audio control switch

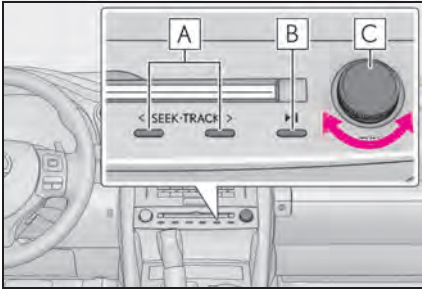

- A** Press to seek up/down.  
Press and hold for continuous seek.
- B** Press to turn mute on/off.  
Cache radio only: Press to play/pause.
- C** Turn to step up/down frequencies/  
channels.

## ■ Control screen

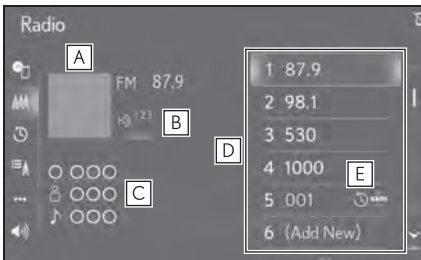

- A** Displays cover art
- B** Select to display HD) multicast channels available
- C** Displays the artist info and song title or album and genre
- D** Select to tune to preset stations/channels
- E** Display items on the channels registered to smart favorites

## ■ Presetting a station

- 1** Tune in the desired station.
- 2** Select and hold "(Add New)".



## Audio control switch

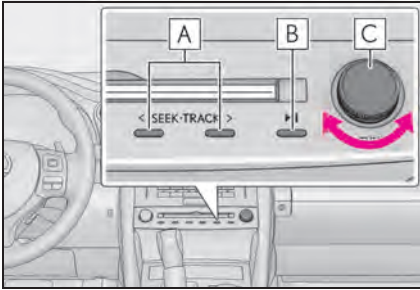

- A** Press to select a track/file.  
Press and hold to fast forward/rewind.
- B** Press to pause/play.
- C** Turn to select a track/file.

## Control screen

### ▶ Audio CD

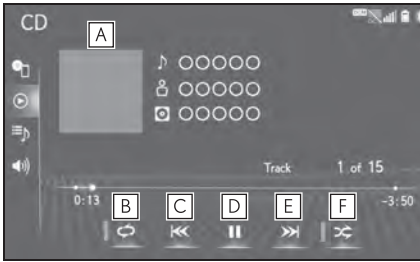

- A** Displays cover art
- B** Select to set repeat playback
- C** Select to change the track.  
Select and hold to fast rewind.
- D** Select to play/pause.
- E** Select to change the track.  
Select and hold to fast forward.
- F** Select to set random playback

### ▶ MP3/WMA/AAC disc

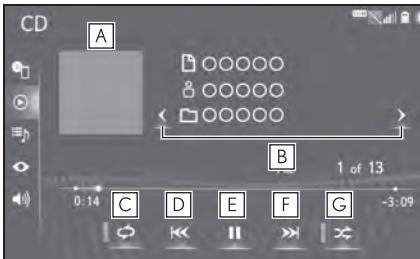

- A** Displays cover art
- B** Select to change the folder
- C** Select to set repeat playback
- D** Select to change the file.  
Select and hold to fast rewind.
- E** Select to play/pause.
- F** Select to change the file.  
Select and hold to fast forward.
- G** Select to set random playback

### ■ Audio control switch

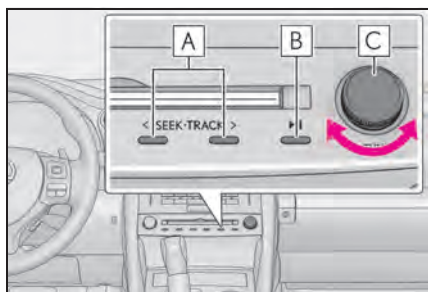

- A** Press to select a chapter.  
Press and hold to fast forward/rewind.
- B** Press to pause/play.
- C** Turn to select a chapter.

### ■ Control screen

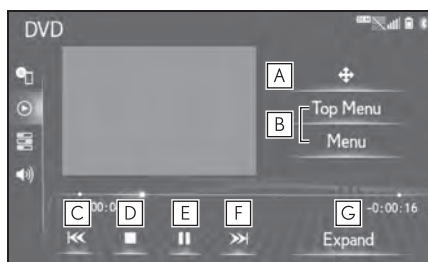

- A** Select to display the menu control key
- B** Select to display the menu screen
- C** Select to change the chapter.  
Select and hold to fast rewind.
- D** Select to stop the video screen.
- E** Select to play/pause.
- F** Select to change the chapter.
  - During playback: Select and hold to fast forward.
  - During a pause: Select and hold to slow forward.
- G** Select to display expanded screen video

## iPod/iPhone (Apple CarPlay<sup>\*</sup>)

<sup>\*</sup>: This function is not available in some countries or areas.

### ■ Audio control switch

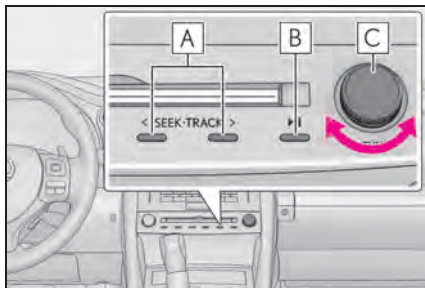

- A** Press to select a track.  
Press and hold to fast forward/rewind.
- B** Press to pause/play.
- C** Turn to select a track.<sup>\*</sup>

<sup>\*</sup>: If equipped

### ■ Control screen

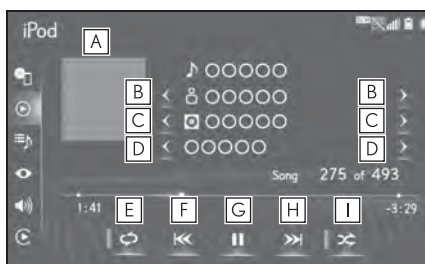

- A** Displays cover art
- B** Select to change the artist.<sup>\*</sup>
- C** Select to change the album.<sup>\*</sup>
- D** Select to change the playlist.<sup>\*</sup>
- E** Select to set repeat playback.
- F** Select to change the track.  
Select and hold to fast rewind.
- G** Select to play/pause.
- H** Select to change the track.  
Select and hold to fast forward.
- I** Select to set random playback.

<sup>\*</sup>: When an Apple CarPlay connection is established, this switch will not be displayed.

## Automatic Air Conditioning System

Air outlets and fan speed are automatically adjusted according to the temperature setting.

### Control panel

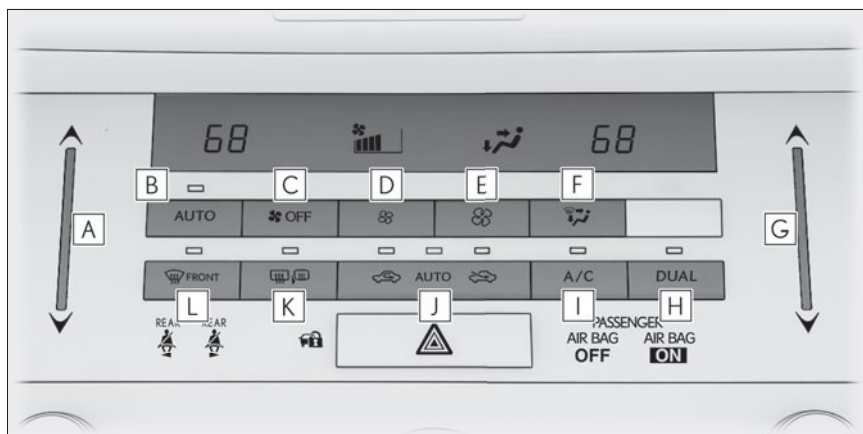

- A** Left-hand side temperature control switch
- B** Automatic mode switch
- C** Off switch
- D** Fan speed down switch
- E** Fan speed up switch
- F** Air flow mode switch
- G** Right-hand side temperature control switch
- H** DUAL mode switch
- I** A/C switch
- J** Outside/recirculated air mode switch
- K** Rear window defogger and outside rear view mirror defoggers switch
- L** Windshield defogger switch

## ■ Adjusting the temperature setting

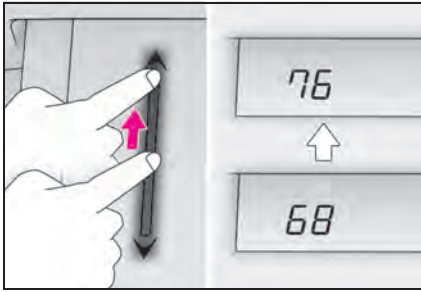

To adjust the temperature setting, touch and slide your finger up or down on the sensor.

The temperature setting can also be adjusted by touching on the sensor.

When the temperature setting is changed, a buzzer sounds.

If  ("A/C") is not pressed, the system will blow ambient temperature air or heated air.

## ■ Fan speed setting

Press  to increase the fan speed.

Press  to decrease the fan speed.

## ■ Change the airflow mode

To change the airflow, press .

The air outlets used are switched each time the button is pressed.

## Air conditioning control screen

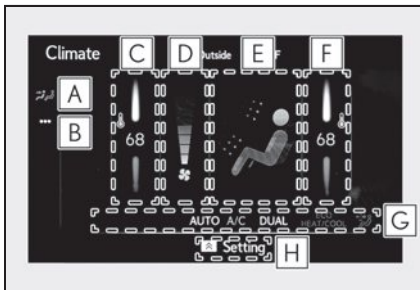

**A** Display the air conditioning control screen

**B** Display the option control screen

**C** Adjust the left-hand side temperature setting

**D** Adjust the fan speed setting

**E** Select the air flow mode

**F** Adjust the right-hand side temperature setting

**G** Function on/off indicators

**H** Display the sub function menu

## ■ Option control screen

Select **...** on the air conditioning control screen to display the option control screen. The functions can be switched on and off.

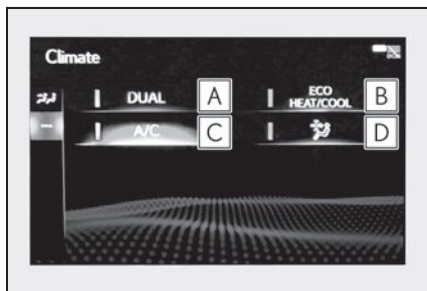

- A** Adjusting the temperature for driver and passenger seats separately ("DUAL" mode)
- B** Select to set eco mode on/off
- C** Set cooling and dehumidification function on/off
- D** Removing pollen from the air (Micro dust and pollen filter)

## ■ Sub function menu

When the sub function button on the Remote Touch is pressed, the following functions can be switched on and off.

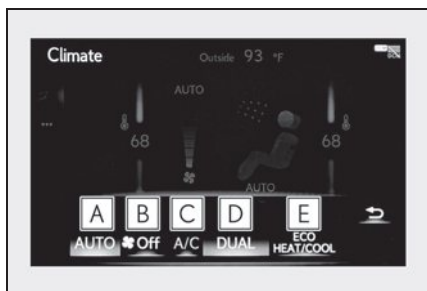

- A** Set automatic mode on/off
- B** Turn the fan off
- C** Set cooling and dehumidification function on/off
- D** Adjust the temperature for driver and passenger seats separately ("DUAL" mode)
- E** Select to set eco mode on/off

## ■ Side display (vehicles with a 10.3-inch display)

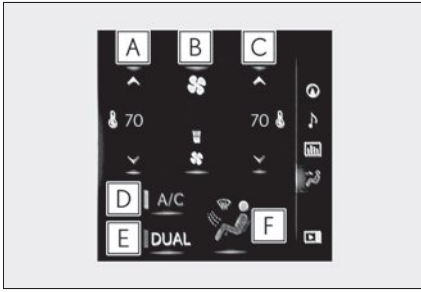

- A** Adjust the left-hand side temperature setting
- B** Adjust the fan speed setting
- C** Adjust the right-hand side temperature setting
- D** Set cooling and dehumidification function on/off

- E** Adjust the temperature for the driver's and front passenger's seats separately ("DUAL" mode)
- F** Select the air flow mode

## Using automatic mode

**1** Press **AUTO**, or select "AUTO" on the air conditioning control screen.

**2** Press **AUTO** to switch to automatic air intake mode.

The air conditioning system automatically switches between outside air and recirculated air modes.

**3** Adjust the temperature setting.

**4** To stop the operation, press **OFF** or select "Off" on the sub function menu.

## Seat Heaters (if equipped)/ Seat Ventilators (if equipped)

### Seat heaters

Each time the switch is pressed, the intensity of the seat heater changes and the level indicator lights (amber) **A** light as follows:

Hi (3 segments lit) → Mid (2 segments lit) → Lo (1 segment lit) → Off

#### ▶ Vehicles without seat ventilators

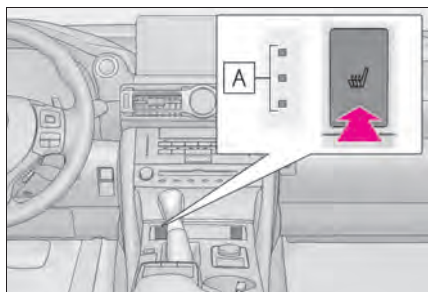

#### ▶ Vehicles with seat ventilators

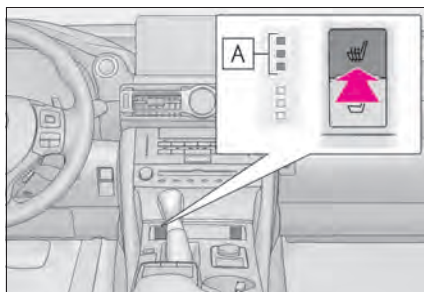

### Seat ventilators

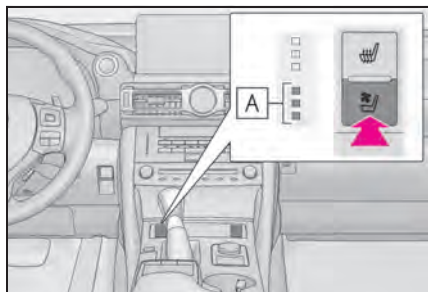

Each time the switch is pressed, the intensity of the seat ventilator changes and the level indicator lights (green) **A** light as follows:

Hi (3 segments lit) → Mid (2 segments lit)  
→ Lo (1 segment lit) → Off

#### ■ Seat heater timer control

To enable seat heater timer control, press and hold the driver and front passenger seat heater switches at the same time when the vehicle is stopped until a buzzer sounds once. If a seat heater is turned on while seat heater timer control is enabled, the intensity of the seat heater will automatically change from Hi→Mid→Lo.

The timing of the change in seat heater intensity differs depending on the temperature inside the cabin, etc. when the seat heater is operating.

To disable seat heater timer control, press and hold the driver and front passenger seat heater switches at the same time until a buzzer sounds twice.



# Voice Command System

## Basic operation

**NOTE:** Wait for the confirmation beep before speaking a command.

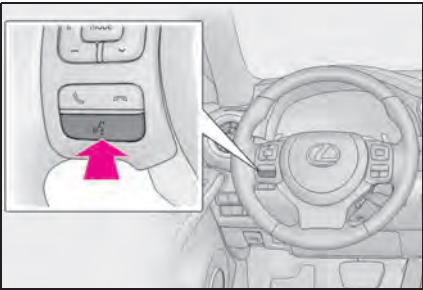

**1** Press the talk switch.

Voice guidance for the voice command system can be skipped by pressing the talk switch.

**2** If “Getting Started with Voice” screen is displayed, select “OK” or press the talk switch.

**3** After hearing a beep, say a supported command.

- To display sample commands of the desired function, say the desired function or select the desired function button. To display more commands, select “More Commands”.
- Selecting “Help” or saying “Help” prompts the voice command system to offer examples of commands and operation methods.
- When an Apple CarPlay/Android Auto connection is established, some commands will become unavailable.

Continue on to pages 57-62 for a detailed list of Voice Commands for the following categories:

- Common ..... P.57
- Top menu.....P.57
- Navi .....P.58
- Phone ..... P.59
- Radio .....P.60
- Audio.....P.61
- Info .....P.61
- Apps.....P.62
- Climate.....P.62

■ Important voice commands information and tips

- Voice commands can be used while driving.
- You must wait until after the beep to say a command.
- If you know what command to use, you can press the talk switch at any time to interrupt the voice guidance.

## Command list

### ■ Common

Command	Action
"Help"	Displays examples of some of the available commands
"Go Back"	Returns to the previous screen
"Cancel"	Cancels the voice command system
"Start over"	Returns to top menu screen
"Pause"	Temporarily pauses a voice session until it is resumed by pressing the talk switch again.

### ■ Top menu

Command	Action
"Show command examples for <menu>"	Displays the command list of the selected menu
"More Commands"	Displays more commonly used commands
"Voice Settings"	Displays Voice Setting screen
"Train my voice"	Displays Train Voice Recognition screen *

\*: Vehicle must be parked

## ■ Navigation\*1

Command	Action
"Get directions to <house #, street, city, state>"*2	Enables setting a destination by saying the address*3,4
"Find a <POI category/POI name>"	Displays a list of <POI category*5/POI name*6> near the current position
"Find a <POI> near my destination"	Displays a list of <POI> near the destination
"Find a <POI category> in a city"*2	Displays a list of <POI> in a specified city and state*4
"Go Home"	Displays the route to home
"Go to Favorite <1-10>"	Sets the location registered to the corresponding favorite number as the destination
"Show Recent Destinations"	Displays recent destinations. Selecting a number from the list will start navigation to the selected recent destination.
"Cancel Route"	Cancels the route guidance
"Delete destinations"	Displays a list of destination to delete*7
"Show <POI category> icons"	Displays the specified point of interest category*5 icons on the map
"Destination Assist"	Connects the system to the Lexus response center

\*1: 10.3-inch display model

\*2: English and French only

\*3: Best recognition results occur when saying the full address without the zipcode

\*4: When the language is set to French, the supported area is only Quebec Province in Canada

\*5: For example; "Gas stations", "Restaurants", etc.

\*6: Major national brands are always supported. Local brands are also supported with a subscription to the Lexus Enform. Contact your Lexus dealer for details.

\*7: Used when multiple destinations are set on a route

## ■ Phone

Command	Action
"Call <contact>"*	Places a call to the specified contact from the phone book
"Call <contact> <phonetype>"*	Places a call to the specified phone type of the contact from the phone book
"Dial <phone number>"	Places a call to the specified phone number
"Redial"	Places a call to the phone number of the latest outgoing call
"Call Back"	Places a call to the phone number of latest incoming call
"Show Recent Calls"	Displays the call history screen
"Send a message to <contacts>"	Sends a text message to specified contact from the phone book

\*: If the system does not recognize the name of a contact, create a voice tag.

The name of a contact can also be recognized by adding a voice tag.

## ■ While in a phone call

Command	Action
"Send <digits>"	Sends DTMF tones has specified
"Mute"	Mutes the microphone (far side cannot hear the conversation)
"Unmute"	Unmutes the microphone

## ■ While incoming message notification is displayed\*

Command	Action
"Read Message"	Reads the incoming message over the vehicle speakers
"Ignore"	Ignores the incoming message notification
"Reply"	Initiates sending a reply to the incoming message
"Call"	Places a call to the phone number of incoming message

\*: Full screen message notification must be turned on within the phone settings

## ■ Radio

Command	Action
"Tune to <frequency> AM"	Changes the radio to the specified AM frequency
"Tune to <frequency> FM"	Changes the radio to the specified FM frequency
"Play a <genre> station"	Changes the radio to an FM station of the specified genre <sup>*1</sup>
"Tune to preset <1-36>"	Changes the radio to the specified preset radio station
"Tune to a <genre> satellite station"	Changes the radio to a satellite radio channel of the specified genre <sup>*2</sup>
"Tune to <satellite channel name>"	Changes the radio to the satellite radio channel with the specified name <sup>*2</sup>
"Tune to channel <number> on XM"	Changes the radio to a satellite radio channel of the specified number <sup>*2</sup>

\*1: A station list must be built first using the radio screen

\*2: Requires a satellite radio subscription

## ■ Audio\*

Command	Action
"Play Playlist <name>"	Plays tracks from the selected playlist
"Play Artist <name>"	Plays tracks from the selected artist
"Play Song <name>"	Plays the selected track
"Play Album <name>"	Plays tracks from the selected album
"Play Genre <name>"	Plays tracks from the selected genre
"Play Composer <name>"	Plays tracks from the selected composer
"Play Podcast <name>"	Plays tracks from the selected podcast
"Play Audiobook <name>"	Plays tracks from the selected audiobook
"Audio On"	Turns the audio/visual system on
"Audio Off"	Turns the audio/visual system off
"Change the audio source to <source name>"	Sets the source to the specified audio mode

\*: The audio device must be connected via a USB cable to use the functionality in this section

## ■ Info\*1

Command	Action
"Get the Forecast"	Displays weather information
"Get the Forecast for <city>"*2	Displays weather for the specified city
"Show Traffic"	Displays traffic information
"Show Traffic near here"	Displays traffic information near your current location
"Get traffic along my route"	Displays traffic information along your current route
"Show Traffic on this street"	Displays traffic information along road you are currently driving on
"Show Traffic for saved route"	Displays traffic information for a saved route
"Show Predictive Traffic"	Displays the predictive traffic map

\*1: 10.3-inch display model

\*2: Only major US cities are supported by voice

## ■ Apps

Command	Action
"Launch <apps>"*	Activates the Lexus Enform App Suite 2.0 application

\*: When an application is opened and is in full screen mode, pressing the talk switch will start the voice command system and commands for the currently displayed application will be available

## ■ Climate

Command	Action
"Turn the AC on/Turn the AC off"	Turns air conditioning system on or off
"Change the Fan speed to <#>"	Changes the set fan speed of the air conditioning system to <#>
"Set temperature to <#> degrees"	Changes the set temperature of the air conditioning system to <#> degrees*
"Increase Temperature/ Decrease Temperature"	Increases or decreases the temperature of the air conditioning system
"Increase Fan speed/Decrease Fan speed"	Increases or decreases the fan speed of the air conditioning system

\*: Only within the possible temperature range of the air conditioning system

## USB/AUX Ports

There are 2 USB ports and an AUX port in the console box.

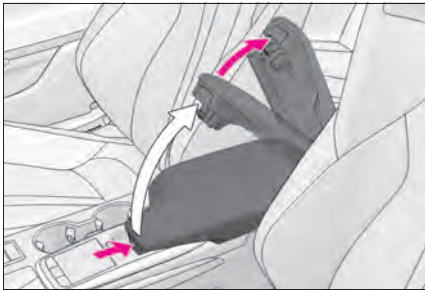

**1** Push the knob.

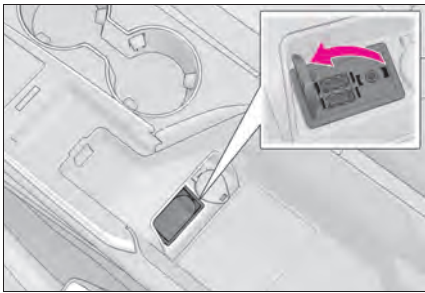

**2** Open the cover and connect a device.



# Garage Door Opener

The garage door opener can be programmed to operate garage doors, gates, entry doors, door locks, home lighting systems, security systems, and other devices.

## System components

The HomeLink<sup>®</sup> wireless control system in your vehicle has 3 buttons which can be programmed to operate 3 different devices. Refer to the programming methods on the following pages to determine the method which is appropriate for the device.

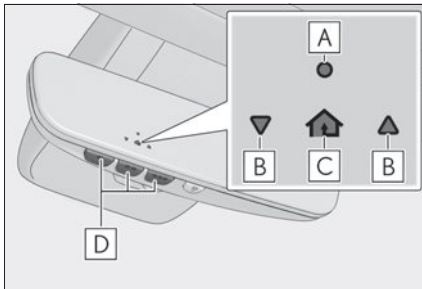

**A** HomeLink<sup>®</sup> indicator light

**B** Garage door operation indicators

**C** HomeLink<sup>®</sup> icon

Illuminates while HomeLink<sup>®</sup> is operating.

**D** Buttons

### ■ Before programming HomeLink<sup>®</sup>

- During programming, it is possible that garage doors, gates, or other devices may operate. For this reason, make sure that people and objects are clear of the garage door or other devices to prevent injury or other potential harm.
- It is recommended that a new battery be placed in the remote control transmitter for more accurate programming.
- Garage door opener motors manufactured after 1995 may be equipped with rolling code protection. If this is the case, you may need a stepladder or other sturdy, safe device to reach the "Learn" or "Smart" button on the garage door opener motor.

### ■ HomeLink<sup>®</sup> programming procedure

The programming procedures can also be found at the following URL.

Website: [www.homelink.com/lexus](http://www.homelink.com/lexus)



For support, contact customer support at the following.

Help Line: 1-800-355-3515

## ■ Programming HomeLink®

Steps **1** through **3** must be performed within 60 seconds, otherwise the indicator light will stop flashing and programming will not be able to be completed.

- 1** Press and release the HomeLink® button you want to program and check that the HomeLink® indicator light flashes (orange).

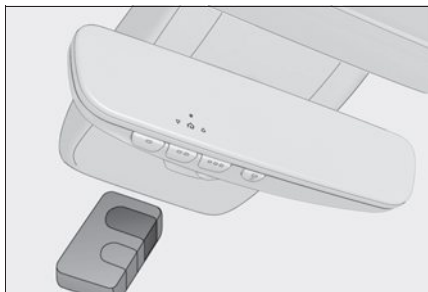

- 2** Point the remote control transmitter for the device at the rear view mirror, 1 to 3 in. (25 to 75 mm) from the HomeLink® buttons.

Keep the HomeLink® indicator light in view while programming.

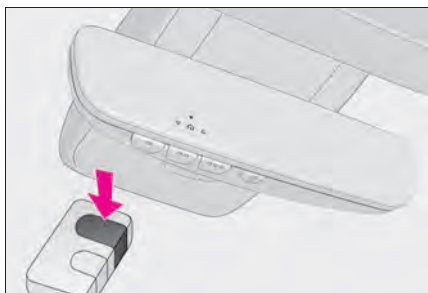

- 3** Program a device.

### ▶ Programming a device other than an entry gate (for U.S.A. owners)

Press and hold the handheld transmitter button until the HomeLink® indicator light changes from slowly flashing orange to rapidly flashing green (rolling code) or continuously lit green (fixed code), then release the button.

### ▶ Programming an entry gate (for U.S.A. owners)/Programming a device in the Canadian market

Press and release the remote control transmitter button at 2 second intervals, repeatedly, until the HomeLink® indicator light changes from slowly flashing (orange) to rapidly flashing (green) (rolling code) or continuously lit (green) (fixed code).

- 4** Test the HomeLink® operation by pressing the newly programmed button and observing the indicator light:
  - Indicator light illuminates: Programming of a fixed code device has completed. The garage door or other device should operate when a HomeLink® button is pressed and released.
  - Indicator light flashes rapidly: The garage door opener motor or other device is equipped with a rolling code. To complete programming, firmly press and hold the HomeLink® button for 2 seconds then release it.

- If the garage door or other device does not operate, proceed to “Programming a rolling code system”.

**5** Repeat the steps above to program another device for any of the remaining HomeLink<sup>®</sup> buttons.

### ■ Programming a rolling code system

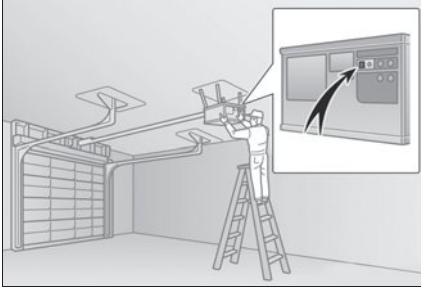

**1** Locate the “Learn” or “Smart” button on the garage door opener motor in the garage.

This button can usually be found where the hanging antenna wire is attached to the unit. The name and color of the button may vary by manufacturer. Refer to the owner’s manual supplied with the garage door opener motor for details.

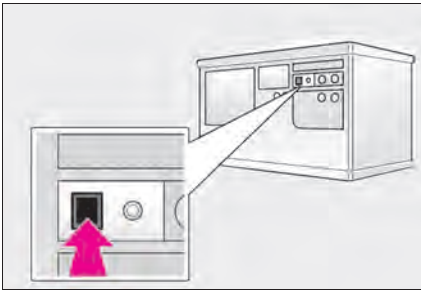

**2** Press and release the “Learn” or “Smart” button.

Perform **3** within 30 seconds after performing **2**.

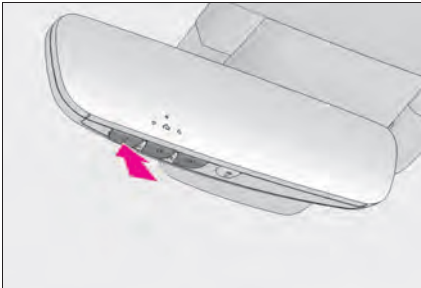

**3** Press and hold the desired HomeLink<sup>®</sup> button (inside the vehicle) for 2 seconds and release it. Repeat this sequence (press/hold/release) up to 3 times to complete programming.

If the garage door opener motor operates when the HomeLink<sup>®</sup> button is pressed, the garage door opener motor recognizes the HomeLink<sup>®</sup> signal.

## ■ Enabling 2-way communication with a garage door (only available for compatible devices)

When enabled, 2-way communication allows you to check the status of the opening and closing of a garage door through indicators in your vehicle.

2-way communication is only available if the garage door opener motor used is a compatible device. (To check device compatibility, refer to [www.homelink.com](http://www.homelink.com).)

- 1 Within 5 seconds after programming the garage door opener has been completed, if the garage door opener motor is trained to HomeLink<sup>®</sup>, both garage door operation indicators will flash rapidly (green) and the light on the garage door opener motor will blink twice, indicating that 2-way communication is enabled.

If the indicators do not flash, perform **2** and **3** within the first 10 presses of the HomeLink<sup>®</sup> button after programming has been completed.

- 2 Press a programmed HomeLink<sup>®</sup> button to operate a garage door.
- 3 Within 1 minute of pressing the HomeLink<sup>®</sup> button, after the garage door operation has stopped, press the “Learn” or “Smart” button on the garage door opener motor. Within 5 seconds of the establishment of 2-way communication with the garage door opener, both garage door operation indicators in the vehicle will flash rapidly (green) and the light on the garage door opener motor will blink twice, indicating that 2-way communication is enabled.

## ■ Reprogramming a single HomeLink<sup>®</sup> button

When the following procedure is performed, buttons which already have devices registered to them can be overwritten:

- 1 With one hand, press and hold the desired HomeLink<sup>®</sup> button.
- 2 When the HomeLink<sup>®</sup> indicator starts flashing (orange), continue to hold the HomeLink<sup>®</sup> button and perform “Programming HomeLink<sup>®</sup>” **1** (it takes 20 seconds for the HomeLink<sup>®</sup> indicator to start flashing).

## Operating HomeLink<sup>®</sup>

Press the appropriate HomeLink<sup>®</sup> button. The HomeLink<sup>®</sup> indicator light should turn on.

## Lexus Enform Safety Connect (if equipped)

Safety Connect is a subscription-based telematics service that uses Global Positioning System (GPS) data and embedded cellular technology to provide safety and security features to subscribers. Safety Connect is supported by Lexus' designated response center, which operates 24 hours per day, 7 days per week.

Safety Connect service is available by subscription on select, telematics hardware-equipped vehicles.

### System components

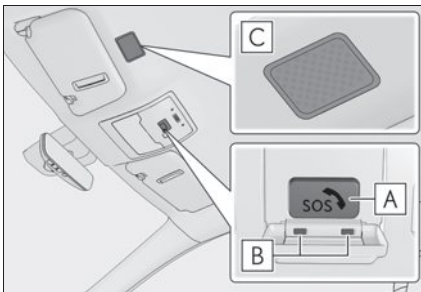

- A** "SOS" button
- B** LED light indicators
- C** Microphone

### Services

Subscribers have the following Safety Connect services available:

#### ■ Automatic Collision Notification

In case of either airbag deployment or severe rear-end collision, the system is designed to automatically call the response center. The responding agent receives the vehicle's location and attempts to speak with the vehicle occupants to assess the level of emergency. If the occupants are unable to communicate, the agent automatically treats the call as an emergency, contacts the nearest emergency services provider to describe the situation, and requests that assistance be sent to the location.

#### ■ Stolen Vehicle Location

If your vehicle is stolen, Safety Connect can work with local authorities to assist them in locating and recovering the vehicle. After filing a police report, call the Safety Connect response center at 1-800-25-LEXUS (1-800-255-3987) in the United States, 1-877-539-8777 in Puerto Rico or 1-800-265-3987 in Canada, and follow the prompts for Safety Connect to initiate this service.

In addition to assisting law enforcement with recovery of a stolen vehicle, Safety-Connect-equipped vehicle location data may, under certain circumstances, be shared with third parties to locate your vehicle. Further information is available at [Lexus.com](http://Lexus.com).

## ■ Emergency Assistance Button (“SOS”)

In the event of an emergency on the road, push the “SOS” button to reach the Safety Connect response center. The answering agent will determine your vehicle’s location, assess the emergency, and dispatch the necessary assistance required.

If you accidentally press the “SOS” button, tell the response-center agent that you are not experiencing an emergency.

## ■ Enhanced Roadside Assistance

Enhanced Roadside Assistance adds GPS data to the already included warranty-based Lexus roadside service.

Subscribers can press the “SOS” button to reach a Safety Connect response-center agent, who can help with a wide range of needs, such as: towing, flat tire, fuel delivery, etc. For a description of the Roadside Assistance services and their limitations, please see the Safety Connect Terms and Conditions, which are available at [Lexus.com](http://Lexus.com).

## Subscription

After you have signed the Telematics Subscription Service Agreement and are enrolled, you can begin receiving services.

A variety of subscription terms is available for purchase. Contact your Lexus dealer, call the following or push the “SOS” button in your vehicle for further subscription details.

- The United States  
1-800-25-LEXUS (1-800-255-3987)
- Canada  
1-800-26-LEXUS (1-800-265-3987)
- Puerto Rico  
1-877-539-8777

## Lexus Enform Remote (if equipped)

Lexus Enform Remote is a smartphone application that lets you view and remotely control certain aspects of your vehicle.

For details about the functions and services of this application, refer to <http://www.lexus.com/enform/>.

Function of the Lexus Enform Remote is achieved by using DCM (Data Communication Module).

## Subscription

After you sign the Telematics Subscription Service Agreement, download the Lexus Enform Remote app from your smartphone's app store, and register within the app (or enroll and complete registration at the dealer), you can begin using these services.

A variety of subscription terms are available. Contact your Lexus dealer, or call 1-800-25-LEXUS (1-800-255-3987) for further subscription details.

## Lexus Enform Service Connect (if equipped)

Lexus Enform Service Connect uses DCM (Data Communication Module) to collect and transmit vehicle data that allows Lexus to provide:

- Vehicle Health Report (VHR) (Safety Recalls, Service Campaigns, Current Vehicle Alerts, Required Maintenance, and Vehicle Condition Status)
- Maintenance Notifications
- Vehicle Alert Notifications

For details about this service and how to register, refer to <http://www.lexus.com/enform/>.

The Lexus Enform Service Connect is achieved by using a DCM (Data Communication Module) built in the vehicle.



## SiriusXM Satellite Radio

A SiriusXM Satellite Radio is a tuner designed exclusively to receive broadcasts provided under a separate subscription.

For details, refer to the "NAVIGATION AND MULTIMEDIA SYSTEM OWNER'S MANUAL".

### Subscription

For SiriusXM Services requiring a subscription (such as SiriusXM Satellite Radio), the following paragraph shall be included.

Required SiriusXM Radio monthly subscriptions sold separately after trial period. Subscription fee is consumer only. All fees and programming subject to change. Subscriptions are subject to the Customer Agreement available at [www.siriusxm.com](http://www.siriusxm.com) (U.S.A.) or [www.siriusxm.ca](http://www.siriusxm.ca) (Canada) XM service only available in the 48 contiguous United States and 10 Canadian provinces. © 2011 Sirius XM Radio Inc. Sirius, XM and all related marks and logos are trademarks of Sirius XM Radio Inc. All other marks, channel names and logos are the property of their respective owners.

For more information, program schedules, and to subscribe or extend subscription after complimentary trial period; more information is available at:

► **U.S.A. Customers:**

Visit [www.siriusxm.com](http://www.siriusxm.com) or call 1-877-447-0011

► **Canadian Customers:**

Visit [www.siriusxm.ca](http://www.siriusxm.ca) or call 1-877-438-9677

## What to do if...

### List of Warning/Indicator Lights

Immediately stop the vehicle in a safe place and contact your Lexus dealer. Continuing to drive the vehicle may be dangerous.

**BRAKE**

(U.S.A.)



(Canada)

(red)

Brake system warning light

Immediately stop the vehicle in a safe place and contact your Lexus dealer.



Charging system warning light



Low engine oil pressure warning light

Have the vehicle inspected by your Lexus dealer immediately.



(yellow)

Brake system warning light



Electric power steering system warning light



CHECK

(U.S.A.)

Malfunction indicator lamp



(flashes or illuminates)

PCS warning light



(Canada)



SRS warning light



Slip indicator



Automatic headlight leveling system warning light

**ABS**

(U.S.A.)

ABS warning light



Tire pressure warning light

(Blinking and then continuously on)



(Canada)



(flashes)

Brake hold operated indicator

For further information, refer to the "OWNER'S MANUAL".

## What to do if...

### Follow the correction procedures.



Inappropriate pedal operation warning light



Low fuel level warning light



(U.S.A.)

Parking brake warning light



Driver's and front passenger's seat belt reminder light



(Canada)



Rear passenger's seat belt reminder lights



LTA indicator



Master warning light



PCS warning light



Tire pressure warning light\*



Open door warning light

(Illuminates without blinking)

### Stop and check.



High coolant temperature warning light

For further information, refer to the "OWNER'S MANUAL".

## What to do if...

### See the "OWNER'S MANUAL"



Turn signal indicator



Headlight indicator (U.S.A.)



Tail light indicator (Canada)



Headlight high beam indicator



Automatic High Beam indicator



PCS warning light



Cruise control indicator



Dynamic radar cruise control indicator



Cruise control "SET" indicator



LTA indicator  
\*2



BSM (Blind Spot Monitor) outside rear view mirror indicators



Intuitive parking assist indicator (if equipped)



(Flashes)

Slip indicator



VSC OFF indicator



Parking brake indicator  
(U.S.A.)



Parking brake indicator  
(Canada)



Brake hold standby indicator



Brake hold operated indicator



TRAC OFF indicator



Smart access system with push-button start indicator



Security indicator



Low outside temperature indicator



Eco Driving Indicator Light



"AIR BAG ON/OFF" indicator  
(U.S.A.)



"AIR BAG ON/OFF" indicator  
(Canada)



"EXPERT" indicator



"LAUNCH" indicator

For further information, refer to the "OWNER'S MANUAL".

## What to do if...

### See the "OWNER'S MANUAL"

#### ● Drive mode indicators



"NORMAL" indicator



"SPORT S+" indicator



Eco drive mode indicator



"CUSTOM" indicator



"SPORT S" indicator

For further information, refer to the "OWNER'S MANUAL".

- \*1: It also comes on due to natural causes such as natural air leaks and tire inflation pressure changes caused by temperature. Adjust the tire inflation pressure to the specified level. The light will turn off after a few minutes. In case the light does not turn off even if the tire inflation pressure is adjusted, have the system checked by your Lexus dealer.
- \*2: Depending on the operating condition, the color and illuminating/flashing state of the light change.

## What to do if...

### If the engine doesn't start

Make sure that the correct operating procedures have been followed.

#### Brake pedal

Make sure that the brake pedal is firmly depressed when attempting to start the engine.

If the engine still does not start, see the "OWNER'S MANUAL" for more information or contact your Lexus dealer.

## What to do if...

### If the electronic key does not operate properly

#### Locking and unlocking the doors and opening the trunk

##### ■ Unlocking the door

Use the mechanical key in order to perform the following operations:



- 1 Insert the mechanical key while pulling on the driver's door handle.

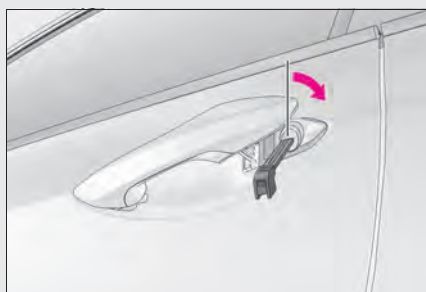

- 2 Unlocking the door.

- 3 Remove the key, return the handle, and then pull the handle again.

##### ■ Locking the door

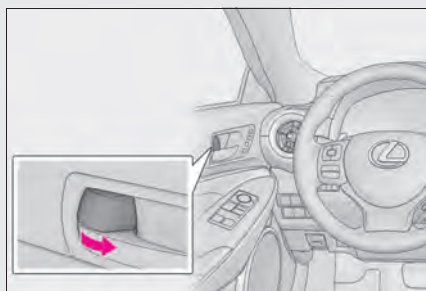

- 1 Move the inside lock button to the lock position.

- 2 Close the door.

## What to do if...

### ■ Opening the trunk

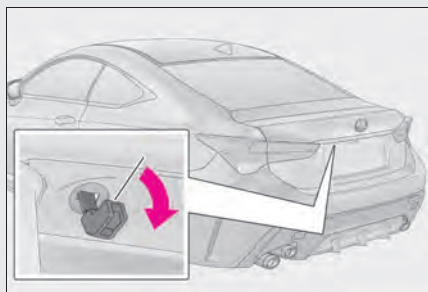

Turn the mechanical key clockwise to open.

### Starting the engine

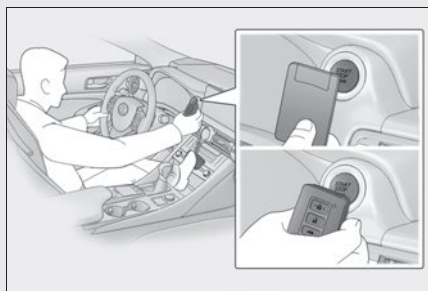

- 1 Ensure that the shift lever is in P and depress the brake pedal.
- 2 Touch the Lexus emblem side of the electronic key to the engine switch.

When the electronic key is detected, a buzzer sounds and the engine switch will turn to IGNITION ON mode.

When the smart access system with push-button start is deactivated in customization setting, the engine switch will turn to ACCESSORY mode.

- 3 Firmly depress the brake pedal and check that  is shown on the multi-information display.
- 4 Press the engine switch.

In the event that the engine still cannot be started, contact your Lexus dealer.

If the electronic key battery becomes depleted, a warning message will be shown on the multi-information display. Replace the battery with a new one. For instructions on replacing the battery, refer to the "OWNER'S MANUAL".

If you need further assistance, contact your Lexus dealer.





**Memo**

A large white rectangular area with horizontal lines, serving as a memo template. The lines are evenly spaced and extend across the width of the page, providing a guide for writing.



### **Your Lexus dealer**

Your Lexus dealer will provide quality maintenance and any other assistance you may require.

If there is not a Lexus dealer near you, please call the following number:

#### **■ U.S. OWNERS**

- In the U.S. mainland or Canada:

Lexus Roadside Assistance

**1-800-25-LEXUS or 1-800-255-3987 (Toll-Free)**

- In Hawaii:

Servco Automotive Roadside Assistance/Customer Services

**1-800-25-LEXUS or 1-800-255-3987 (Toll-Free)**

#### **■ CANADIAN OWNERS**

- In Canada or the U.S. mainland:

Lexus Roadside Assistance/Customer Service

**1-800-26-LEXUS or 1-800-265-3987 (Toll-Free)**

Please access our **websites** for further information.

- The U.S. mainland: **[www.lexus.com](http://www.lexus.com)**

- Hawaii: **[www.servcolexus.com](http://www.servcolexus.com)**

- Canada: **[www.lexus.ca](http://www.lexus.ca)**

©2023 TOYOTA MOTOR CORPORATION

All rights reserved. This material may not be reproduced or copied, in whole or in part, without the written permission of Toyota Motor Corporation.



Owner's Manual Quick Guide:

Publication No. OM24B84U

Part No. 01999-24B84

Printed in Japan 01-2310-00 

RC F Owner's Manual Quick Guide (北米U)